

# U.S. PUBLIC LAND SURVEY MONUMENT RECORD

Index No. Z-9

State of Wisconsin }  
County of Forest } ss.

I, Gary L. Pisoni, do hereby  
certify that on the 3rd day  
of March, 1994, I found  
evidence of the Southwest Section  
corner of Section 33  
Township 38, North, Range  
14 East, Fourth Principal Meridian,  
as described hereon; and that from this evidence  
I established a new monument and accessories  
as described hereon to perpetuate the original  
location of this corner.

Resident witnesses:

History of original corner establishment:

Original Government Survey in 1857 by Alfred Millard. West bet. Sections 33 and 4, at 80.00  
chs., set Section Corner Post, from which the following bear; Hemlock, 20", N30 W, 18 lks.,  
Hemlock, 18", S43°W, 9 lks., Hemlock, 12", S10°E, 47 lks., Cedar, 10", N63°E, 14 lks.

On 9-28-81 Daniel Pleoger, a Registered Land Surveyor, found 2 old posts, one standing and  
one down. Also found several old Hemlocks blazed and facing the posts, and 2 location tags.  
Original calls North fit good. In place of post, set a 2½" dia. aluminum A-1 Federal Monument  
with an alloy cap stamped; T38N R14E, S32, S33, S4, S5, T37N R14E, S1537, 1981. Blazed and  
scribed the following new bearing trees;

Hemlock	16"	S02°W	22.43 feet
Cedar	7"	S59°W	38.98 feet
Cedar	7"	N41°W	39.22 feet
Maple	4"	N40°E	12.42 feet

Description of corner evidence found:

Found monument as described above and the following bearing trees;

Hemlock	18"	S02°W	23.18 feet
Cedar	9"	S57°W	39.59 feet
Cedar	10"	N41°W	39.35 feet
Maple	6"	N40°E	12.36 feet

Description of monument and accessories I established to perpetuate the original location of this corner.

Set a steel sign post, S47°E, 1.30 feet

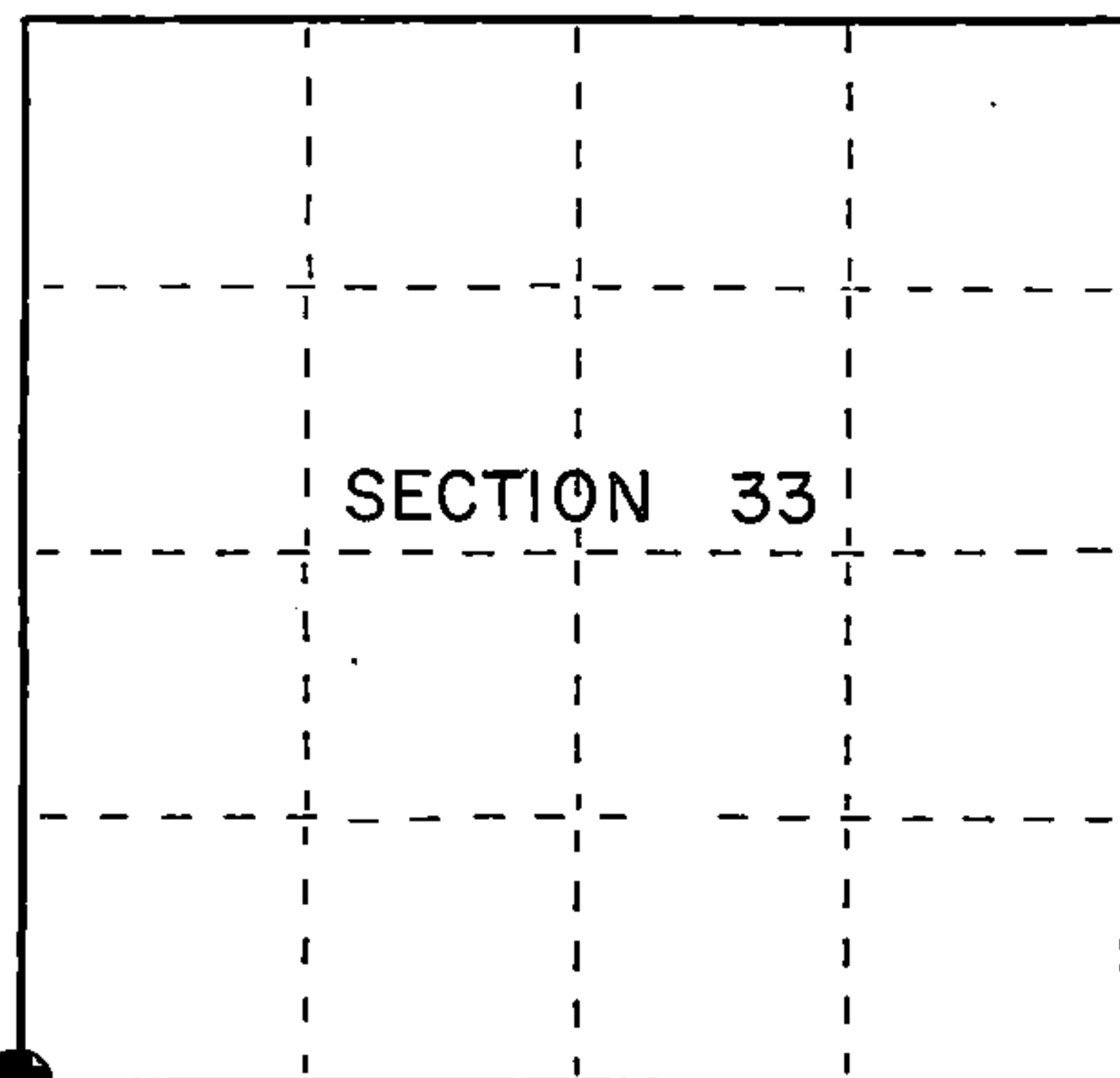

● = Corner monument restored.

Dated at Iron River, MI., this 5th day of May, 1994

Signature Gary L. Pisoni Title Land Surveyor Registration No S-1634  
(County Surveyor, Registered Land Surveyor, or other duly authorized official)

Office of Register of Deeds, County of Forest, I hereby certify that the within  
instrument was filed in this office for record on the 20th day of March, 1997  
at 1:30 o'clock P M.

(Register of Deeds)

By [Signature] Deputy

FORM NO. 985-A

H.C. Miller Company  
MILWAUKEE, WISCONSIN

Stock No. 26273

158155

43814320000

- (e) Describe any material discrepancy between the location of the corner as restored or reestablished and the location of that corner as previously restored or reestablished by distance and direction. Show the discrepancy on the plan view drawing under (d), above. Show the distances between the corner as previously restored or reestablished and (1) the corner as restored or reestablished, and (2) to at least 2 of the witness monuments shown on the drawing in (d), above.

None

- (f) Was the corner restored through acceptance of (1) an obliterated evidence location, or, (2) a found perpetuated location?

Restored through acceptance of a found perpetuated location.

- (g&h) Was the corner reestablished through lost corner proportionate methods? If so, show the method, including the directions and distances to other public land survey corners used as evidence or used for proportioning in determining the corner location?

No

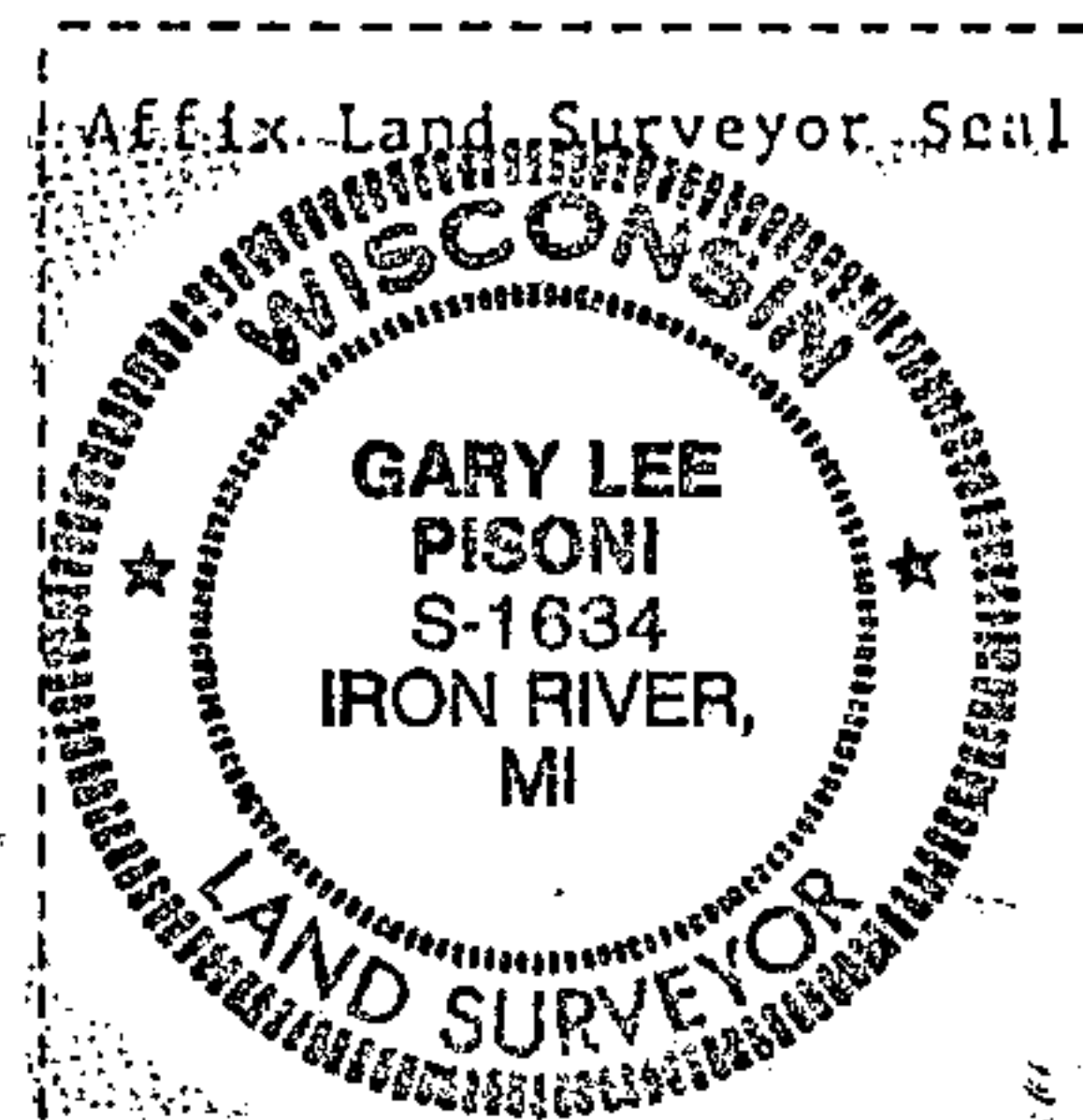
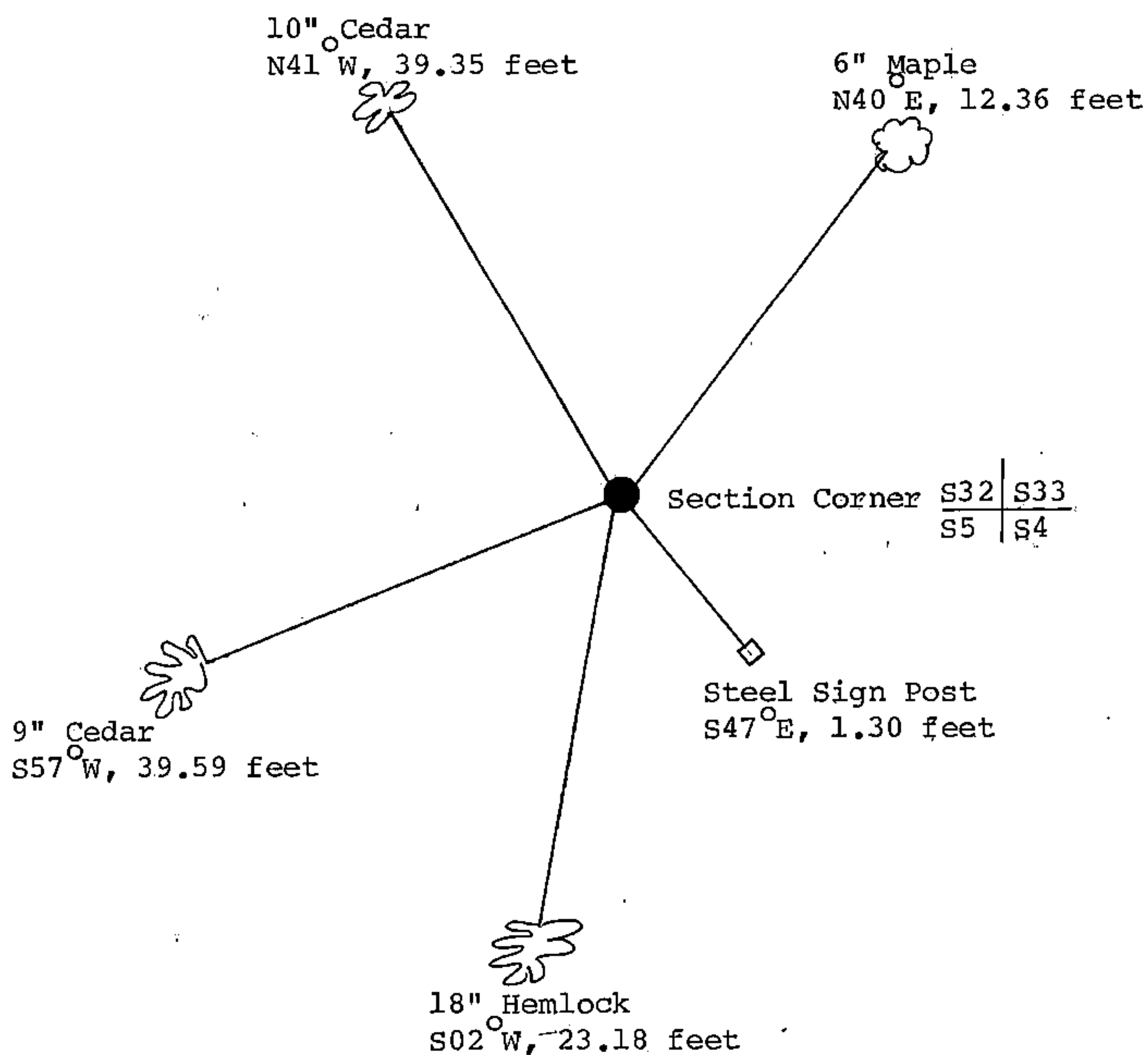

- (i) Gary L. Pisoni  
(Type or print name) certify that the corner location shown on this record was determined by me or under my direction and control and that this U.S. Public Land Survey Monument Record is correct and complete to the best of my knowledge and belief.

Nancy L. Person  
Signature

8-09-94  
Date

CERTIFIED LAND CORNER RESTORATION

Index No. A-99

State of Wisconsin }  
County of Forest } ss.

I Daniel K. Pleoger, do hereby  
certify that on the 28 day  
of September, 19 81, I found  
evidence of the Section  
corner of Sections 4, 5, 32, 33  
Township 37 & 38, North, Range  
14 East, Fourth Principal Meridian,  
as described hereon; and that from this evidence  
I established a new monument and accessories  
as described hereon to perpetuate the original  
location of this corner.

Resident witnesses:

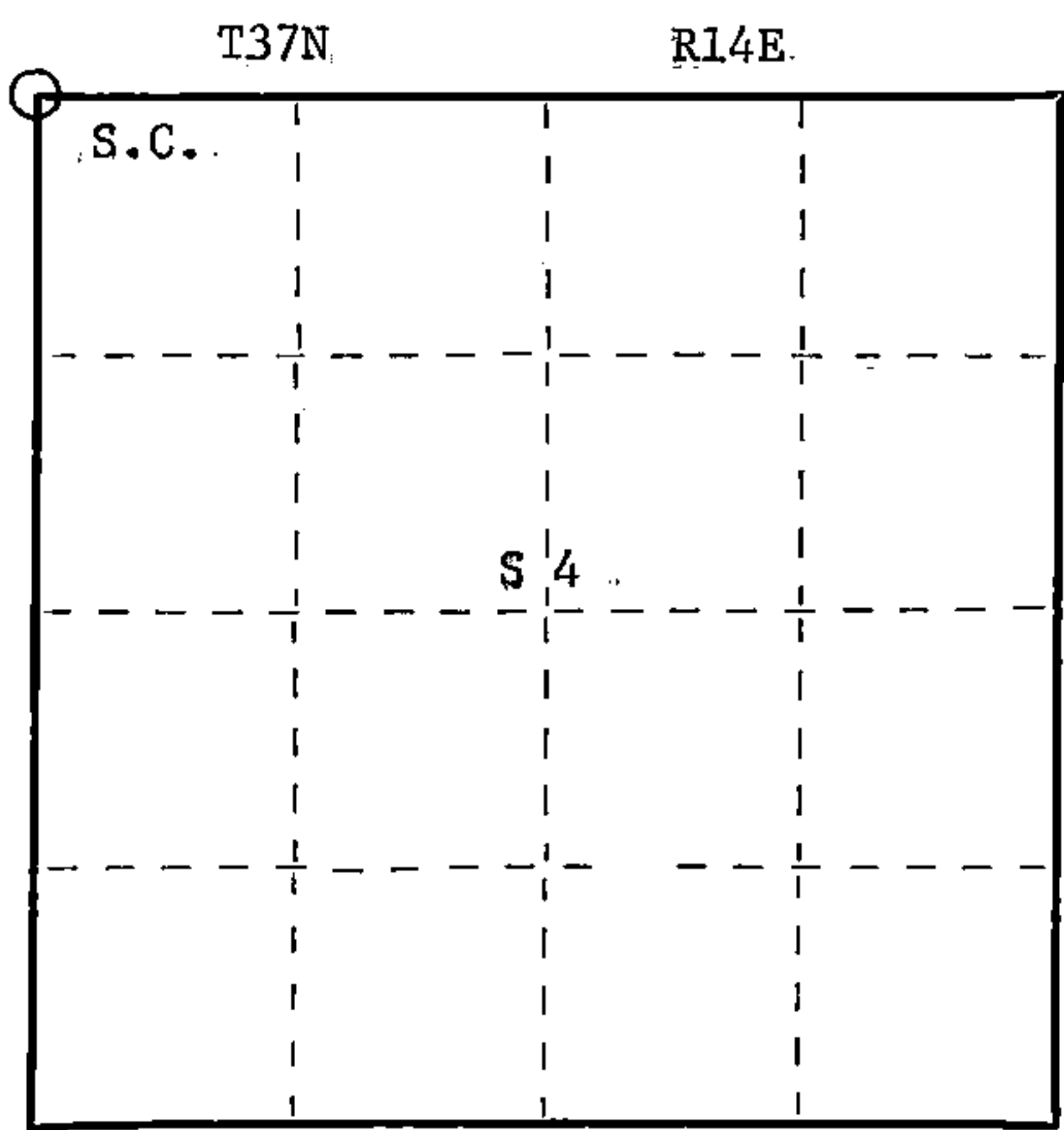
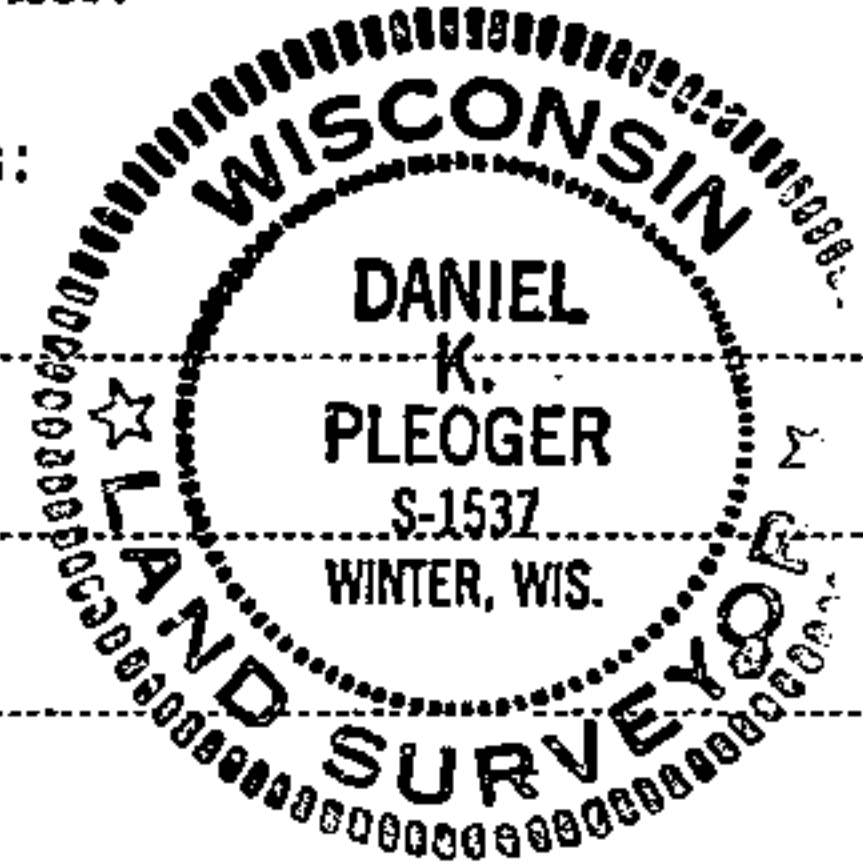

○ = Corner monument restored.

History of original corner establishment:

Original corner established by A. Curtis, Gov. Deputy Surveyor in 1857 from which  
cedar 10" bears N63E 14 lks.  
Hemlock 20" bears N30W 18 lks  
Hemlock 18" bears S43W 9 lks  
Hemlock 12" bears S10E 47 lks

Description of corner evidence found:  
Recovered two old cedar posts, squared not scribed, one post standing, other one down.  
OBT - No visible evidence of any.  
Several old hemlocks blazed facing corner position, also two old location tags tacked  
to nearby trees.  
Original calls north between sections 32 & 33 fit good

Description of monument and accessories I established to perpetuate the original location of this corner.  
Replaced old post with a 2 1/2 aluminum A-1 federal monument with alloy cap stamped:  
Monument projects 12" above ground

Marked NBTs:  
Hemlock 16" S2°W 22.43 ft.  
Cedar 7" S59W 38.98 ft.  
Cedar 7" N41W 39.22 ft.  
Maple 4" N40E 12.42 ft.  
Scribed S.C. - B.T.

T38N R14E  
32 | 33  
5 | 4  
T37N R14E  
S1537 - 1981

Dated at Rhineland, Wis., this 3 day of November, 1981

Signature Daniel K. Pleoger Title Registered Land Surveyor Registration No. 1537  
(County Surveyor, Registered Land Surveyor, or other duly authorized official)

Office of Register of Deeds, County of Forest, I hereby certify that the within  
instrument was filed in this office for record on the 9th day of April, 1982  
at 11:00 o'clock A. M.

\_\_\_\_\_  
(Register of Deeds) DOCUMENT NO. 121389

By \_\_\_\_\_ Deputy

FORM 985 H. C. MILLER CO., MILWAUKEE

43814320000