

# U.S. PUBLIC LAND SURVEY MONUMENT RECORD

Index No. Z-11

State of Wisconsin }  
County of Forest } ss.

I, Gary L. Pisoni, do hereby  
certify that on the 3rd day  
of March, 1994, I found  
evidence of the South Quarter  
corner of Section 33  
Township 38, North, Range  
14 East, Fourth Principal Meridian,  
as described hereon; and that from this evidence  
I established a new monument and accessories  
as described hereon to perpetuate the original  
location of this corner.

Resident witnesses:

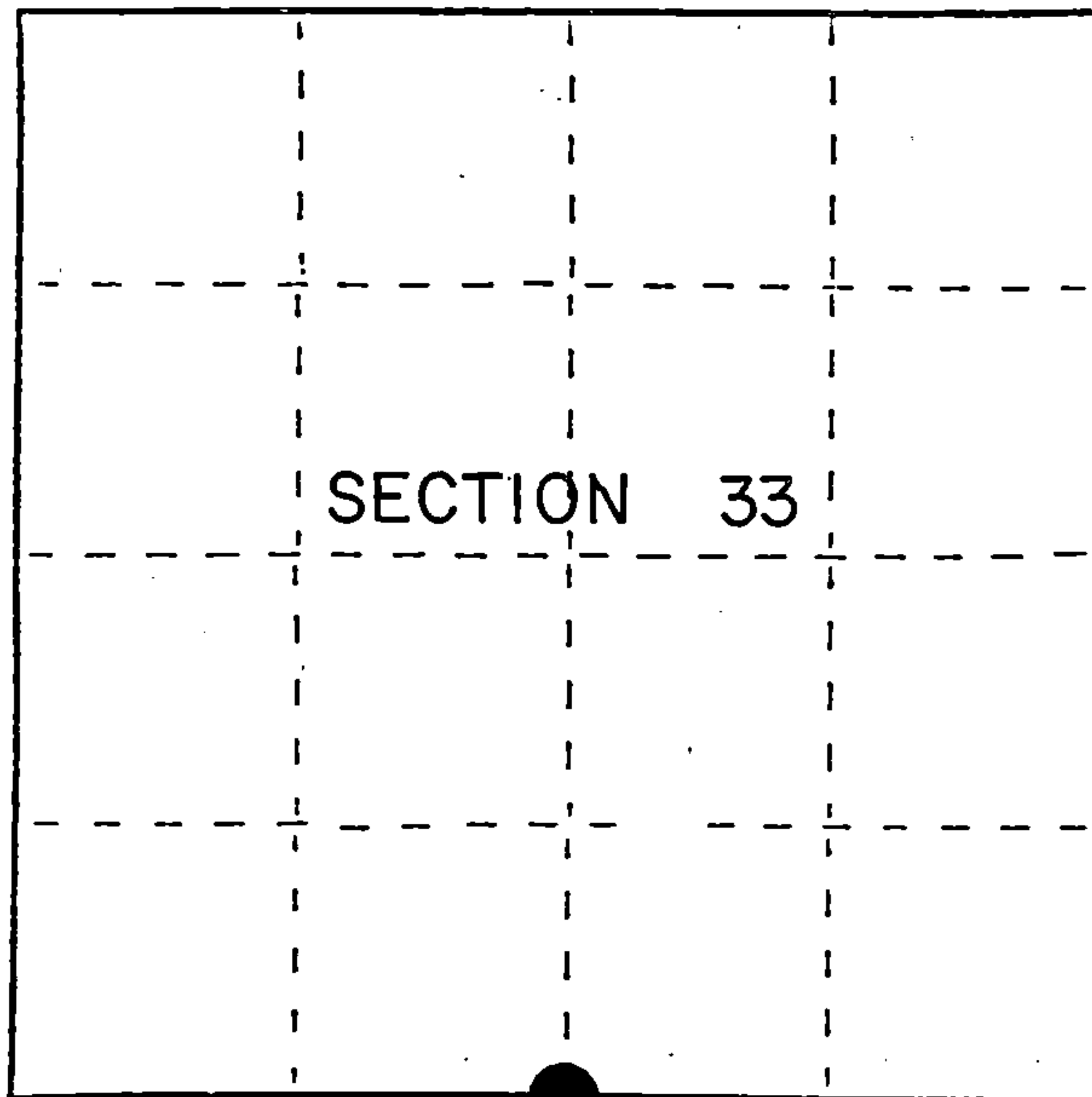

● = Corner monument restored.

## History of original corner establishment:

Original Government Survey in 1858 by Alfred Millard. At 40.00 chains set Quarter Post, from which the following bear; Spruce, 12", N28°W, 25 lks., Yellow Birch, 10", S70°E, 10 lks.

In 1989, Glen Barker, RLS, with Consolidated Papers, restored the corner position at proportionate and on line between the Southeast and Southwest Section Corners of Section 33. Set a 1" diameter aluminum pipe with an alloy cap stamped to identify corner. Blazed and scribed the following new bearing trees:

## Description of corner evidence found:

W. Birch	10"	N43°E	90.16 feet
Cedar	12"	N82°E	6.22 feet
Cedar	9"	S05°W	36.57 feet
Hemlock	11"	S64°W	18.67 feet

Found monument and bearing trees as described above;

W. Birch	11"	N43°E	90.10 feet
Cedar	14"	N82°E	6.23 feet
Cedar	10"	S05°W	36.59 feet
Hemlock	15"	S64°W	18.71 feet

Description of monument and accessories I established to perpetuate the original location of this corner.

Set a Steel Sign Post N64°W 1.00 feet

Dated at Iron River, MI ~~Wis~~ this 5th day of March, 1995

Signature Gary L. Pisoni Title Land Surveyor Registration No S-1634  
(County Surveyor, Registered Land Surveyor, or other duly authorized official)

Office of Register of Deeds, County of Forest I hereby certify that the within  
instrument was filed in this office for record on the 20th day of March, 1997  
at 1:30 o'clock P M.

(Register of Deeds)

By [Signature] Deputy

- (e) Describe any material discrepancy between the location of the corner as restored or reestablished and the location of that corner as previously restored or reestablished by distance and direction. Show the discrepancy on the plan view drawing under (d), above. Show the distances between the corner as previously restored or reestablished and (1) the corner as restored or reestablished, and (2) to at least 2 of the witness monuments shown on the drawing in (d), above.

None

- (f) Was the corner restored through acceptance of (1) an obliterated evidence location, or, (2) a found perpetuated location?

Restored through acceptance of a found perpetuated location.

- (g&h) Was the corner reestablished through lost corner proportionate methods? If so, show the method, including the directions and distances to other public land survey corners used as evidence or used for proportioning in determining the corner location?

No

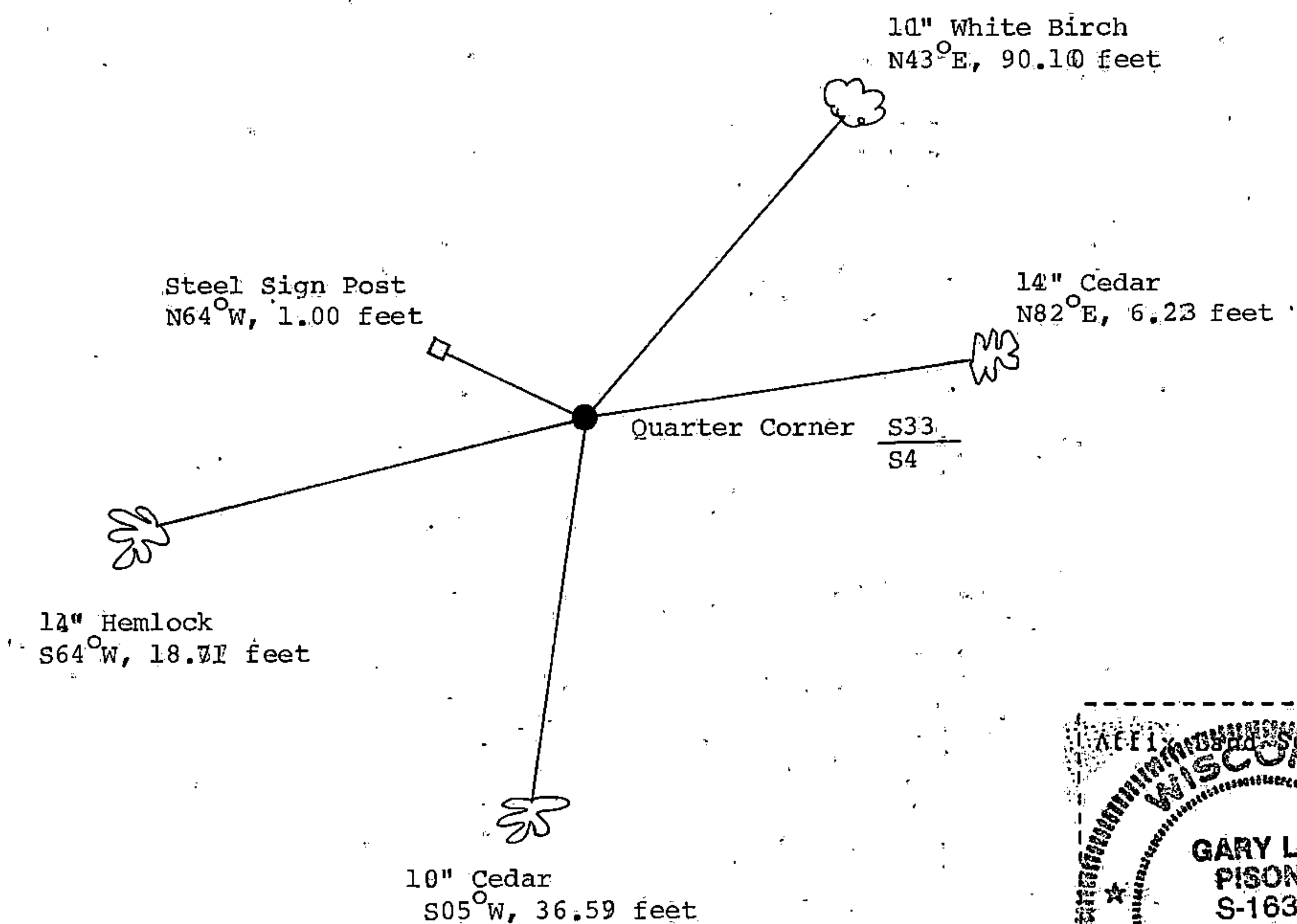

- (i) I, Gary L. Pisoni  
(type or print name) certify that the corner location shown on this record was determined by me or under my direction and control and that this U.S. Public Land Survey Monument Record is correct and complete to the best of my knowledge and belief.

Signature

Date

