

# U.S. PUBLIC LAND SURVEY MONUMENT RECORD

Index No. P-5

State of Wisconsin }  
County of Columbia } ss.

I, JAMES R. GROTHMAN, do hereby certify that on the 7th day of October, 1986, I found evidence of the One Quarter corner of Sections 19 and 20 Township 39 North, Range 12 East, Fourth Principal Meridian, as described hereon; and that from this evidence I established a new monument and accessories as described hereon to perpetuate the original location of this corner.

Resident witnesses:

None

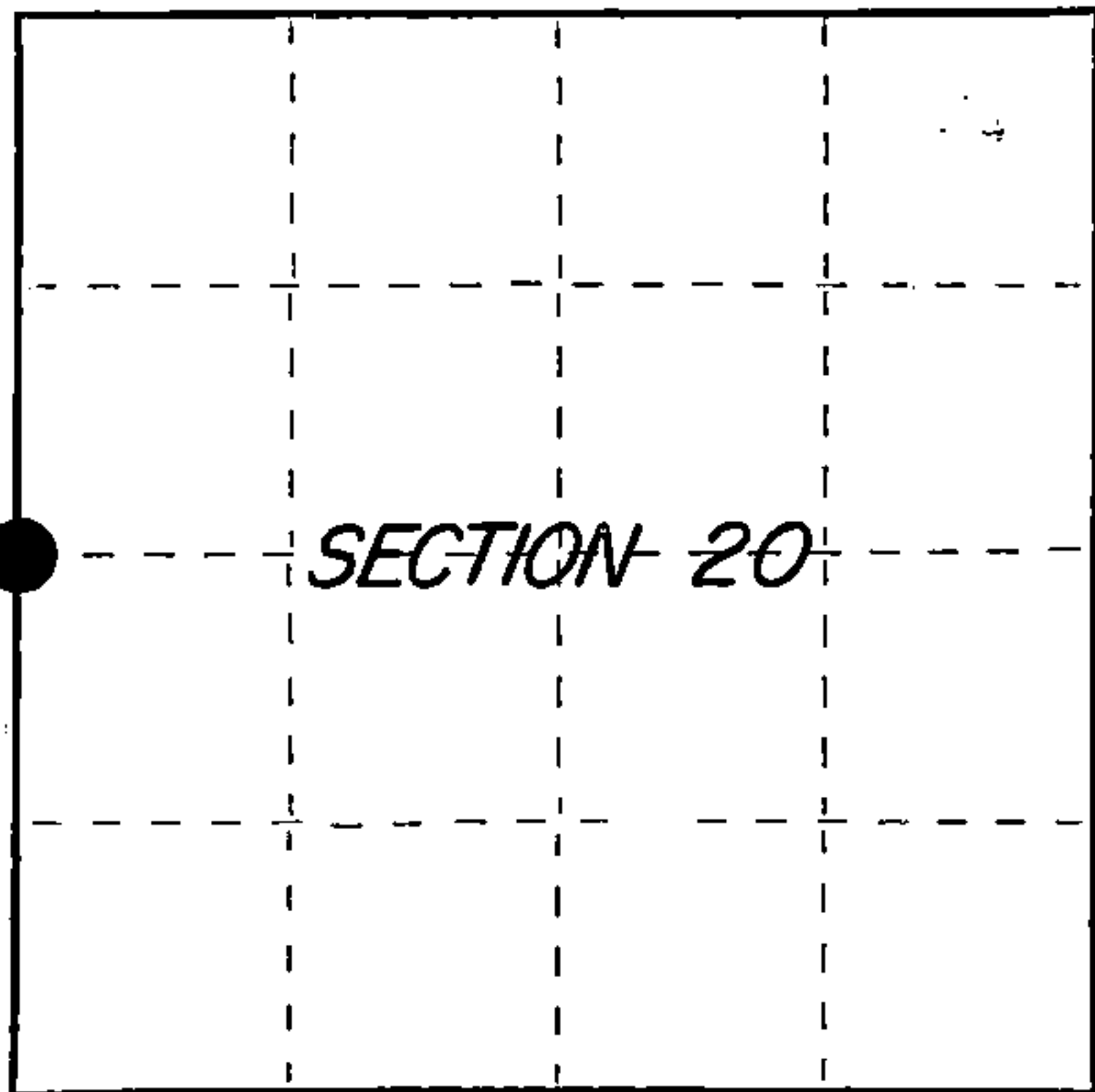

○ = Corner monument restored.

History of original corner establishment: Original survey in 1859 by William E. Daugherty. Dependent resurvey in 1941 by Hal D. Craig and Oscar B. Walsh. At 41.40 chains set an iron post, 3 feet long, 2 inches diameter, 27 inches in the ground with brass cap marked:

1/4	From which the following bear:			
S19 S20	White Pine	9"	S53°E	8 lks.
1941	Maple	8"	S89°W	33 lks.

Description of corner evidence found:

G.L.O. Monument as described and in place and the remains of both bearing trees.

Description of monument and accessories I established to perpetuate the original location of this corner.

Corner in good condition. Blazed, scribed, painted, posted and set nail in the following new bearing trees:

Maple	14"	North	7.60 feet
Hemlock	13"	N54°W	27.02 feet
Maple	15"	S49°E	40.25 feet
Maple	6"	S12°W	38.12 feet
Steel Sign Post		West	1.00 foot

Dated at PORTAGE, Wis., this 30 day of OCTOBER, 1986.

Signature: James R. Grothman (County Surveyor, Registered Land Surveyor, or other duly authorized official) Registration No. 1321

Office of Register of Deeds, County of Forest, I hereby certify that the within instrument was filed in this office for record on the 24th day of February, 1987 at 2:00 o'clock P. M.

Paul Aschenbrenner  
(Register of Deeds)

By Deputy

FORM NO. 985-A

HCMiller Company

Stock No. 26273

DOCUMENT NUMBER

132160

FOREST COUNTY

REGISTER'S OFFICE }  
Forest County, Wis. }  
Received for record this 24 day  
of February A.D., 1987 at  
2:00 o'clock P.M. and recorded  
In Vol. CORNER RESTORATIONS  
page 5  
Paul Aschenbrenner  
Register of Deeds

43912192000

(e) Describe any material discrepancy between the location of the corner as restored or reestablished and the location of that corner as previously restored or reestablished by distance and direction. Show the discrepancy on the plan view drawing under (d), above. Show the distances between the corner as previously restored or reestablished and (1) the corner as restored or reestablished, and (2) to at least 2 of the witness monuments shown on the drawing in (d), above.

See drawing below

(f) Was the corner restored through acceptance of (1) an obliterated evidence location, or, (2) a found perpetuated location?

The corner was restored through acceptance of a found perpetuated location.

(g&h) Was the corner reestablished through lost corner proportionate methods? If so, show the method, including the directions and distances to other public land survey corners used as evidence or used for proportioning in determining the corner location?

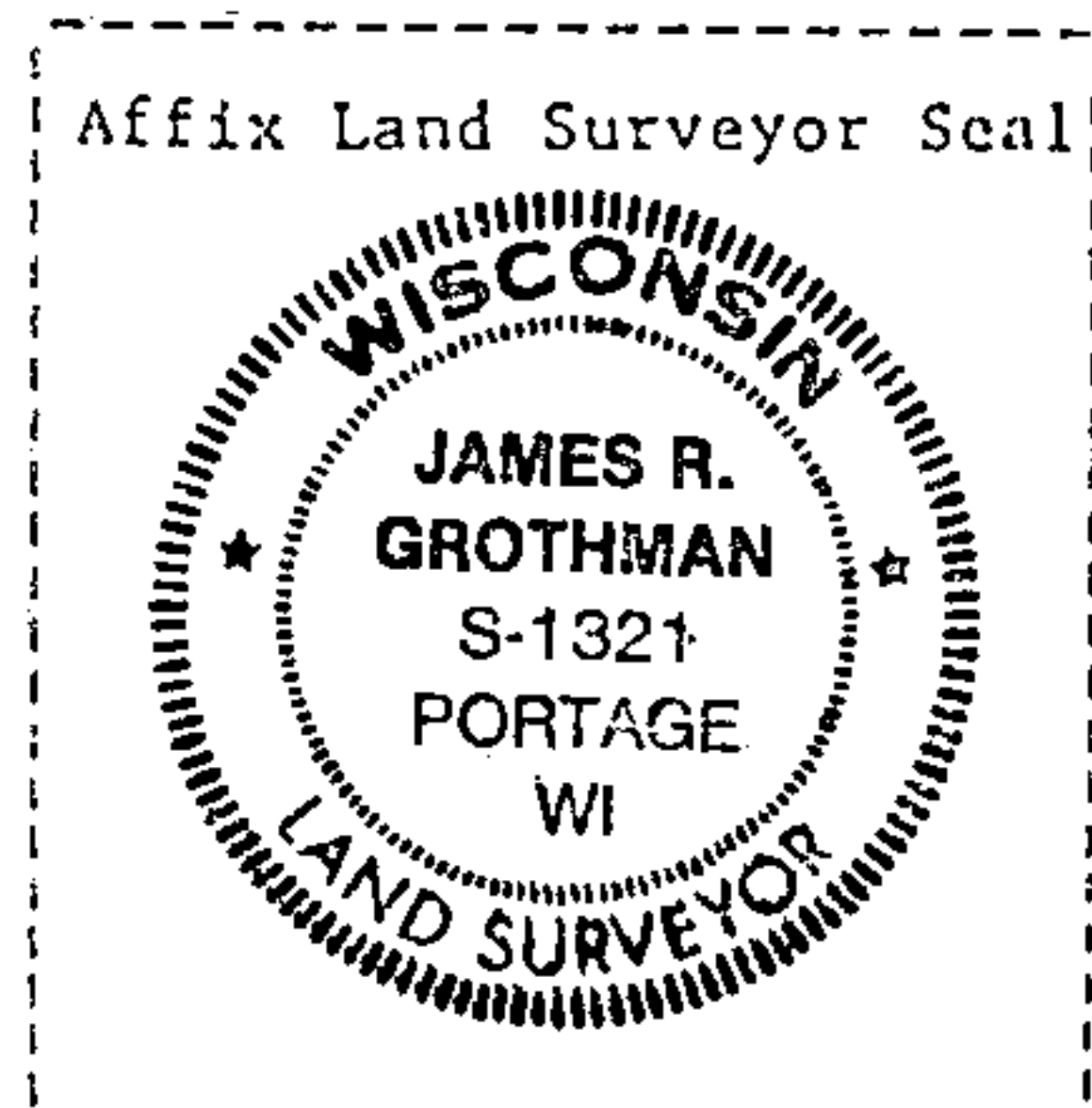
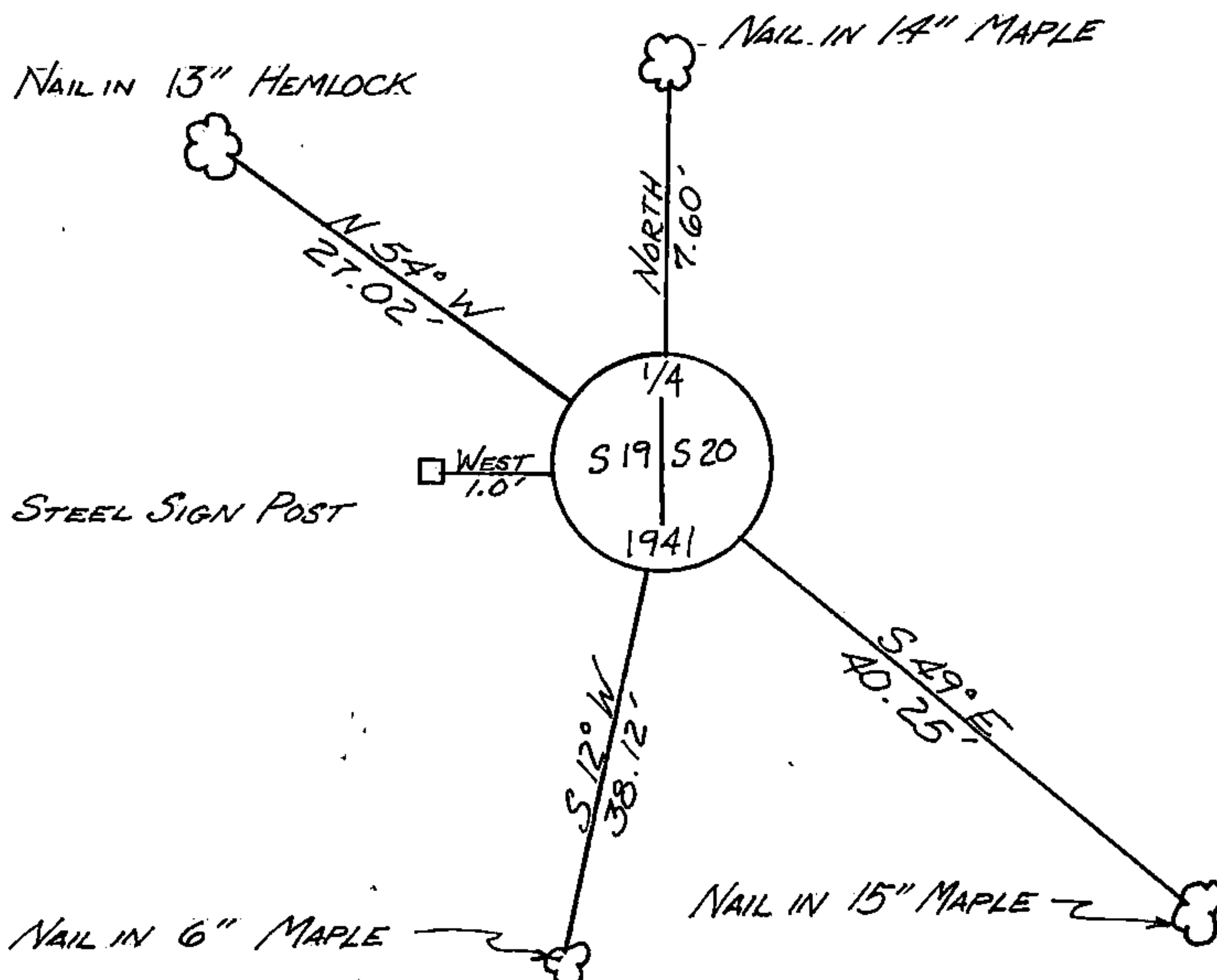

(i) I, JAMES R. GROTHMAN, Registered Land Surveyor No. 1321  
(type or print name) certify that the corner location shown  
on this record was determined by me or under my direction and  
control and that this U.S. Public Land Survey Monument Record is  
correct and complete to the best of my knowledge and belief.

Signature

Date

Certificate ready for filing:

District Ranger

Date