

Stock No. 26273

156573

State of Wisconsin }
County of Forest } ss.

I, William B. Cochrane, do hereby
certify that on the 2 th day
of August, 1994, I found
evidence of the East quarter
corner of Section 21
Township 39, North, Range
13 East, Fourth Principal Meridian,
as described hereon; and that from this evidence
I established a new monument and accessories
as described hereon to perpetuate the original
location of this corner.

Resident witnesses:

.....

.....

.....

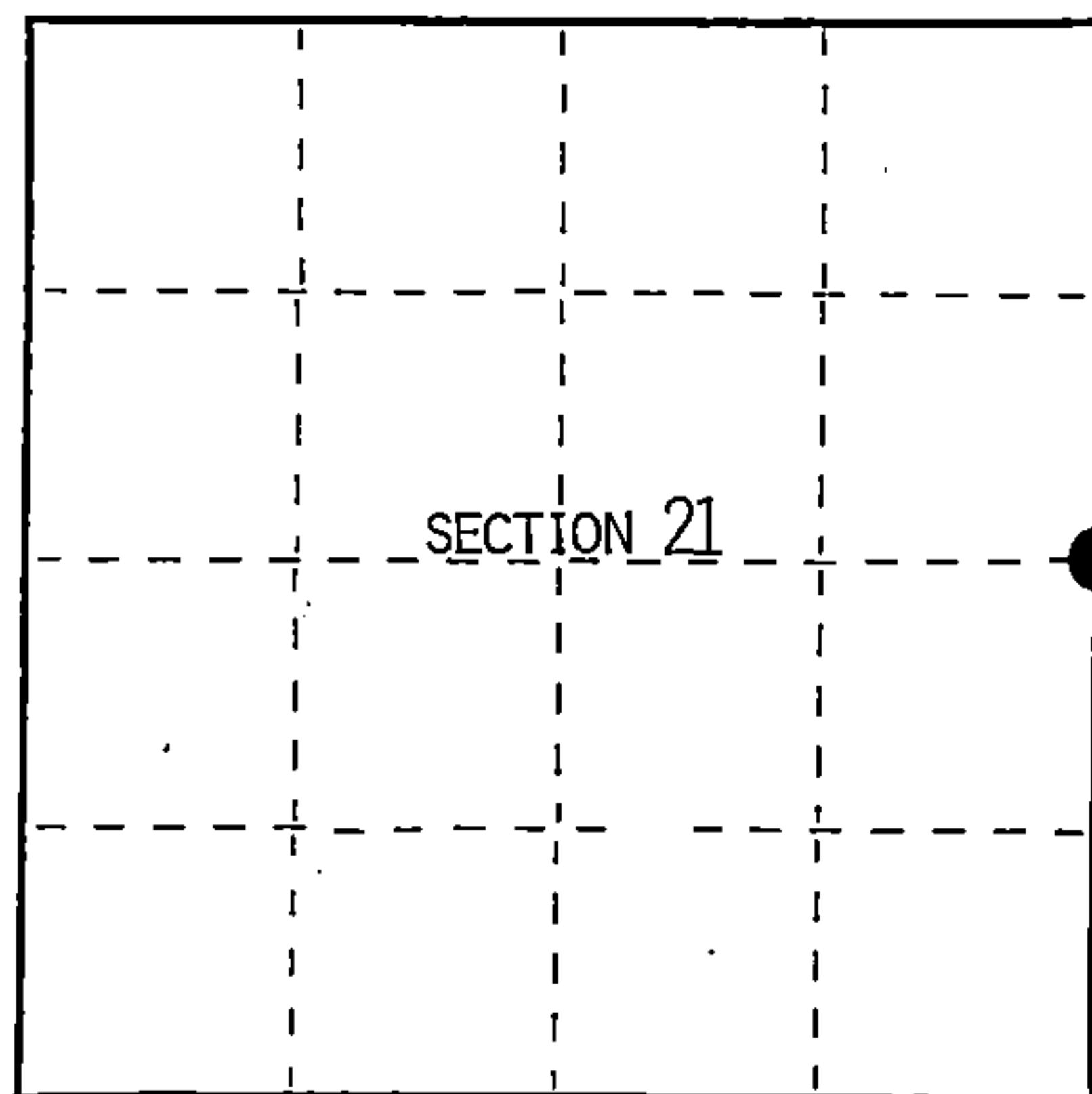

● = Corner monument restored:

CERTIFIED LAND CORNER RESTORATION

P-13
Index No.

History of original corner establishment:

Original Government Survey by William E. Daugherty in 1865.
At 40 chains North between sections 21 and 22, set post. From which:

Sugar	14"	S51°W	14 lks
Lynn	7"	N48°E	22 lks

Description of corner evidence found:

No original corner evidence was found. No other corner evidence found.

I reestablish the corner position at proportionate distance and line between the
the Northeast and Southeast section corners.o section 21.

Description of monument and accessories I established to perpetuate the original location of this corner.

At the corner position, set a 2½"X36" aluminum pipe monument 2½ feet in the ground
with an aluminum cap stamped: T39N, R13E, 1/4, S21, S22, 1994, S-1107 From which:

Maple	16"	S76°E	31.77 feet
Maple	8"	S 5°W	32.08 feet
Steel sign post		Southeast	1.00 feet

Dated at Hiles, Wis., this 13 th day of December, 1994

Signature William B. Cochrane Land Surveyor Registration No. S-1107
(County Surveyor, Registered Land Surveyor, or other duly authorized official)

Office of Register of Deeds, County of Forest, I hereby certify that the within
instrument was filed in this office for record on the 23rd day of August, 1994
at 2:30 o'clock P M.

(Register of Deeds)

By Paul J. Imbriey Deputy

43913212000

(e) Describe any material discrepancy between the location of the corner as restored or reestablished and the location of that corner as previously restored or reestablished by distance and direction. Show the discrepancy on the plan view drawing under (d), above. Show the distances between the corner as previously restored or reestablished and (1) the corner as restored or reestablished, and (2) to at least 2 of the witness monuments shown on the drawing in (d), above.

See drawing below.

(f) Was the corner restored through acceptance of (1) an obliterated evidence location, or, (2) a found perpetuated location?

Re-established through lost corner proportionate methods.

(g/h) Was the corner reestablished through lost corner proportionate methods? If so, show the method, including the directions and distances to other public land survey corners used as evidence or used for proportioning in determining the corner location?

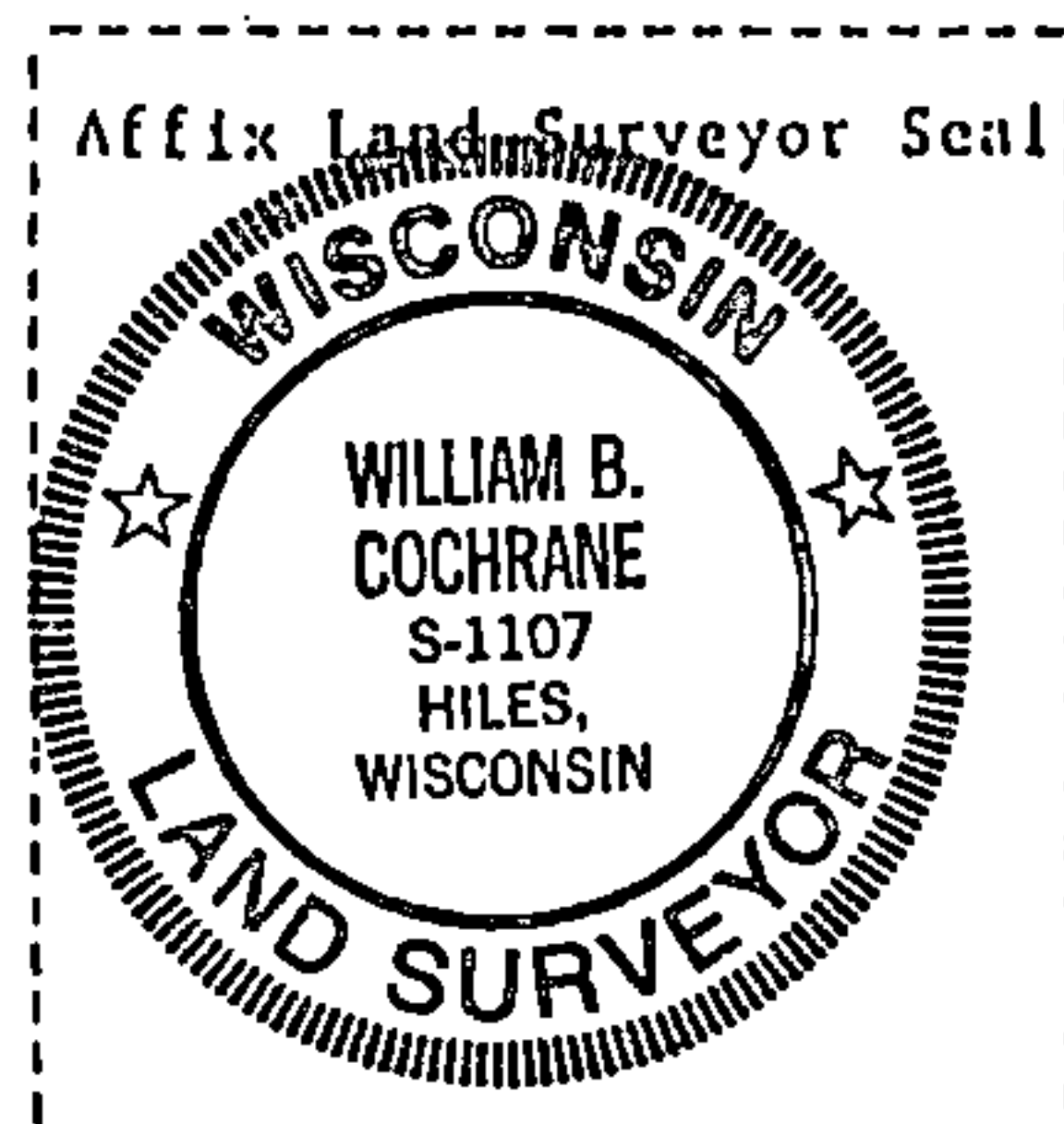
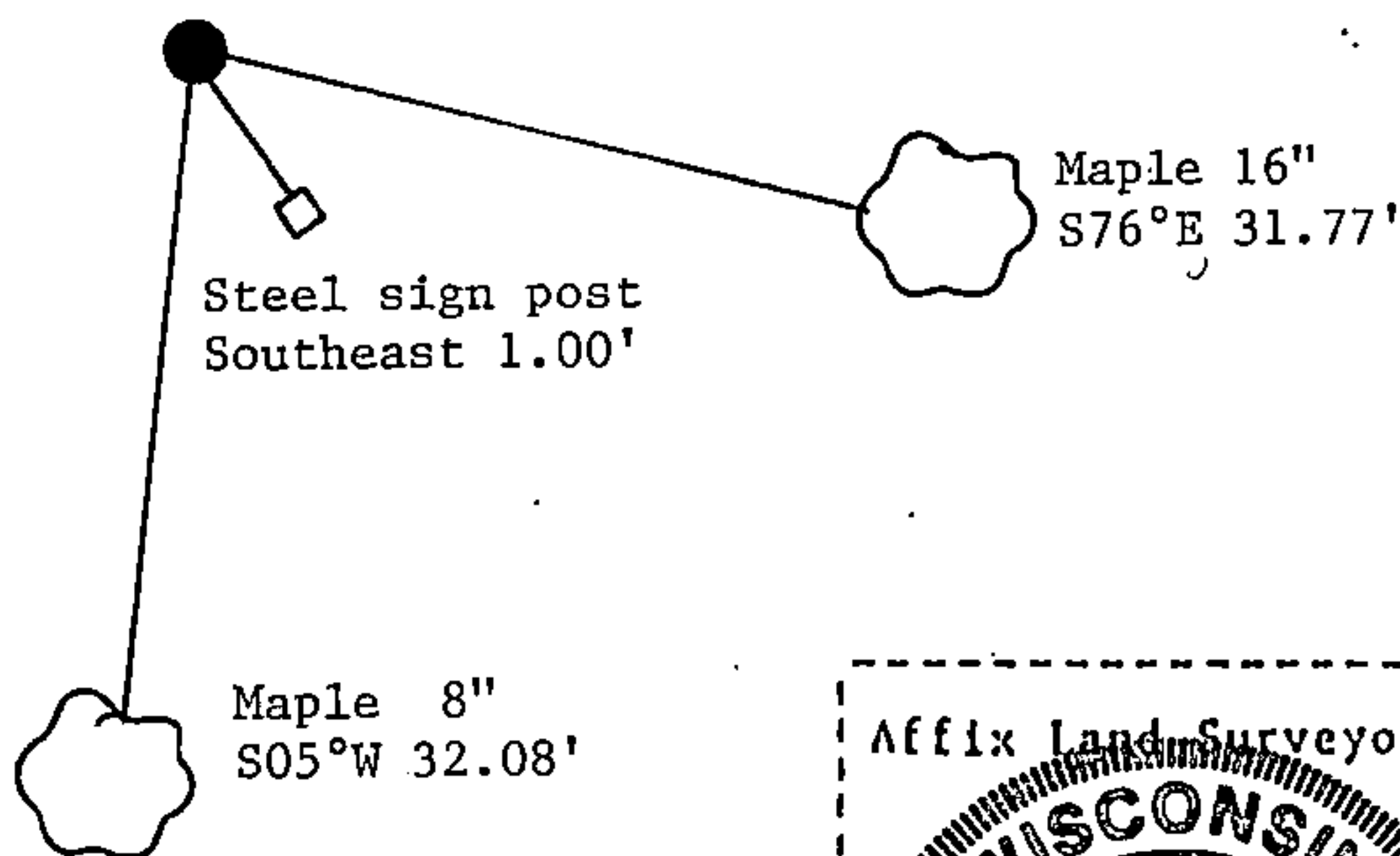
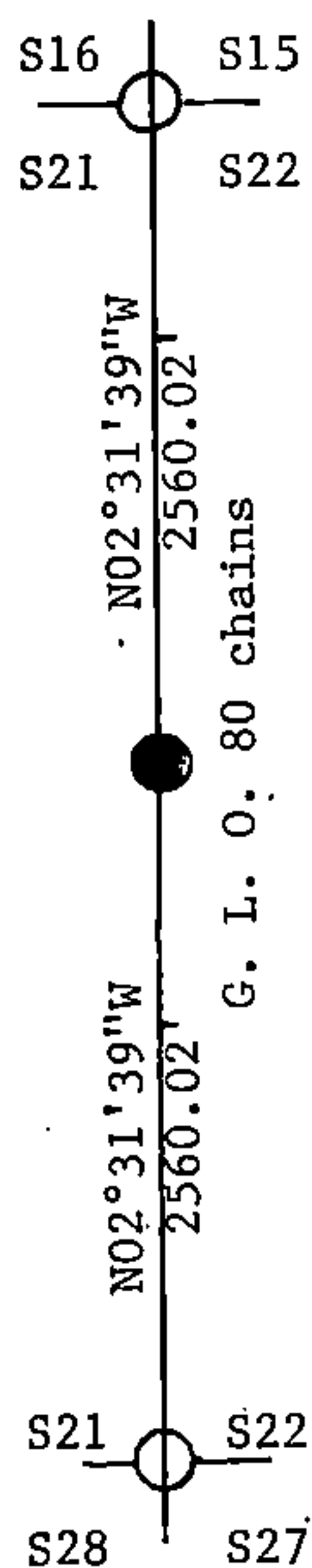

(i) 1. William B. Cochrane
(Type or print name) certify that the corner location shown on this record was determined by me or under my direction and control and that this U.S. Public Land Survey Monument Record is correct and complete to the best of my knowledge and belief.

Signature

Date

Survey requested by:

District Ranger

Date