

Stock No. 26273

156548

FORM 985 H. C. MILLER CO., MILWAUKEE

State of Wisconsin }
County of Forest } ss.

I, William B. Cochran, do hereby
certify that on the 29th day
of April, 1992, I found
evidence of the Northwest Section
corner of Section 1
Township 38, North, Range
13 East, Fourth Principal Meridian,
as described hereon; and that from this evidence
I established a new monument and accessories
as described hereon to perpetuate the original
location of this corner.

Resident witnesses:

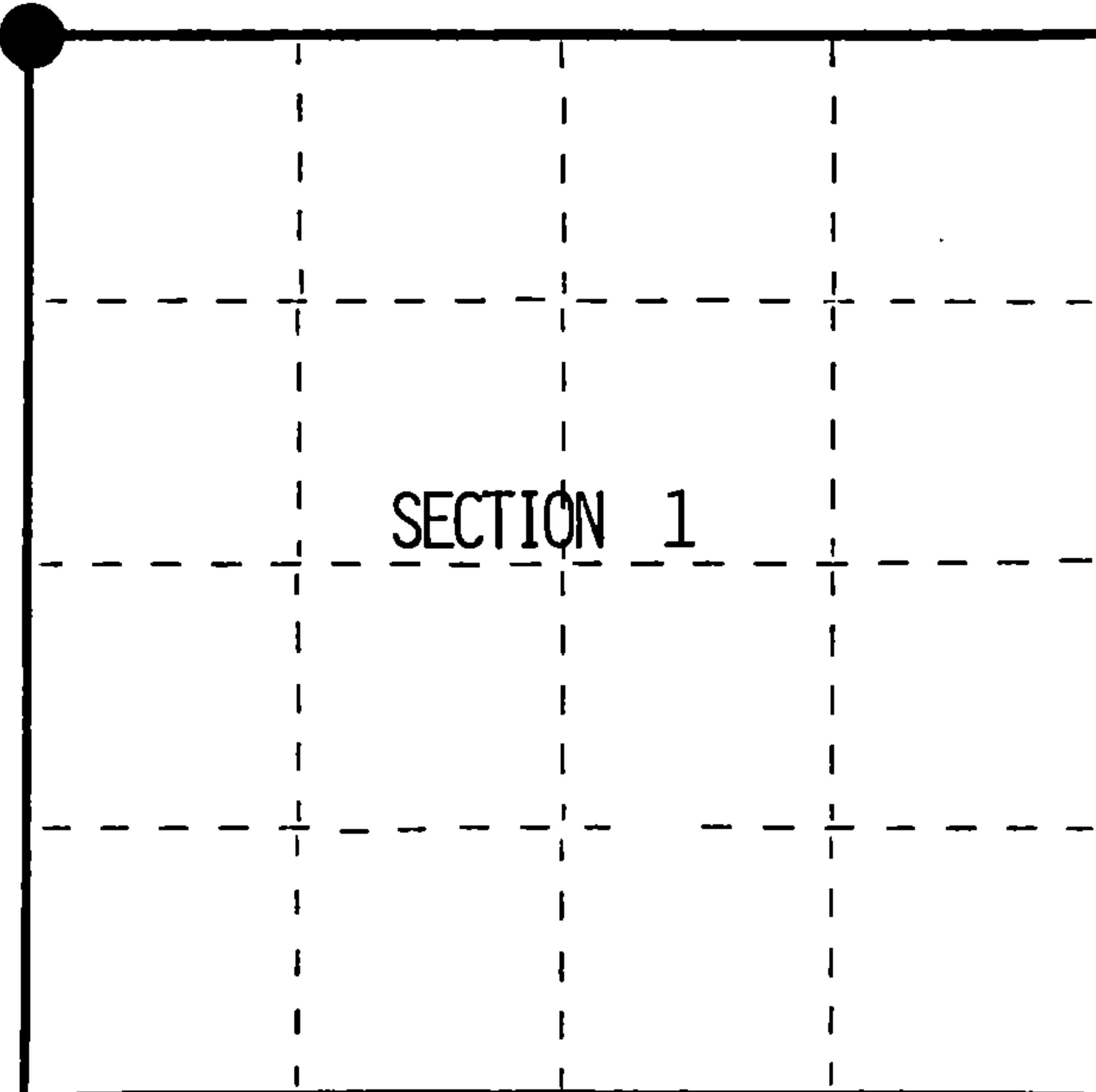

● = Corner monument restored.

CERTIFIED LAND CORNER RESTORATION

Index No. A-21

History of original corner establishment:

Original Government survey of the Township lines was done in 1858 by Alfred Millard.
West between sections 1 and 36 at 80 chains set post. From which:

Hemlock	14"	N05°W	41 lks
Y. Birch	12"	N34°E	31 lks
Y. Birch	10"	S54°E	52 lks
Hemlock	14"	S05°W	56 lks

Description of corner evidence found:

No corner evidence was found.

Re-establish the corner position by single proportionate methods.

Description of monument and accessories I established to perpetuate the original location of this corner.
At the corner position, set a railroad spike flush with the road surface from which:

Maple	10"	N75°E	47.07 feet
Maple	10"	S71°E	50.37 feet
Maple	10"	S61°W	47.15 feet
Maple	10"	N81°W	52.05 feet

Reference monument $2\frac{1}{2}$ "X36" aluminum pipe with an aluminum cap stamped: Witness corner,
T39N, R13E, S35, S36, S2, S1, 1992, T38, West 33 ft, S-1107. from which:

Steel sign post	East	.50 feet
-----------------	------	----------

Dated at Hiles, Wis., this 3 rd day of January, 1995

Signature William B. Cochran Title Land Surveyor Registration No. S-1107
(County Surveyor, Registered Land Surveyor, or other duly authorized official)

Office of Register of Deeds, County of Forest, I hereby certify that the within
instrument was filed in this office for record on the 23rd day of August, 1996
at 2:30 o'clock P M.

(Register of Deeds)

By Paul J. Jankiewicz Deputy

4391335 0000

(e) Describe any material discrepancy between the location of the corner as restored or reestablished and the location of that corner as previously restored or reestablished by distance and direction. Show the discrepancy on the plan view drawing under (d), above. Show the distances between the corner as previously restored or reestablished and (1) the corner as restored or reestablished, and (2) to at least 2 of the witness monuments shown on the drawing in (d), above.

See drawing below.

(f) Was the corner restored through acceptance of (1) an obliterated evidence location, or, (2) a found perpetuated location?

Re-established on line between the North Quarter corner of section 2 and the Northeast Section corner of section 1, and in the center line of State Highway 55.

(g/h) Was the corner reestablished through lost corner proportionate methods? If so, show the method, including the directions and distances to other public land survey corners used as evidence or used for proportioning in determining the corner location?

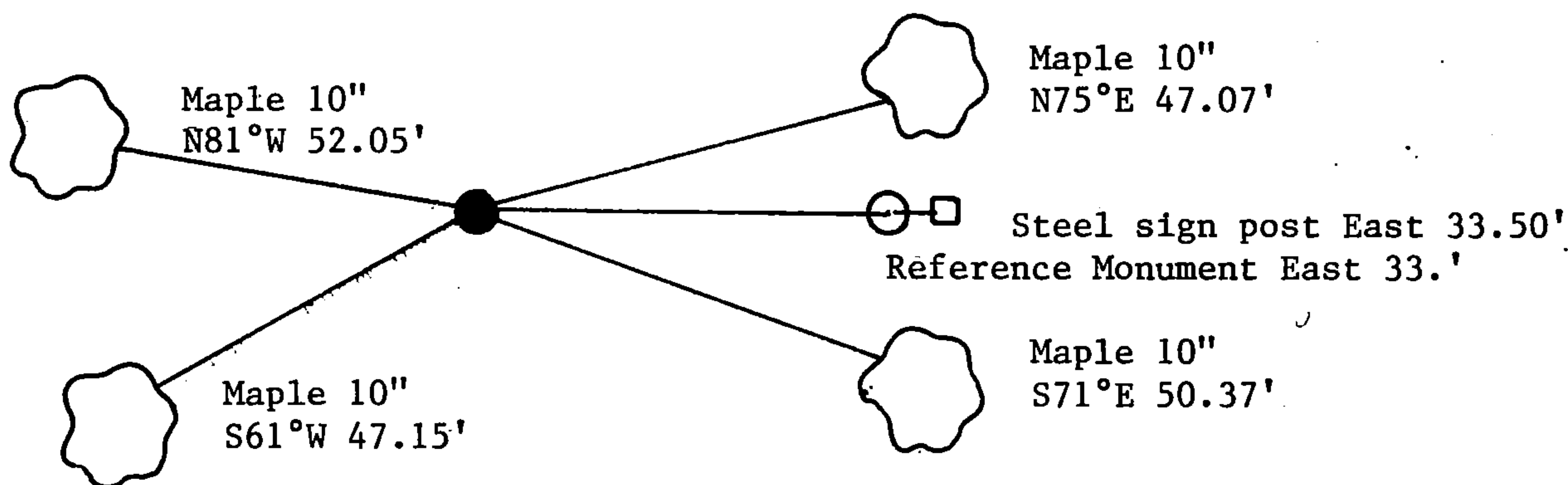

William B. Cochrane

(i) I, _____
(type or print name) certify that the corner location shown on this record was determined by me or under my direction and control and that this U.S. Public Land Survey Monument Record is correct and complete to the best of my knowledge and belief.

William B. Cochrane

Signature

1/3/95

Date

