

CERTIFIED LAND CORNER RESTORATION

State of Wisconsin

County of Forest

ss.

I William B. Cochrane, do hereby certify that on the 29 day of September, 1975, I found evidence of the Northeast Section corner of Section 16 Township 39 North Range 14 East, Fourth Principal Meridian, as described hereon; and that from this evidence I established a new monument and accessories as described hereon to perpetuate the original location of this corner:

Description of original monument and accessories and subsequent restorations:

Surveyed in 1865 by Wm. E. Daugherty
North between Sections 15 and 16
80.00 chains set post corner to Sections 9, 10, 15 and 16
Cedar, 12", S50°E, 11 lks.
White pine, 5", N10°W, 30 lks.
South, 22 chains, stream, 100 lks. wide, runs SE
East, 25 chains, stream, 100 lks. wide, runs N70°E
West, 20 chains, stream, 100 lks. wide, runs South

Description of corner evidence found:

6x6 cedar post, scribed and in place
N10°W, 30 lks. from post, white pine stump remains
No evidence of the cedar bearing tree
Cedar stump, 6", N10°E, 7 lks. Overgrowth with scribe impression. Not original.
South, 22 chains, Pine River, 100 lks. wide, runs SE
West, 24 chains, Pine River, 100 lks. wide, runs South
East 25 chains, Pine River, 100 lks wide, runs N70°E

Description of monument and accessories I established to perpetuate the location of this corner:

August 12, 1977, I replaced the post with a 2 inch inside diameter, galvanized pipe, 6 feet long, filled with 3 feet of concrete, with a brass cap stamped: T39N, R14E, S9, S10, S15, S16, 1977, S-1107

From which the following bear:

Cedar, 10", S55°W, 7.67 feet
Cedar, 8", N34°W, 4.67 feet
Steel sign post, North, 0.50 feet

Note: Monument is tipped to the West. When driving the monument, it wedged between two large rocks about 3 feet below the ground.

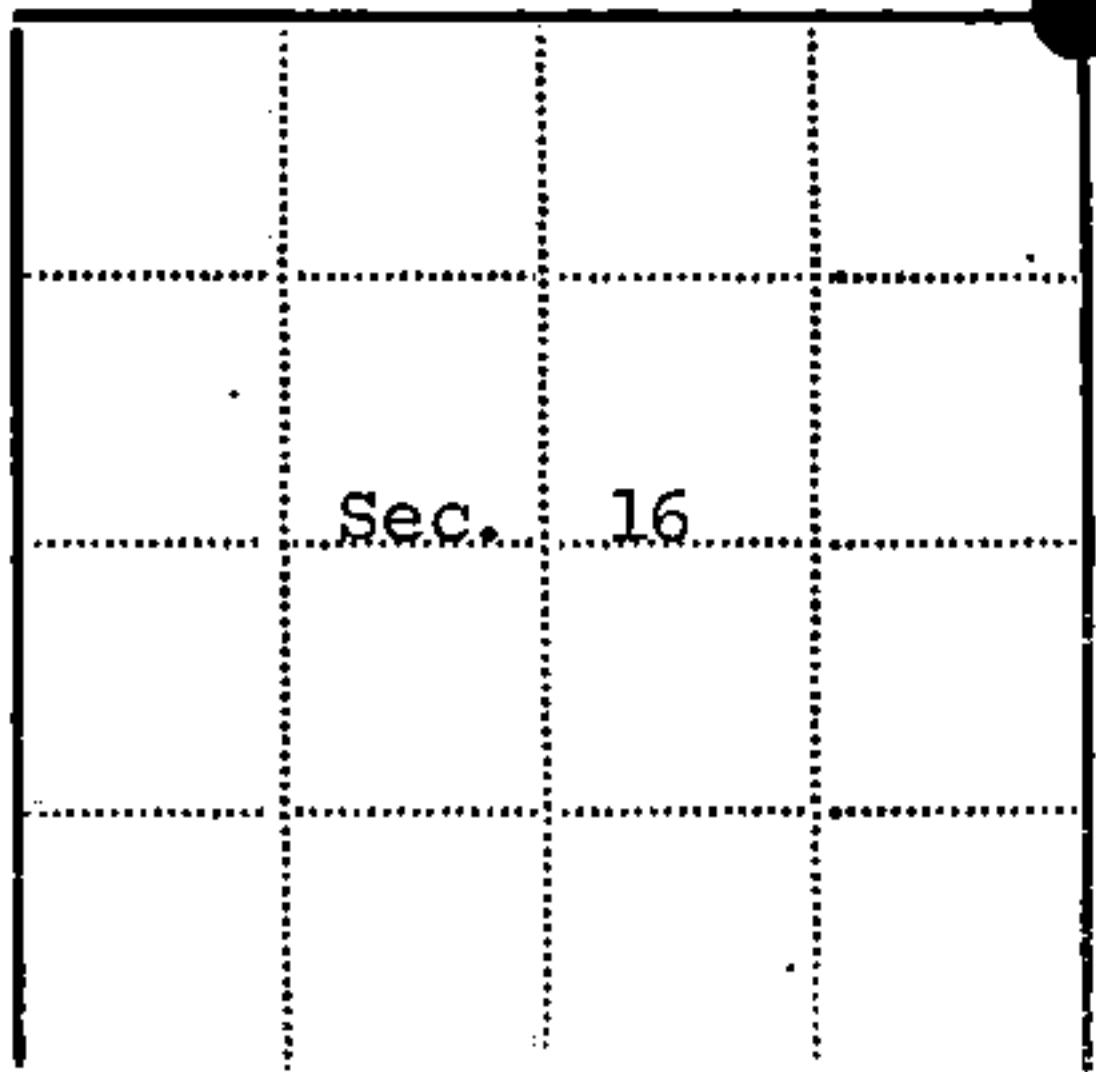

● - Corner monument restored
□ -

Resident witnesses

Dated at Laona Wisconsin, this 29 day of August, 1977.

Signature William B. Cochrane Title Survey Technician
(County Surveyor, Registered Land Surveyor, or other duly authorized official)

Surveyors Registration No. S-1107

Office of Register of Deeds County of Forest

I hereby certify that the within instrument was filed in this office for record on the 13th day of February, 1978, and was filed in Book No. Page No. of County Records.

Signature Eugene Staszny Title Register of Deeds

Township 39 North Range 14 East Section 16 Index No. J-13 Page No.

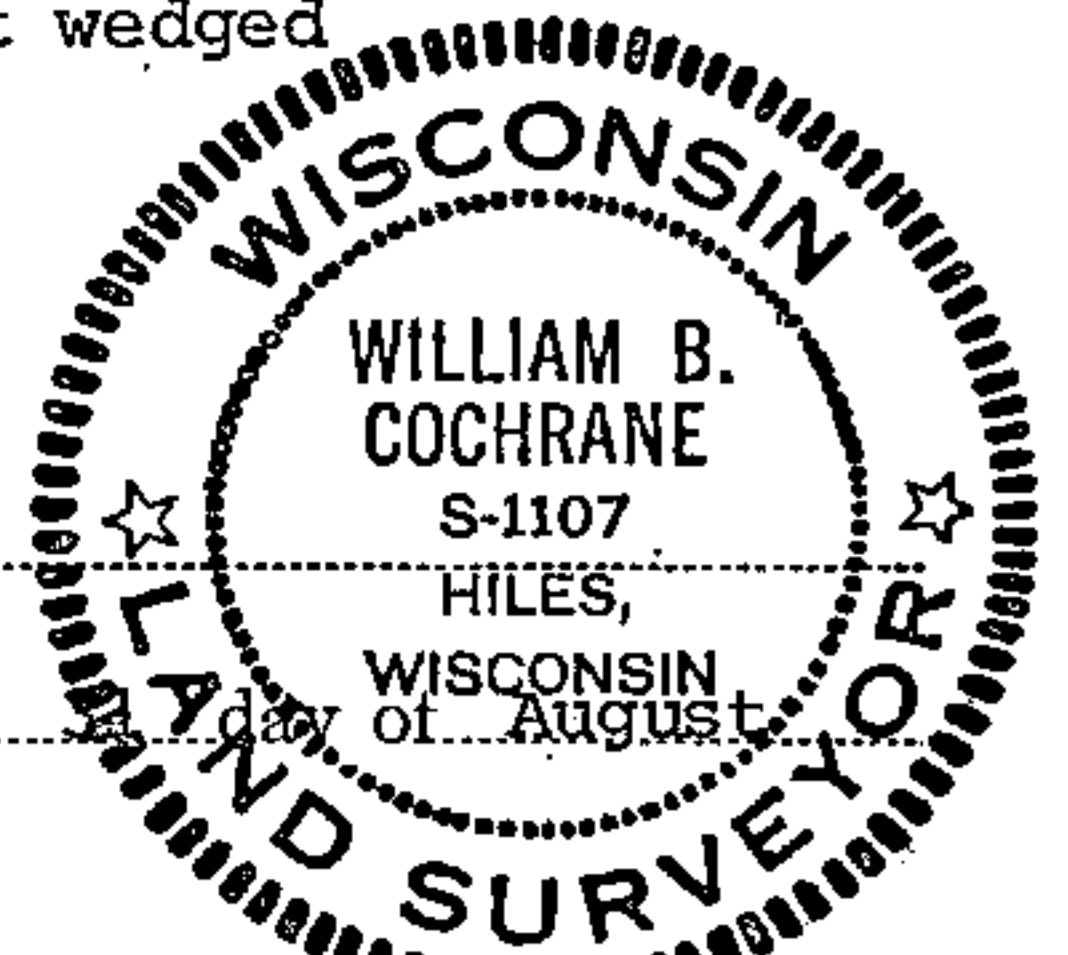

DOCUMENT NUMBER 113310

113

U.S. PUBLIC LAND SURVEY MONUMENT RECORD

Index No. J-13

State of Wisconsin }
 County of Forest } ss.

I, William B. Cochran, do hereby
 certify that on the 25th day
 of July, 1985, I found
 evidence of the Northeast Section
 corner of Section 16
Township 39, North, Range
14 East, Fourth Principal Meridian,
 as described hereon; and that from this evidence
 I established a new monument and accessories
 as described hereon to perpetuate the original
 location of this corner.

Resident witnesses:

Tony Tillman

State Plane Co-ordinates
 N- 258,114.2760
 E-2,321,728.1700

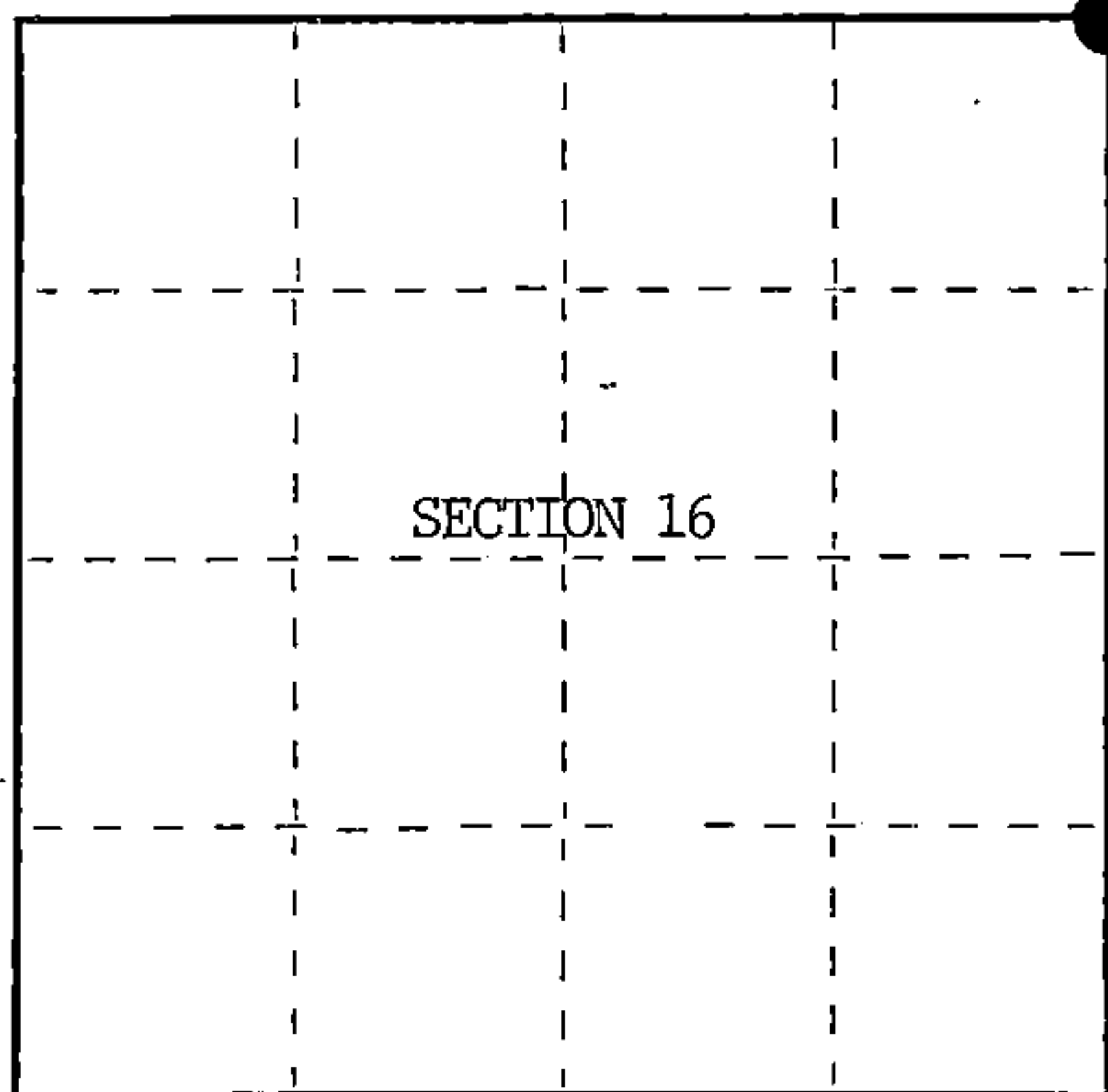

○ = Corner monument restored.

History of original corner establishment:

Original Government Survey in 1865 by William E. Daugherty and Alex McDill.

Corner restored on August 12th, 1977, by William B. Cochran, a Registered Land Surveyor with the U.S. Forest Service.

See Certified Land Corner Restoration Certificate #113310, filed in the Registrar of Deeds Office, in the Forest County Courthouse.

Description of corner evidence found:

Found monument as described and in place, from which the following bear;

Cedar	12"	N55°W	7.67 feet
Cedar	8"	N34°W	4.67 feet
Steel Sign Post		North	0.50 feet

All of the above bearing trees were cut down for the Aerial Photo Project.

Description of monument and accessories I established to perpetuate the original location of this corner.

Blazed and scribed the following new bearing trees;

Cedar	10"	North	53.50 feet
Cedar	11"	S48°E	37.53 feet
Cedar	12"	S84°W	50.57 feet
Cedar	10"	N30°W	36.01 feet

Re-set Steel Sign Post NE 2.00 feet

Dated at Hiles, Wis., this 5th day of February, 1986

Signature William B. Cochran Title Land Surveyor Registration No. S-1107
 (County Surveyor, Registered Land Surveyor, or other duly authorized official)

Office of Register of Deeds, County of Forest, I hereby certify that the within
 instrument was filed in this office for record on the 11th day of March, 1987
 at 3:30 clock P. M.

Paul Aschenbrenner
 (Register of Deeds)

By _____ Deputy

(e) Describe any material discrepancy between the location of the corner as restored or reestablished and the location of that corner as previously restored or reestablished by distance and direction. Show the discrepancy on the plan view drawing under (d), above. Show the distances between the corner as previously restored or reestablished and (1) the corner as restored or reestablished, and (2) to at least 2 of the witness monuments shown on the drawing in (d), above.

See drawing below.

(f) Was the corner restored through acceptance of (1) an obliterated evidence location, or, (2) a found perpetuated location?

Restored through acceptance of a found perpetuated location.

(g&h) Was the corner reestablished through lost corner proportionate methods? If so, show the method, including the directions and distances to other public land survey corners used as evidence or used for proportioning in determining the corner location?

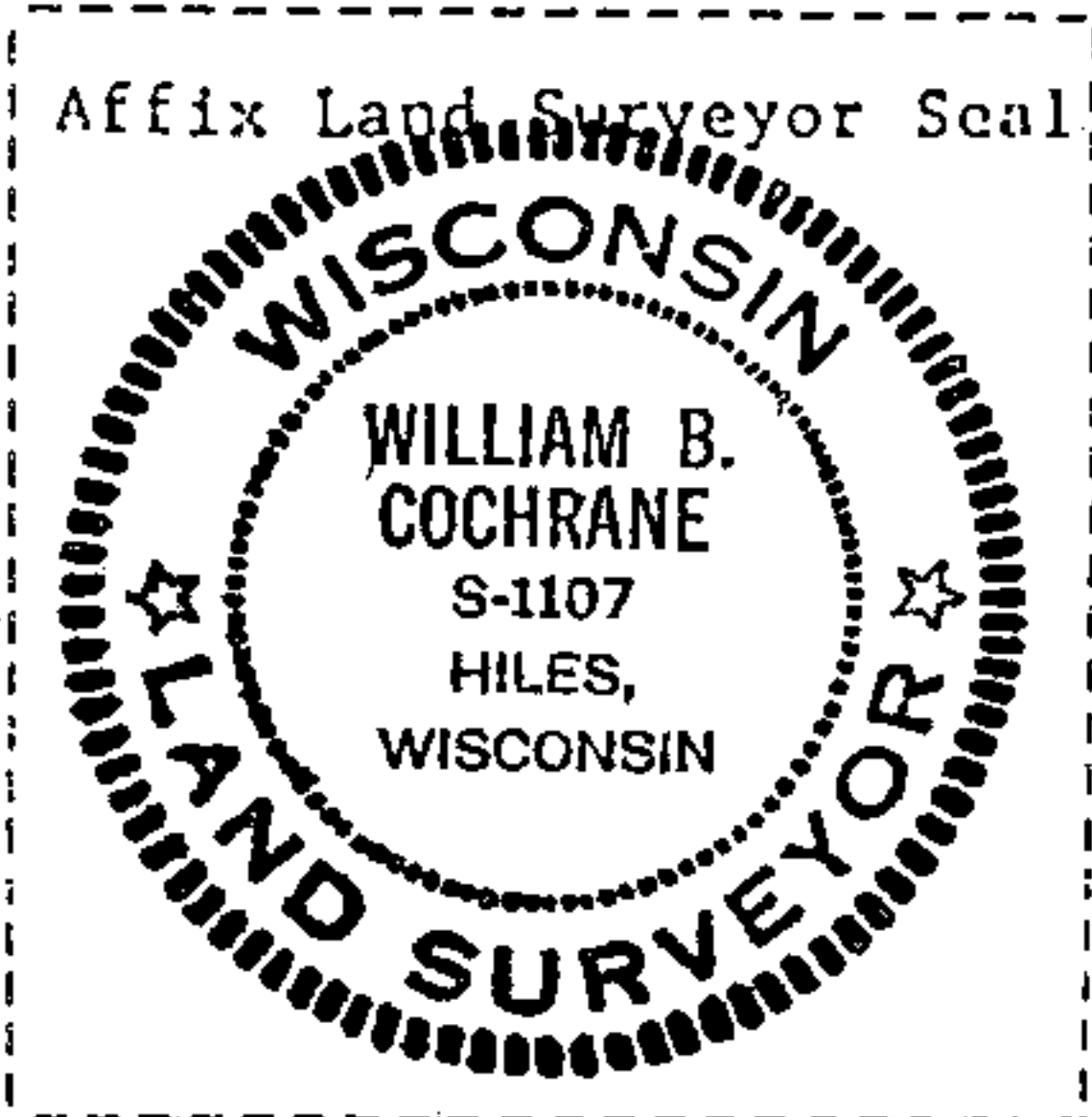
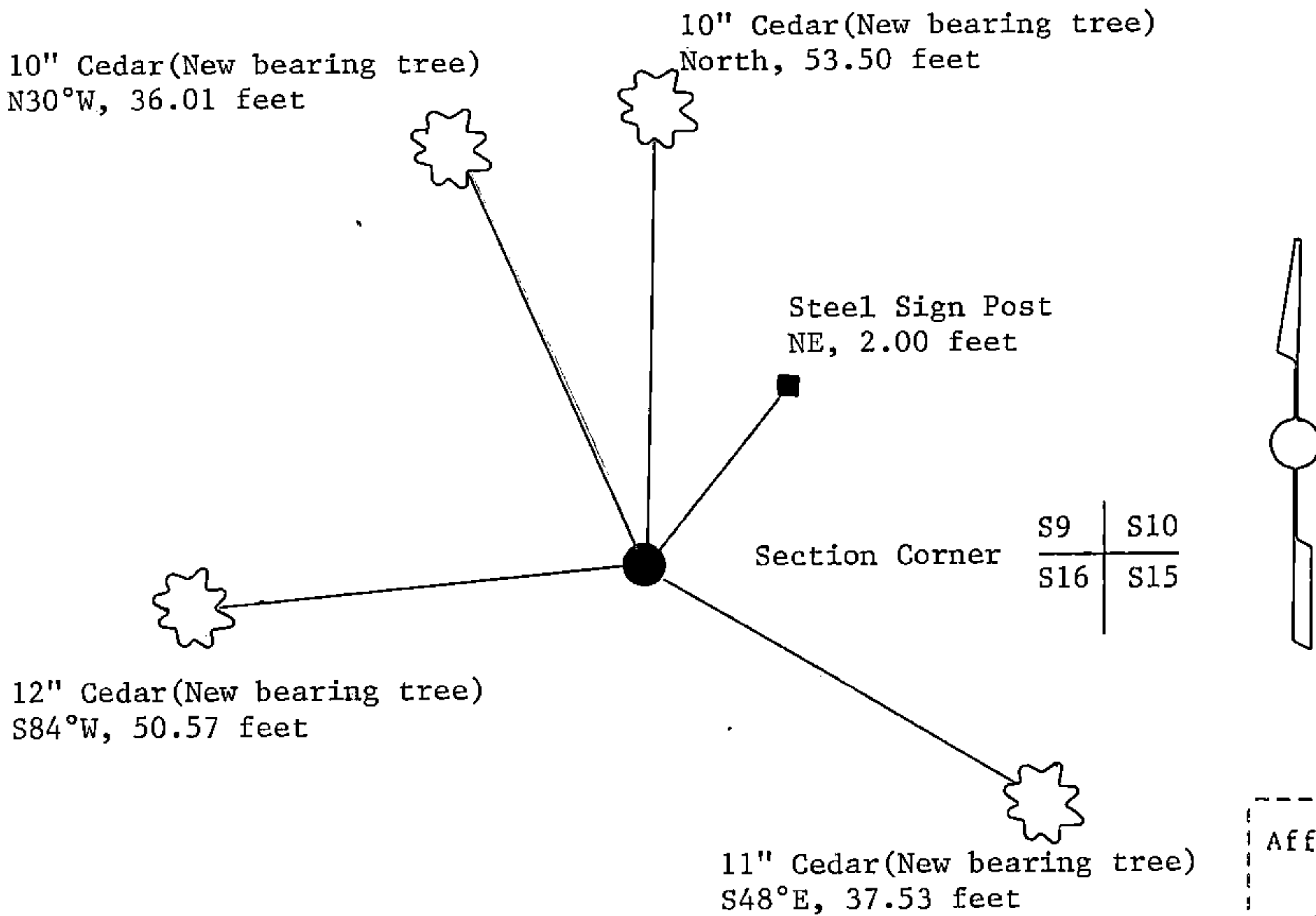

(i) I, William B. Cochrane
(type or print name) certify that the corner location shown on this record was determined by me or under my direction and control and that this U.S. Public Land Survey Monument Record is correct and complete to the best of my knowledge and belief.

William B. Cochrane October 7, 1986
Signature Date

Survey requested by; [Signature] 3-9-87
District Ranger Date