

## CERTIFIED LAND CORNER RESTORATION

State of Wisconsin

County of Forest

ss.

I William B. Cochrane, do hereby certify that on the 4th day of June, 1974, I found evidence of the East Quarter corner of Section 13 Township 39 North, Range 14 East, Fourth Principal Meridian, as described hereon; and that from this evidence I established a new monument and accessories as described hereon to perpetuate the original location of this corner:

## Description of original monument and accessories and subsequent restorations:

Surveyed in May 1858 by Artemas Curtiss.

North between Sections 13 and 18. 40.0 chains set quarter section post.

W. Pine, 22", S54°W, 18 lks.

Y. Pine, , N74°E, 15 lks.

## Description of corner evidence found:

No post was found.

From a point, a white pine snag, 20", bears S54°W, 18 lks.

The snag is fire scared and old axe marks (notch) are visible.

From same point red pine stump bears N74°E, 15 lks.

Since June 1974, logging has destroyed the white pine snag.

## Description of monument and accessories I established to perpetuate the location of this corner:

At the corner position as determined from original evidence, I set a 2 inch inside diameter, galvanized pipe, 3 feet long, filled with concrete, with a brass cap stamped: T39N, R14E, R15E, 1/4, S13, S18, 1975, S-1107.

From which the following bear:

Red Pine, 17", S23°E, 11.52 feet

Red Pine, 23", S87°W, 16.00 feet

Set a steel sign post, SW of the monument, 0.50 feet.

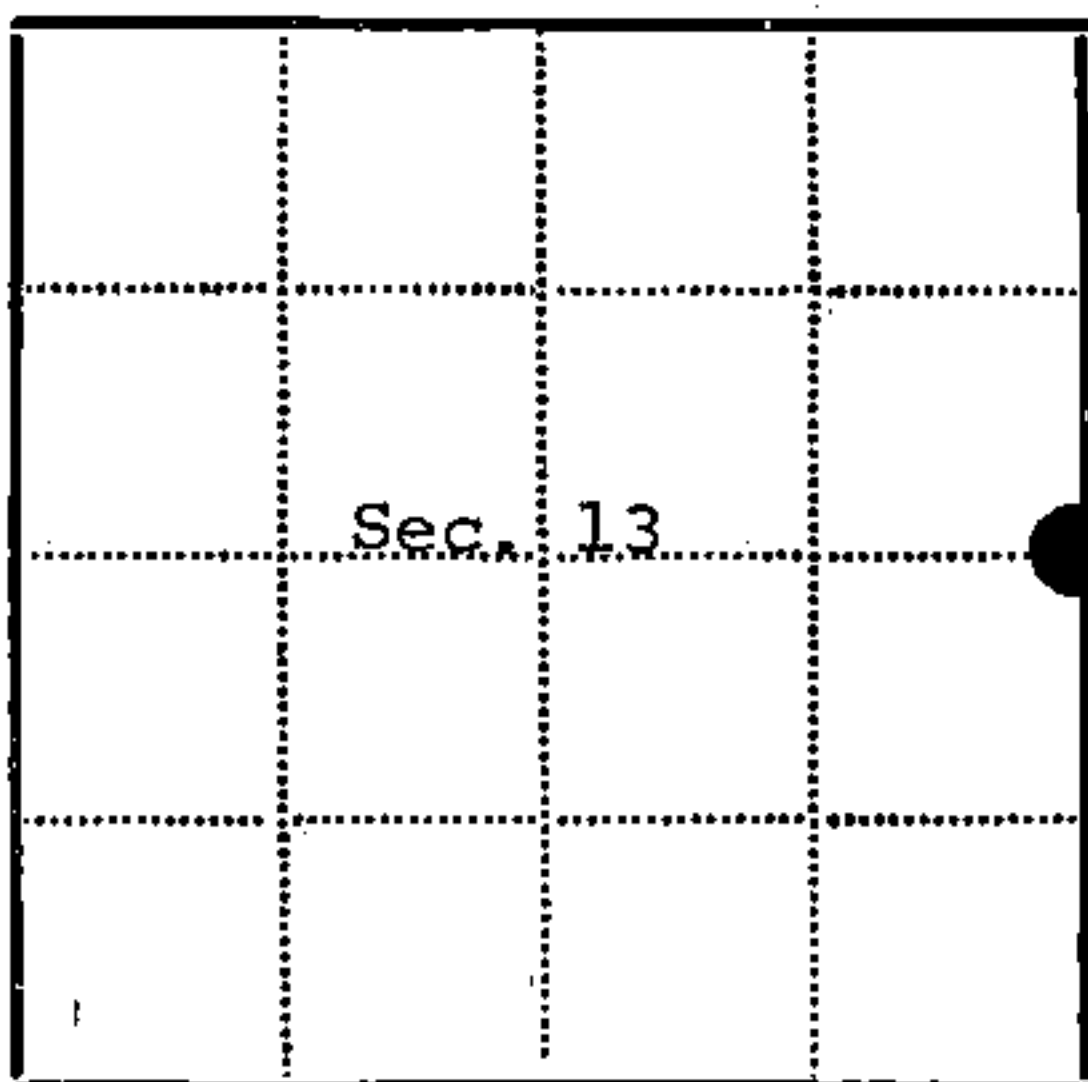
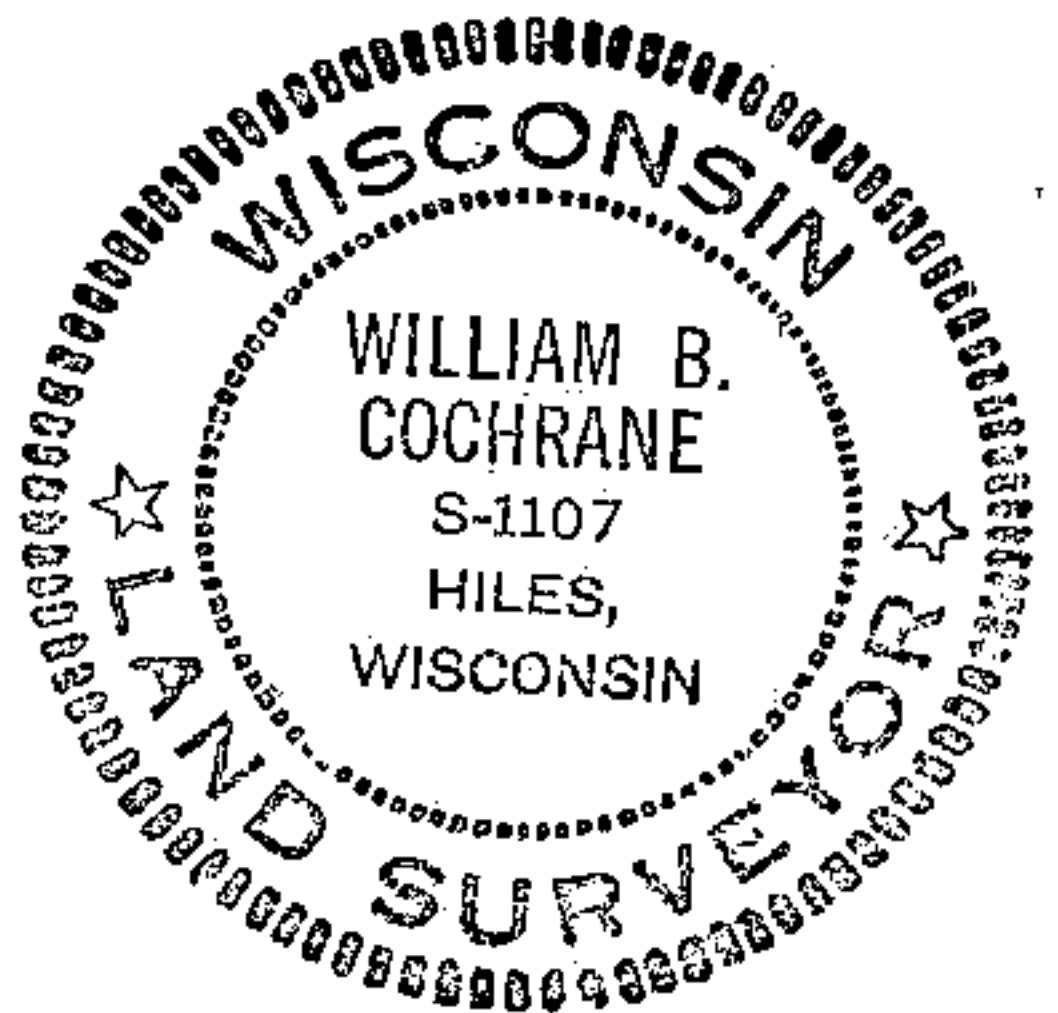

● = Corner monument restored

□ =

Resident witnesses

Dated at Three Lakes Wisconsin, this 12th day of June 1975.

Signature William B. Cochrane Title Survey Technician  
(County Surveyor, Registered Land Surveyor, or other duly authorized official)

Surveyors Registration No. S-1107

DOCUMENT NUMBER 107235

Office of Register of Deeds County of Forest

I hereby certify that the within instrument was filed in this office for record on the 16th day of June 1975, and was filed in Book No. Page No. of County Records.

Signature Eugene Stutz Title Register of Deeds

Township 39 North, Range 14 East, Section 13, Index No. L-25, Page No.

43914132000