

U.S. PUBLIC LAND SURVEY MONUMENT RECORD

Index No. A 7-8

State of Wisconsin }  
County of Forest } ss.

I, Robert H. Winat, do hereby certify that on the 24th day of January, 1985, I found evidence of the meander corner of 5 Township 40, North, Range 12 East, Fourth Principal Meridian, as described hereon; and that from this evidence I established a new monument and accessories as described hereon to perpetuate the original location of this corner.

Resident witnesses:

Mike Stevens

Mike Lukasko

History of original corner establishment:

Dependent resurvey in 1941 by Guy R. Veal, set a 6"x24" concrete monument with a G.L.O. brass cap.

BT: Elm 7" S18¼°E 6 lks.

Description of corner evidence found:

Found 1" iron pipe up 2". Found 6"x6" broken concrete N64°E 6' from pipe in bank eroded by water. Found 6"x6"x12" concrete piece in water, no base.

Found BT's:

White Birch 8" S42°W 9.10' (set nail in tree)  
Sugar Maple 13" S20°E 4.15' (set nail in tree)

Description of monument and accessories I established to perpetuate the original location of this corner.

Set a 2"x36" aluminum monument with 3" aluminum tablet stamped to identify corner. Blazed and scribed the following BT's:

Sugar Maple 7" S50°W 16.72' to nail in tree  
Steel Sign Post East 2.00'

Reference to Standard Corner between Sections 32|33 T41N, R12E, marked by a G.L.O. Brass Cap; S89°55'50"W, 380.22'.

(over)

Dated at Rhineland, Wis., this 14 day of June, 1985.

Signature Robert H. Winat Title R.L.S. Registration No. 1040  
(County Surveyor/Registered Land Surveyor, Wisconsin)

Office of Register of Deeds, County of Forest. I hereby certify that the within instrument was filed in this office for record on the 24th day of July, 1985 at 1:10 o'clock P. M.

Paul Aschenbrenner  
(Register of Deeds)

By \_\_\_\_\_ Deputy

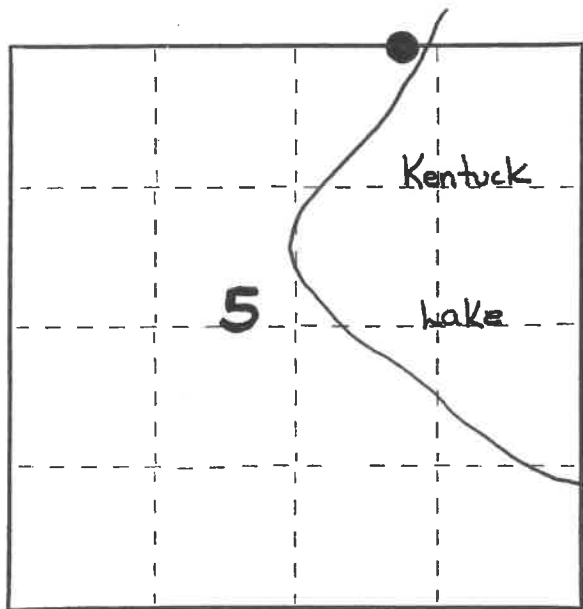

○ = Corner monument restored.

FORM NO. 985-A  
H.C. Miller Company

Stock No. 26273

DOCUMENT NUMBER 128460

44012.05.4012

(e) Describe any material discrepancy between the location of the corner as restored or reestablished and the location of that corner as previously restored or reestablished by distance and direction. Show the discrepancy on the plan view drawing under (d), above. Show the distances between the corner as previously restored or reestablished and (1) the corner as restored or reestablished, and (2) to at least 2 of the witness monuments shown on the drawing in (d), above.  
 N/A.

(f) Was the corner restored through acceptance of (1) an obliterated evidence location, or, (2) a found perpetuated location?  
 Found perpetuated location.

(g&h) Was the corner reestablished through lost corner proportionate methods? If so, show the method, including the directions and distances to other public land survey corners used as evidence or used for proportioning in determining the corner location?  
 No.

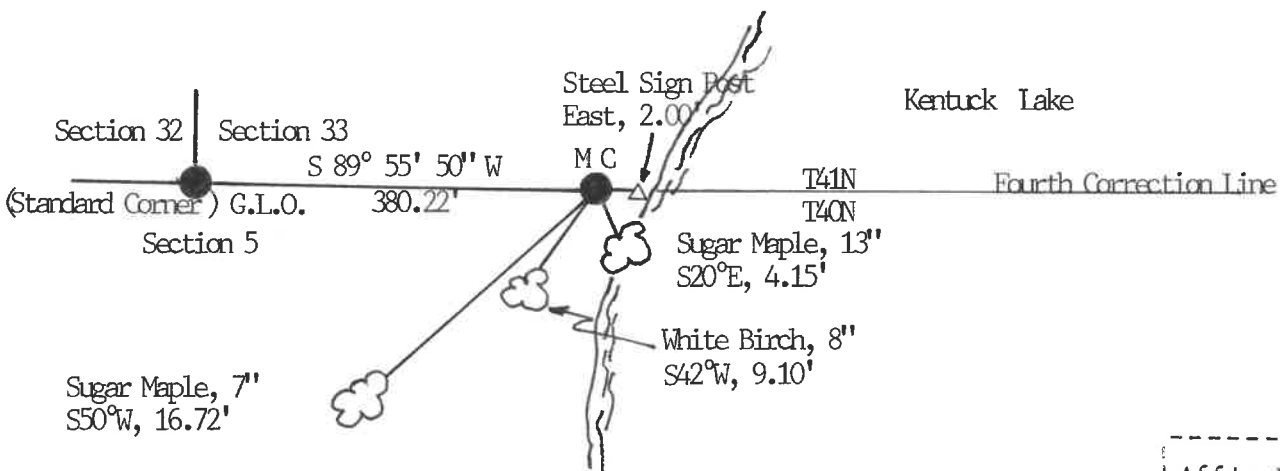

MC is set 2'X36" aluminum monument w/3" aluminum tablet, stamped to identify corner.



(i) I, Robert H. Winat  
 (type or print name) certify that the corner location shown on this record was determined by me or under my direction and control and that this U.S. Public Land Survey Monument Record is correct and complete to the best of my knowledge and belief.

Robert H. Winat Signature      17 June 1985 Date