

CERTIFIED LAND CORNER RESTORATION

State of Wisconsin }
County of Forest } ss.

I Jean F. Resvick, do hereby certify that on the 15 day of May, 1974, I found evidence of the North west section corner of Section 5 Township 40 north, Range 12 east, Fourth Principal Meridian, as described hereon; and that from this evidence I established a new monument and accessories as described hereon to perpetuate the original location of this corner:

Description of original monument and accessories and subsequent restorations:

Original survey 1857.
Dependent resurvey in 1941 by Guy R. Veal
Proportionate distance set concrete monument 2 feet long, 6 inches in diameter, with brass cap marked T41N, R12E, S32, S6, S5, T40N, R12E, CC 1941
Hemlock 10, S51° 30'E, 68.5 lks.
Hemlock 15, S21W, 102 lks.

Description of corner evidence found:

Monument found as described
Hemlock 11, snag bears S57' 30E, 68.5 lks.
Hemlock 19, bears S21W, 102 lks.

Description of accessories I established to perpetuate the location of this corner:

Blazed and scribe the following new bearing tree
Yellow Birch 8, S62E, 8.68 feet.
Set steel sign post 0.8 feet south of monument.

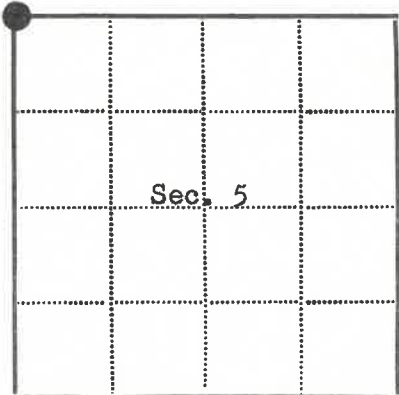

● - Corner monument restored
□ -

Resident witnesses _____

Dated at Rhinelander Wisconsin, this 30 day of May 1974.

Signature Jean F. Resvick Title Land Surveyor
(County Surveyor, Registered Land Surveyor, or other duly authorized official)

Surveyors Registration No. S-802 DOCUMENT NUMBER 105820

Office of Register of Deeds County of Forest

I hereby certify that the within instrument was filed in this office for record on the 8th day of August 1974, and was filed in Book No. Corner Restorations Page No. A-5 of County Records.

Signature Eugene Staszynski Title _____

Township 40 north, Range 12 east, Section 5, Index No. A-5, Page No. _____

44012064000

A
5