

Stock No. 26273

DOCUMENT NUMBER  
132164

REGISTER'S OFFICE  
Forest County, Wis.  
Received for record this 24th day  
of February D., 1987 at  
\_\_\_\_\_ o'clock \_\_\_\_\_ M. and recorded  
in Vol. A-19 **CORNER RESTORATIONS**  
Paul Aschenbrenner  
Register of Deeds

## U.S. PUBLIC LAND SURVEY MONUMENT RECORD

Index No. A-19

State of Wisconsin }  
County of Forest } ss.

I, William B. Cochrane, do hereby  
certify that on the 7th day  
of August, 1986, I found  
evidence of the North Closing Quarter  
corner of Section 2  
Township 40, North, Range  
13 East, Fourth Principal Meridian,  
as described hereon; and that from this evidence  
I established a new monument and accessories  
as described hereon to perpetuate the original  
location of this corner.

Resident witnesses:

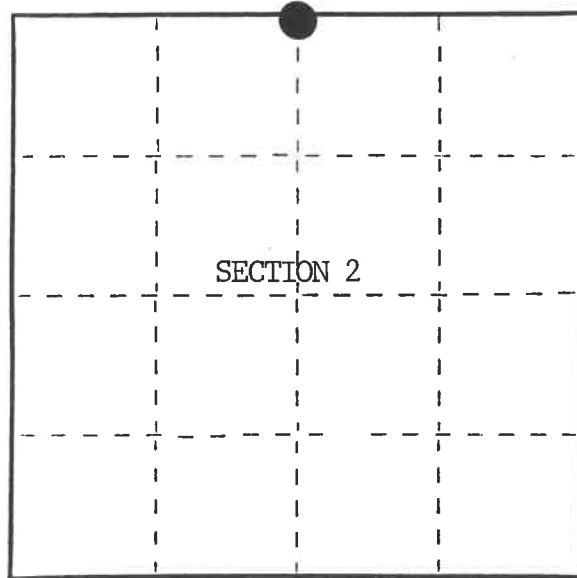
David BrownellTony Tillman

○ = Corner monument restored.

History of original corner establishment:

NONE

Description of corner evidence found:

NONE

The corner position was re-established at proportionate distance between the Northwest and Northeast Section Corners of Section 2, and on line between the Standard Quarter Section Corner of Section 35 and the Standard Section Corner common to Sections 35 and 36, T41N R13E.

Description of monument and accessories I established to perpetuate the original location of this corner.

At the corner position, set a Railroad Spike flush with blacktop, and stamped:  
1/4, S2. From which the following new blazed and scribed bearing trees bear;

Maple	9"	N77°E	81.62 feet
Maple	19"	S57°E	82.19 feet

Dated at Hiles, Wis., this 28th day of October, 1986

Signature William B. Cochrane Title Land Surveyor Registration No. S-1107  
(County Surveyor, Registered Land Surveyor, or other duly authorized official)

Office of Register of Deeds, County of Forest  
I hereby certify that the within  
instrument was filed in this office for record on the 24th day of February, 1987  
at 2:00 o'clock P. M.

Paul Aschenbrenner  
(Register of Deeds)

By \_\_\_\_\_ Deputy

44013024020

e) Describe any material discrepancy between the location of the corner as restored or reestablished and the location of that corner as previously restored or reestablished by distance and direction. Show the discrepancy on the plan view drawing under (d), above. Show the distances between the corner as previously restored or reestablished and (1) the corner as restored or reestablished, and (2) to at least 2 of the witness monuments shown on the drawing in (d), above.

(f) Was the corner restored through acceptance of (1) an obliterated evidence location, or, (2) a found perpetuated location?

(g&h) Was the corner reestablished through lost corner proportionate methods? If so, show the method, including the directions and distances to other public land survey corners used as evidence or used for proportioning in determining the corner location?

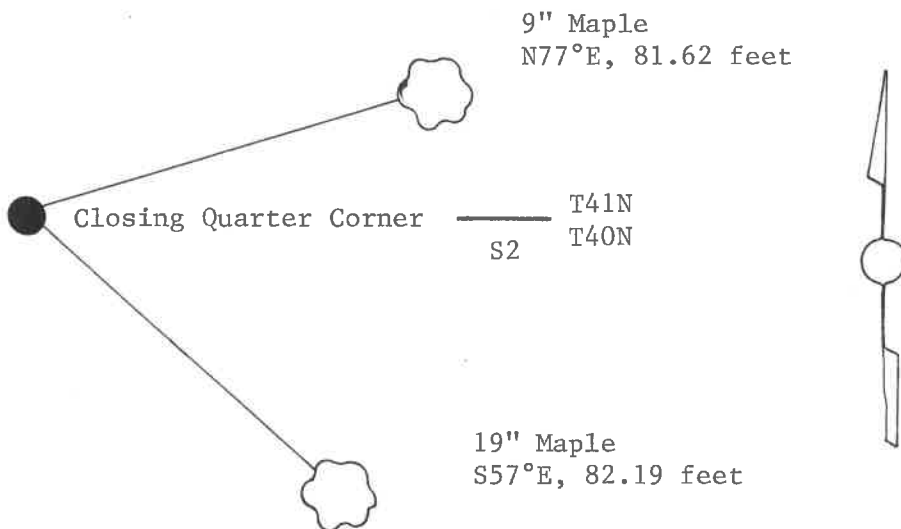
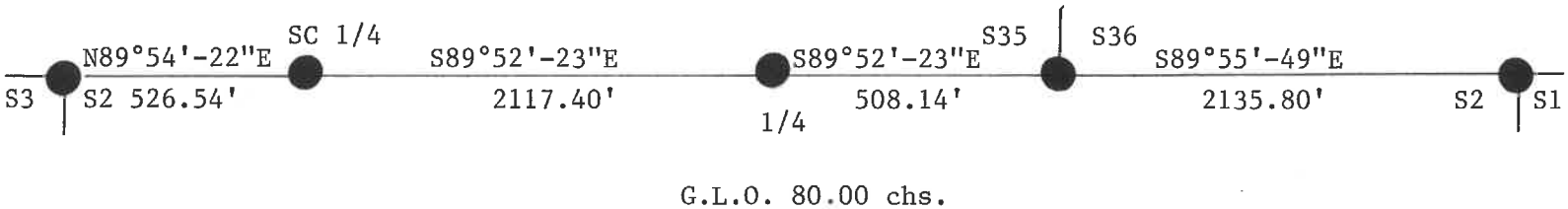

(i) I, William B. Cochrane  
(type or print name) certify that the corner location shown on this record was determined by me or under my direction and control and that this U.S. Public Land Survey Monument Record is correct and complete to the best of my knowledge and belief.

William B. Cochrane  
Signature

November 5, 1986  
Date

Certificate ready for filing:

D. Frank Haubry  
District Ranger

1/6/87  
Date