

CERTIFIED LAND CORNER RESTORATION

State of Wisconsin

County of Forest

ss.

I, William B. Cochrane, do hereby certify that on the 1st day of June, 1982, I found evidence of the Southwest Section corner of Section 20 Township 40 North, Range 13 East, Fourth Principal Meridian, as described hereon; and that from this evidence I established a new monument and accessories as described hereon to perpetuate the original location of this corner:

Description of original monument and accessories and subsequent restorations:

Original survey in 1865 by William E. Daugherty  
North between Sections 29 and 30, 80.00 chains, set post corner to Sections 19, 20, 29 and 30  
Tamarack, 7", N50E, 46 lks.  
Tamarack, 7", S76W, 25 lks.

Description of corner evidence found:

May 9, 1975, Jean Resvick found a Tamarack stump with reversed impression of bearing tree notch and overgrowth in stump. On the date I found the same described bearing tree, from the bearing tree stump, set a point S50W, 46 lks. No evidence of post or other bearing tree.

Description of monument and accessories I established to perpetuate the location of this corner:

From remains of original bearing tree stump, set an aluminum pipe monument, 2 1/2" diameter, 5' long, with an aluminum cap stamped T40N, R13E, S19, S20, S29, S30, 1982, S-1107

From which the following bear:

Spruce, 5", N87E, 8.23 ft.  
Spruce, 4", S8E, 26.21 ft.  
Spruce, 5", S41W, 34.90 ft.  
Spruce, 6", N62W, 11.78 ft.  
Steel sign post, Northwest, 1.0 ft.

DOCUMENT NO.  
124420

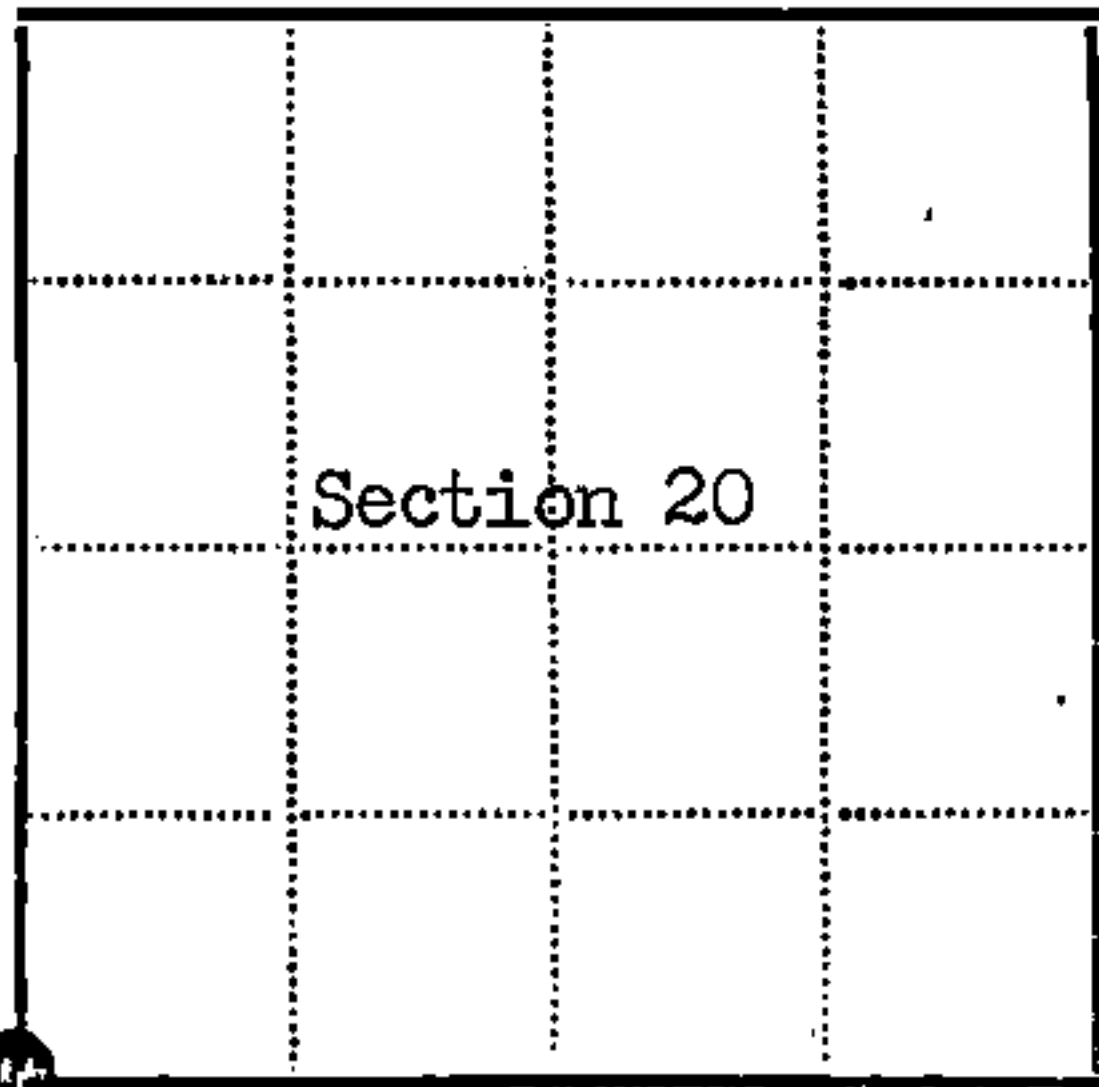
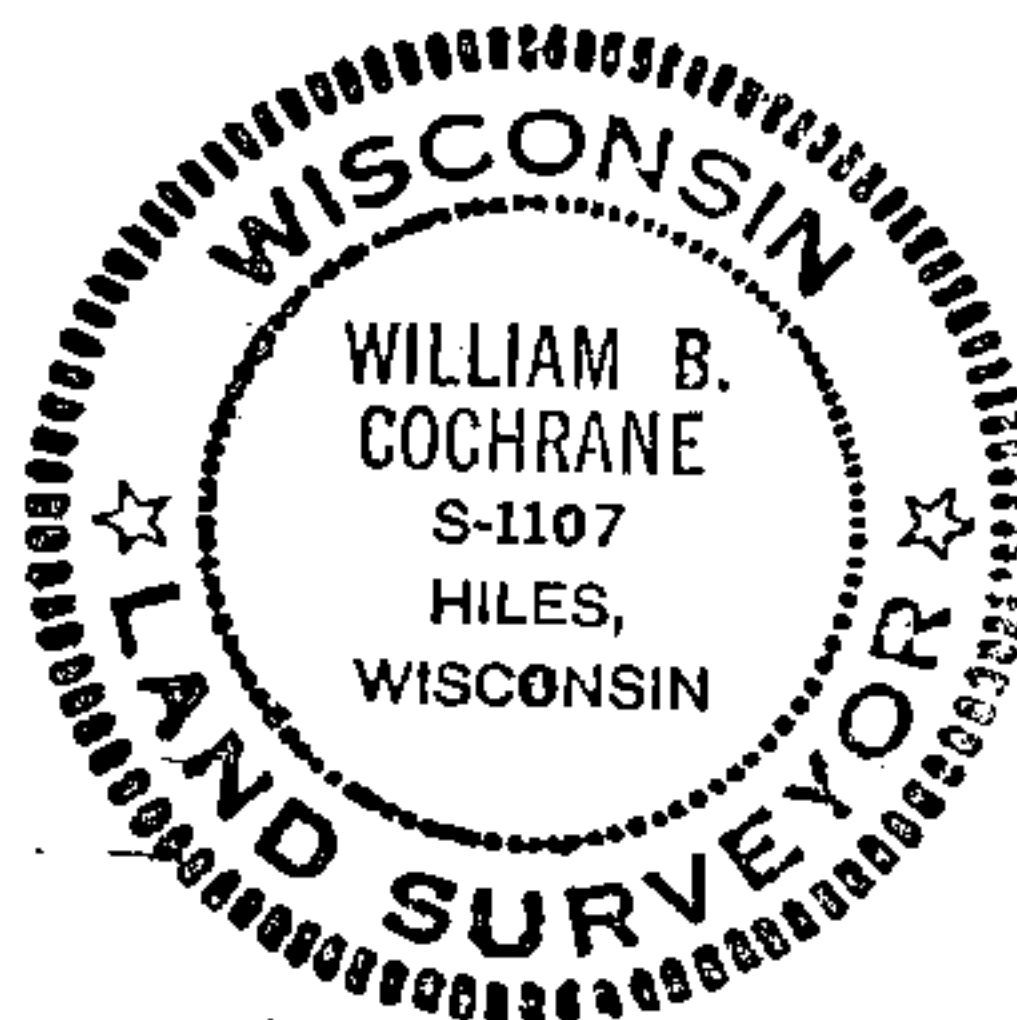

● - Corner monument restored  
□ -

Resident witnesses

Dated at Hiles Wisconsin, this 21st day of July 1982.

Signature William B. Cochrane Title Land Surveyor  
(County Surveyor, Registered Land Surveyor, or other duly authorized official)

Surveyors Registration No. S-1107

Office of Register of Deeds County of Forest

I hereby certify that the within instrument was filed in this office for record on the 10th day of October 1983, and was filed in Book No. Page No. of County Records.

Signature Eugene Staszewski Title Register of Deeds

Township 40 North, Range 13 East, Section 20, Index No. R-5, Page No.

4401319 0000

R  
5