

U.S. PUBLIC LAND SURVEY MONUMENT RECORD

Index No. N-17

State of Wisconsin }
County of Forest ss.

I William B. Cochrane, do hereby certify that on the 31st day of March, 1987, I found evidence of the Northeast Section corner of Section 22 Township 40 North, Range 14 East, Fourth Principal Meridian, as described hereon; and that from this evidence I established a new monument and accessories as described hereon to perpetuate the original location of this corner.

Resident witnesses:

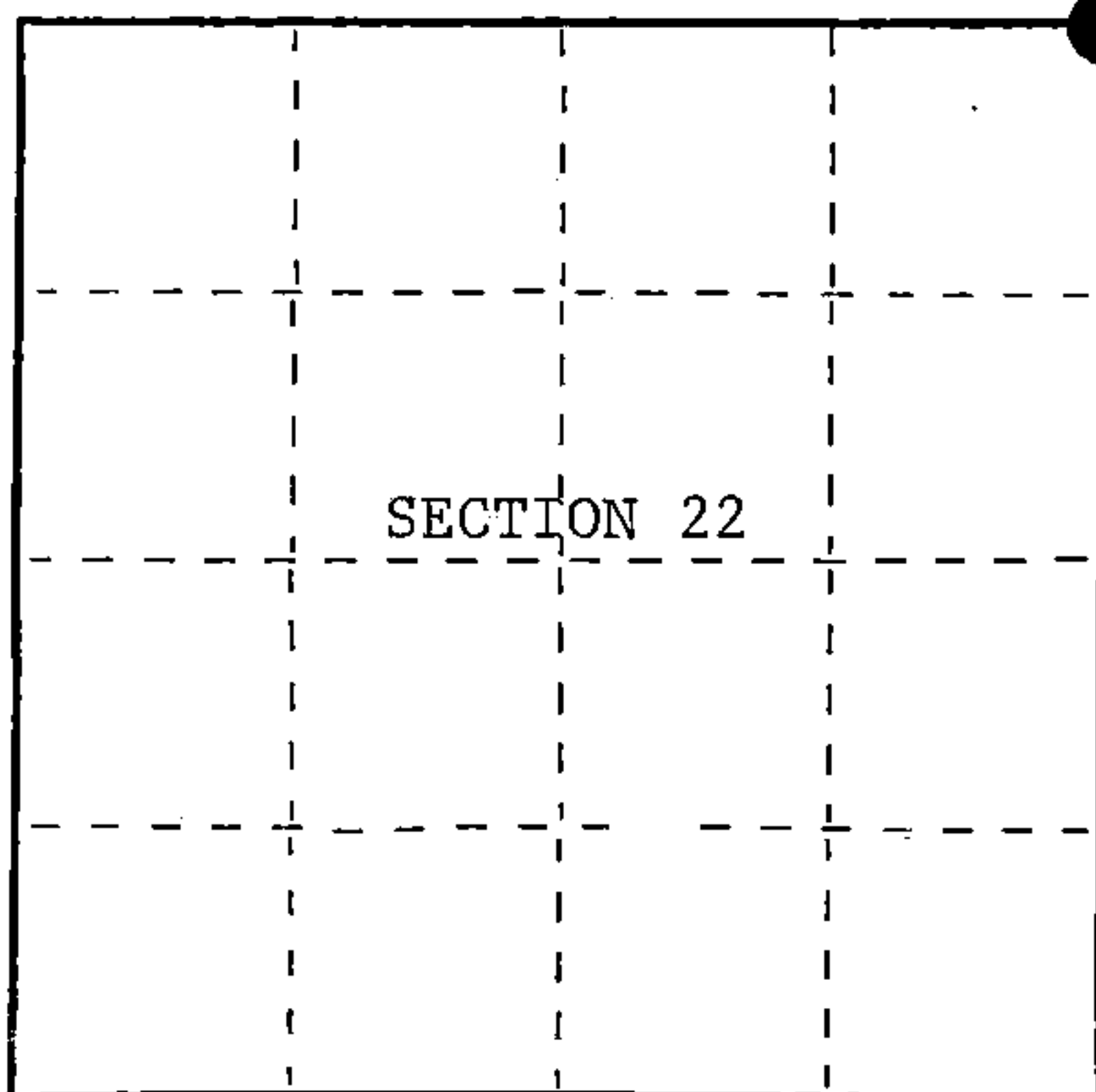

○ = Corner monument restored.

History of original corner establishment:

Original Government Survey in 1865 by William E. Daugherty. Dependent Resurvey in 1944-1950 by Hugh B. Crawford. West between Sections 14 and 23, at 79.08 chains, set a concrete monument, 12 inches long, 6 inches in diameter, 20 inches in the ground, with no marks. At a point South 0.4 chains, set a Witness Corner, which is a concrete monument, 24 inches long, 6 inches in diameter, 18 inches in the ground, with a brass cap stamped; W.C., S15, S14, S22, S23, 1945. From which the following bear;

Poplar	5"	N27°45'E	191 lks.
Cherry	5"	S25°15'E	84 lks.
Cherry	6"	S 4°45'W	115 lks.

Description of corner evidence found:

Found Witness Corner monument as described and in place, from which the following bear;

Cherry	12"	S25°15'E	55.44 feet
Cherry	12"	S 4°45'W	75.90 feet
Wood Sign Post		SW	1.50 feet

Description of monument and accessories I established to perpetuate the original location of this corner.

None

Dated at Hiles, Wis., this 14th day of April, 1987

Signature William B. Cochrane Title Land Surveyor Registration No. S-1107
(County Surveyor, Registered Land Surveyor, or other duly authorized official)

Office of Register of Deeds, County of Forest, I hereby certify that the within instrument was filed in this office for record on the 18th day of March, 1988 at 12:50 o'clock P. M.

Paul Aschenbrenner
(Register of Deeds)

By Deputy

FORM NO. 985-A

HCMiller Company

Stock No. 26273

DOCUMENT NUMBER 134853

44014150000

(e) Describe any material discrepancy between the location of the corner as restored or reestablished and the location of that corner as previously restored or reestablished by distance and direction. Show the discrepancy on the plan view drawing under (d), above. Show the distances between the corner as previously restored or reestablished and (1) the corner as restored or reestablished, and (2) to at least 2 of the witness monuments shown on the drawing in (d), above.

See drawing below.

(f) Was the corner restored through acceptance of (1) an obliterated evidence location, or, (2) a found perpetuated location?

Restored through acceptance of a found perpetuated location.

(g&h) Was the corner reestablished through lost corner proportionate methods? If so, show the method, including the directions and distances to other public land survey corners used as evidence or used for proportioning in determining the corner location?

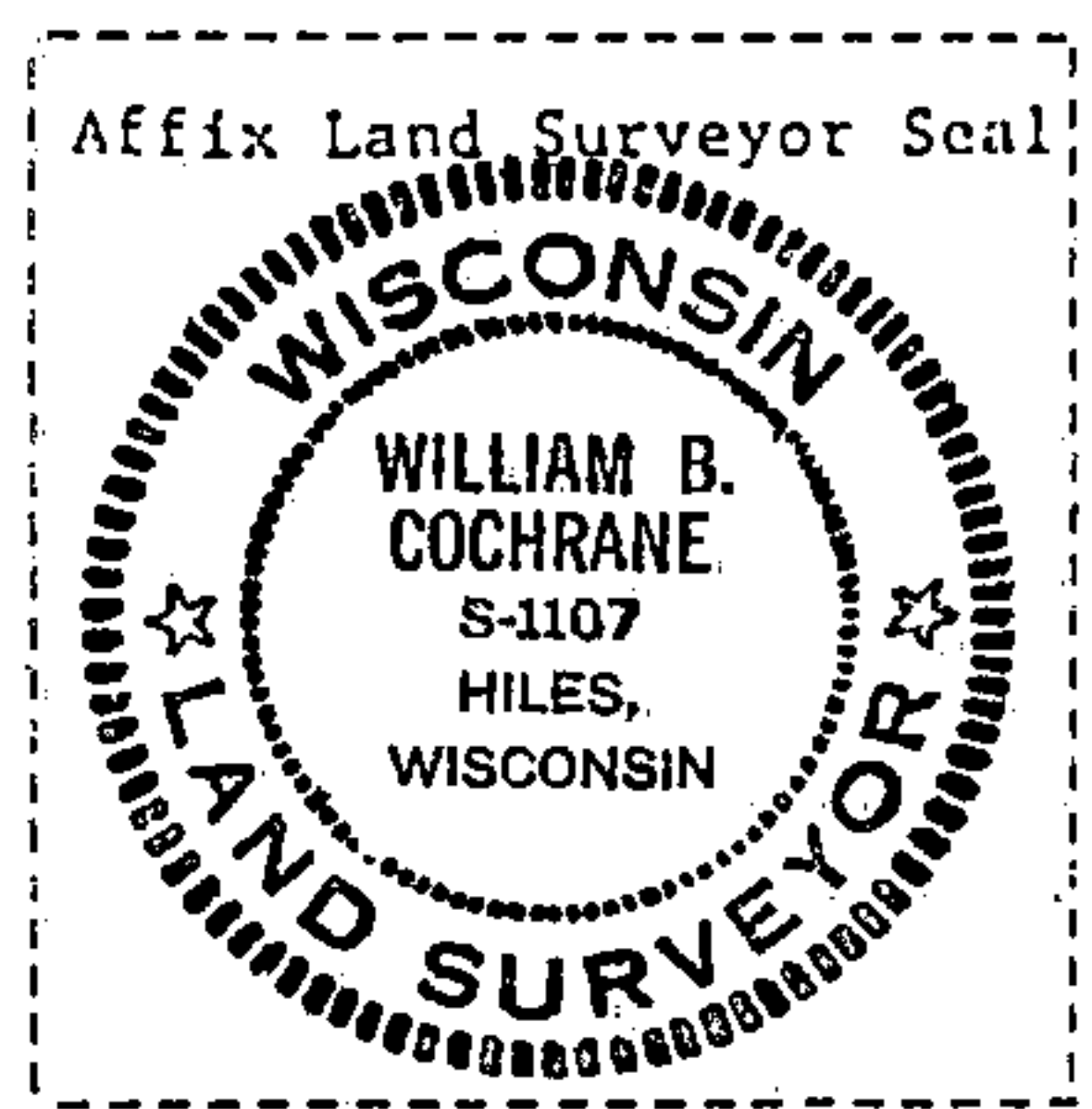
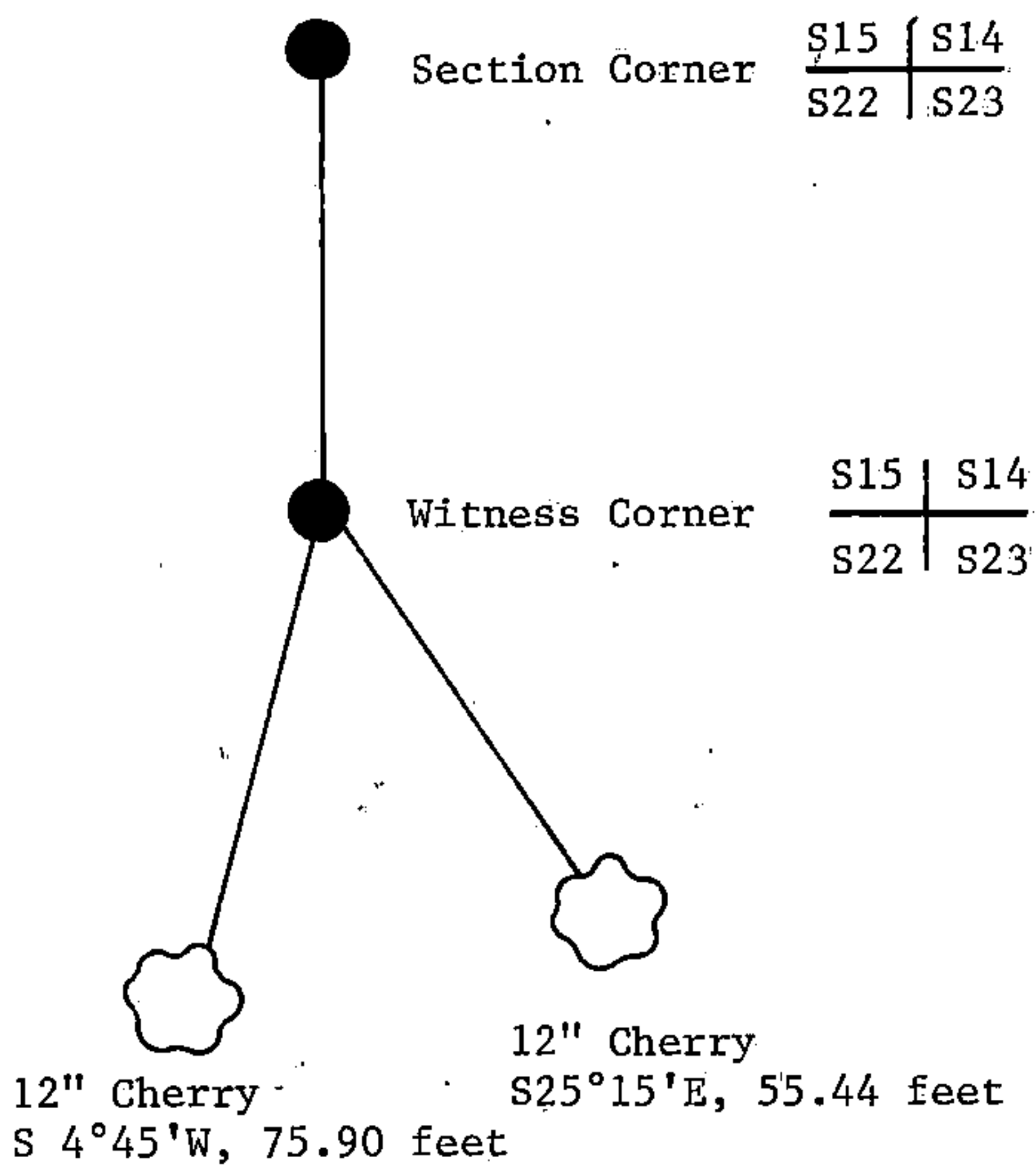

(i) I, William B. Cochrane
(type or print name) certify that the corner location shown on this record was determined by me or under my direction and control and that this U.S. Public Land Survey Monument Record is correct and complete to the best of my knowledge and belief.

William B. Cochrane Jan. 12 1988
Signature Date

Survey requested by, Edward [Signature] 3-8-88

District Ranger Date

U.S. PUBLIC LAND SURVEY MONUMENT RECORD

Index No. N-17

State of Wisconsin

County of Forest } ss.

I, Gary L. Pisoni, do hereby certify that on the 9th day of September, 1989, I found evidence of the Southeast Section corner of Section 15 Township 40, North, Range 14 East, Fourth Principal Meridian, as described hereon; and that from this evidence I established a new monument and accessories as described hereon to perpetuate the original location of this corner.

Resident witnesses:

.....

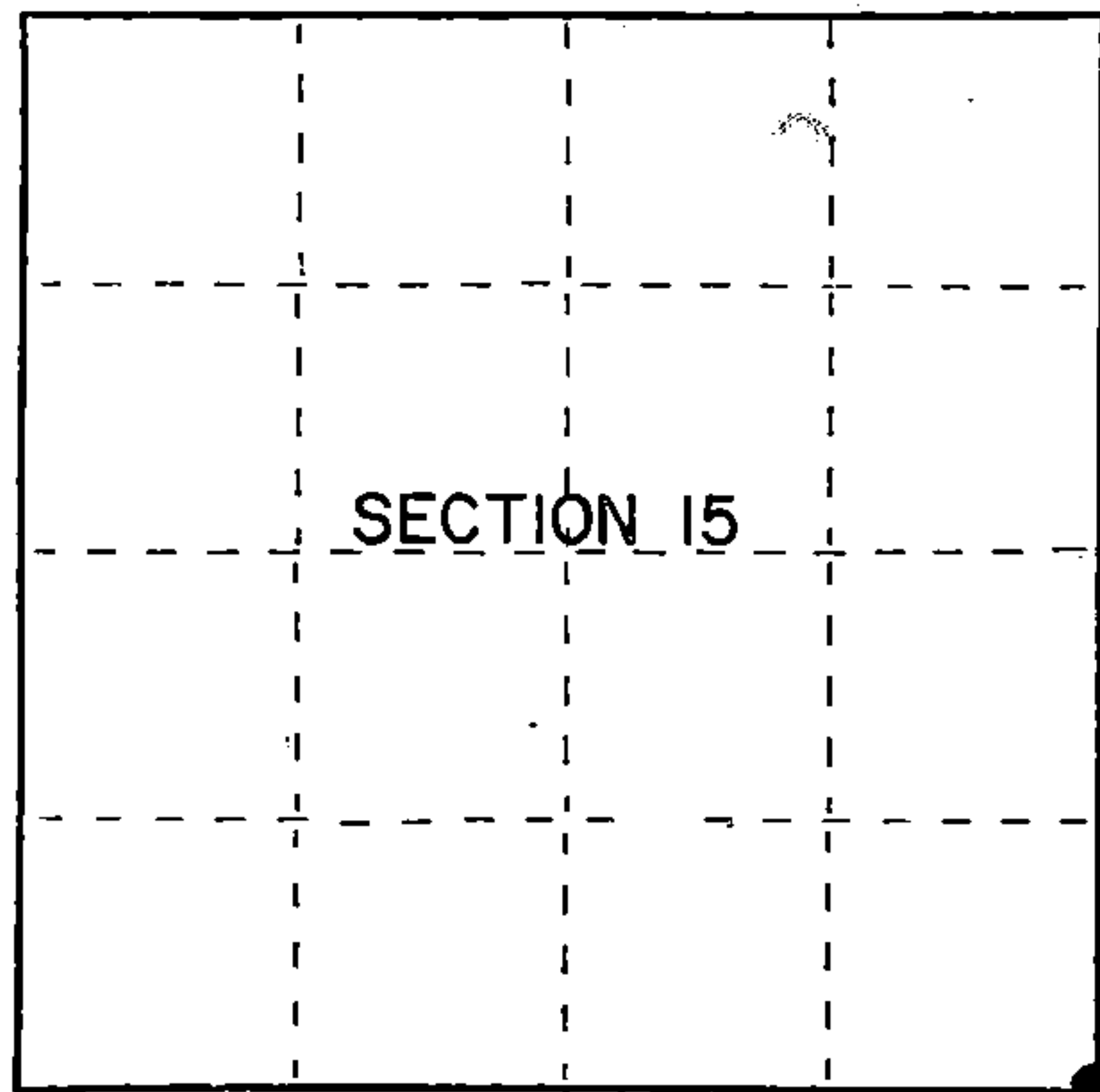

● = Corner monument restored.

History of original corner establishment:

Dependent Resurvey in 1945 by Hugh B. Crawford. N.00°09'E. between Sections 22 and 23, at 71.60 chains, set Witness Corner which is a 6" diameter concrete monument, 24 inches long, with an iron post in center and a brass cap mkd; WC, T40N, R14E, S14, S15, S22, S23, 1945. From which the following bear;

Poplar	5"	N.27°45'E.	191 links
Cherry	5"	S.25°15'E.	84 links
Cherry	6"	S.04°45'W.	115 links

At 72.00 chains, the point for Section Corner is determined at the intersection of gravelled roads. At the corner point Set a 6" dia. concrete monument, 12" long

Description of corner evidence found: 20" in the ground.

No evidence found of concrete monument marking section corner position. At the road intersection found a 1" diameter iron pipe marking the corner position, from which a WC concrete monument bears

Found the Witness Corner monument as described from which the following bear;

Cherry	12"	S.25°15'E.	55.44 feet
Cherry	12"	S.04°45'W.	75.90 feet
Wood Sign Post		SW	1.50 feet

No corner references were ever set for the actual section corner.

Description of monument and accessories I established to perpetuate the original location of this corner.

In place of iron pipe, set a 2½ inch diameter aluminum pipe monument, 3 feet long, 8 inches below the road surface in the C/L of gravel road, with an aluminum cap stamped; T40N, R14E, S14, S15, S22, S23, 1989, S-1634. From which the following new blazed and scribed bearing trees bear (all measurements taken to a nail in side of tree)-

Red Pine	9"	N.62°W.	84.98 feet
Black Cherry	12"	S.16°E.	79.51 feet
Witness Corner Monument		S00°09'W	26.40 feet
Black Cherry	12"	S.04°W.	102.24 feet

Dated at Iron River, MI, ~~xxxx~~ this 2nd day of November, 1989Signature Gary L. Pisoni Title Land Surveyor Registration No. S-1634
(County Surveyor, Registered Land Surveyor, or other duly authorized official)

Office of Register of Deeds, County of Forest, I hereby certify that the within instrument was filed in this office for record on the 20th day of September, 1990 at 10:45 o'clock A M.

(Register of Deeds)

By Paul Chitto Deputy

FORM NO. 985-A

H.C. Miller Company
Madison, Wisconsin

Stock No. 26273

DOCUMENT NUMBER

140477

44014150000

- e) Describe any material discrepancy between the location of the corner as restored or reestablished and the location of that corner as previously restored or reestablished by distance and direction. Show the discrepancy on the plan view drawing under (d), above. Show the distances between the corner as previously restored or reestablished and (1) the corner as restored or reestablished, and (2) to at least 2 of the witness monuments shown on the drawing in (d), above.

See drawing below.

- (f) Was the corner restored through acceptance of (1) an obliterated evidence location, or, (2) a found perpetuated location?

Restored through acceptance of a found perpetuated location.

- (g&h) Was the corner reestablished through lost corner proportionate methods? If so, show the method, including the directions and distances to other public land survey corners used as evidence or used for proportioning in determining the corner location?

9" Red Pine(NBT)
N.62°W., 84.98 feet

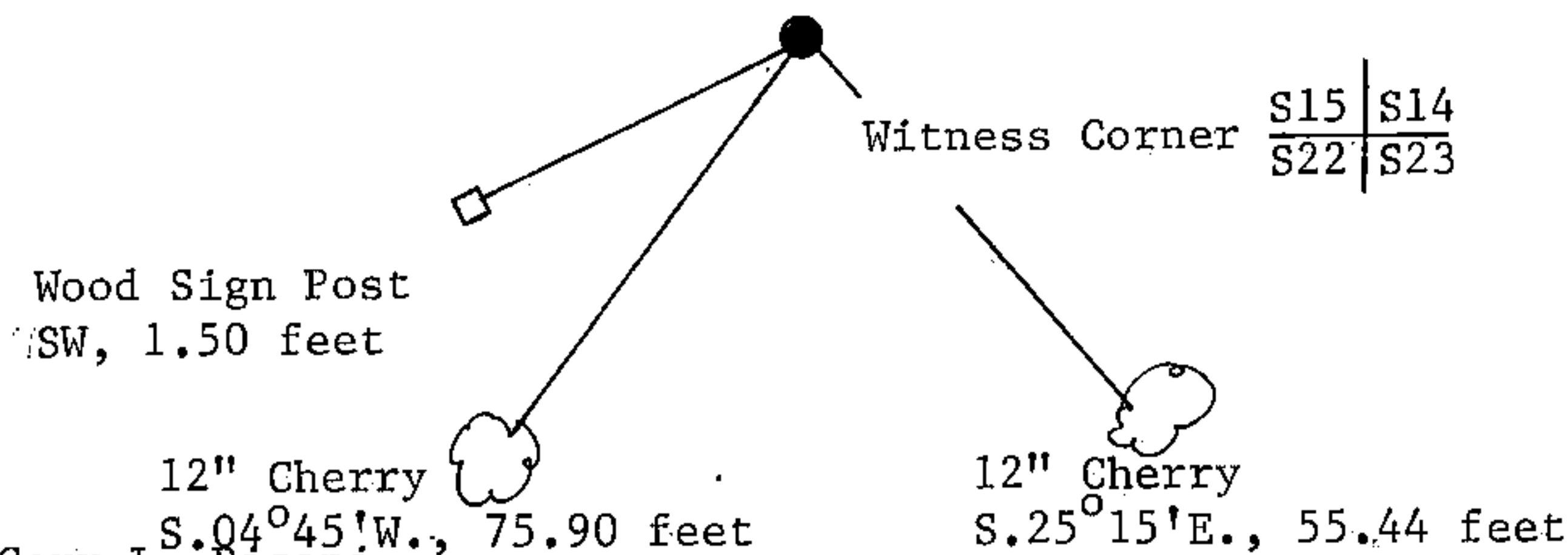
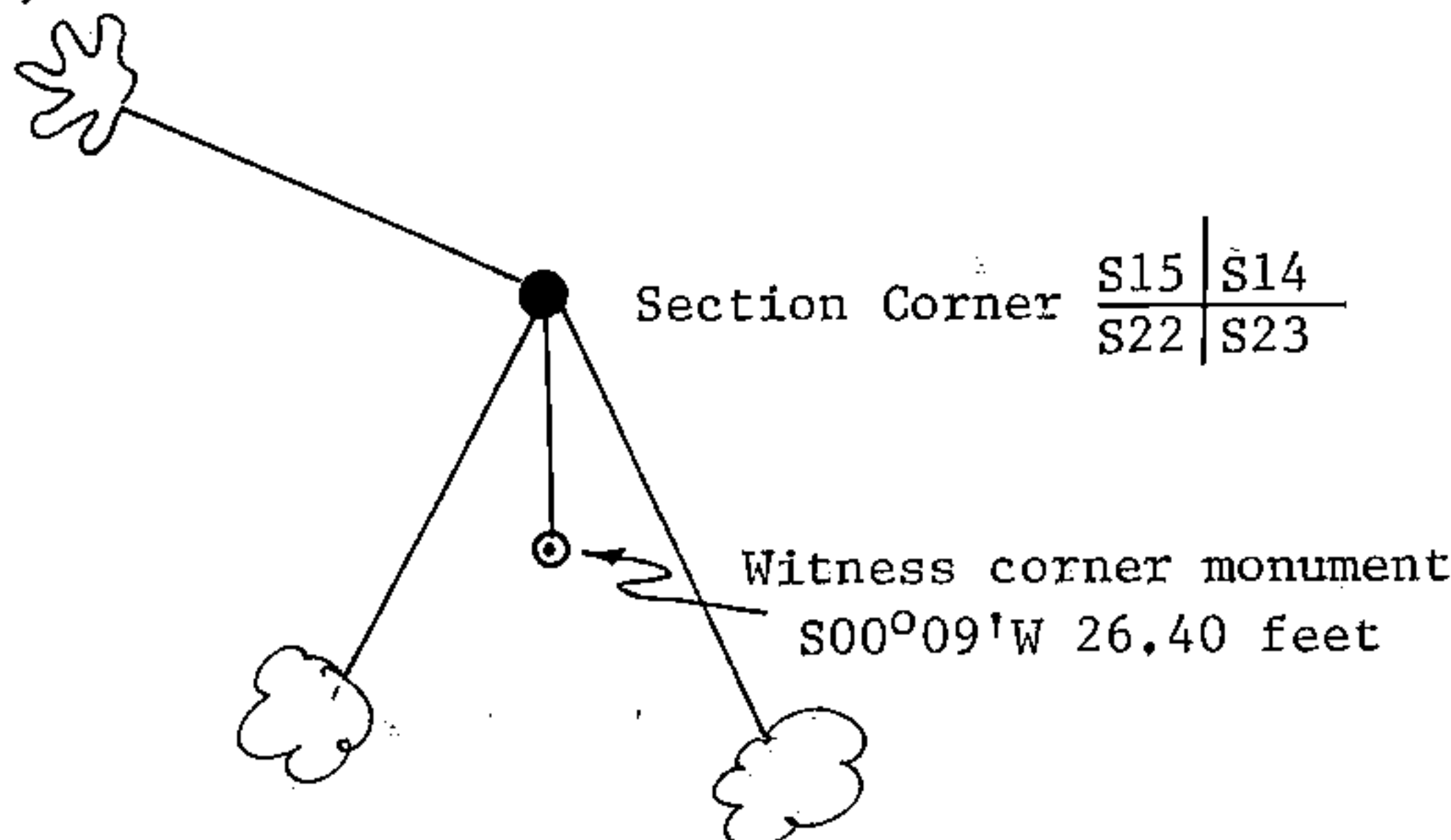

- (i) I, Gary L. Pisoni (type or print name) certify that the corner location shown on this record was determined by me or under my direction and control and that this U.S. Public Land Survey Monument Record is correct and complete to the best of my knowledge and belief.

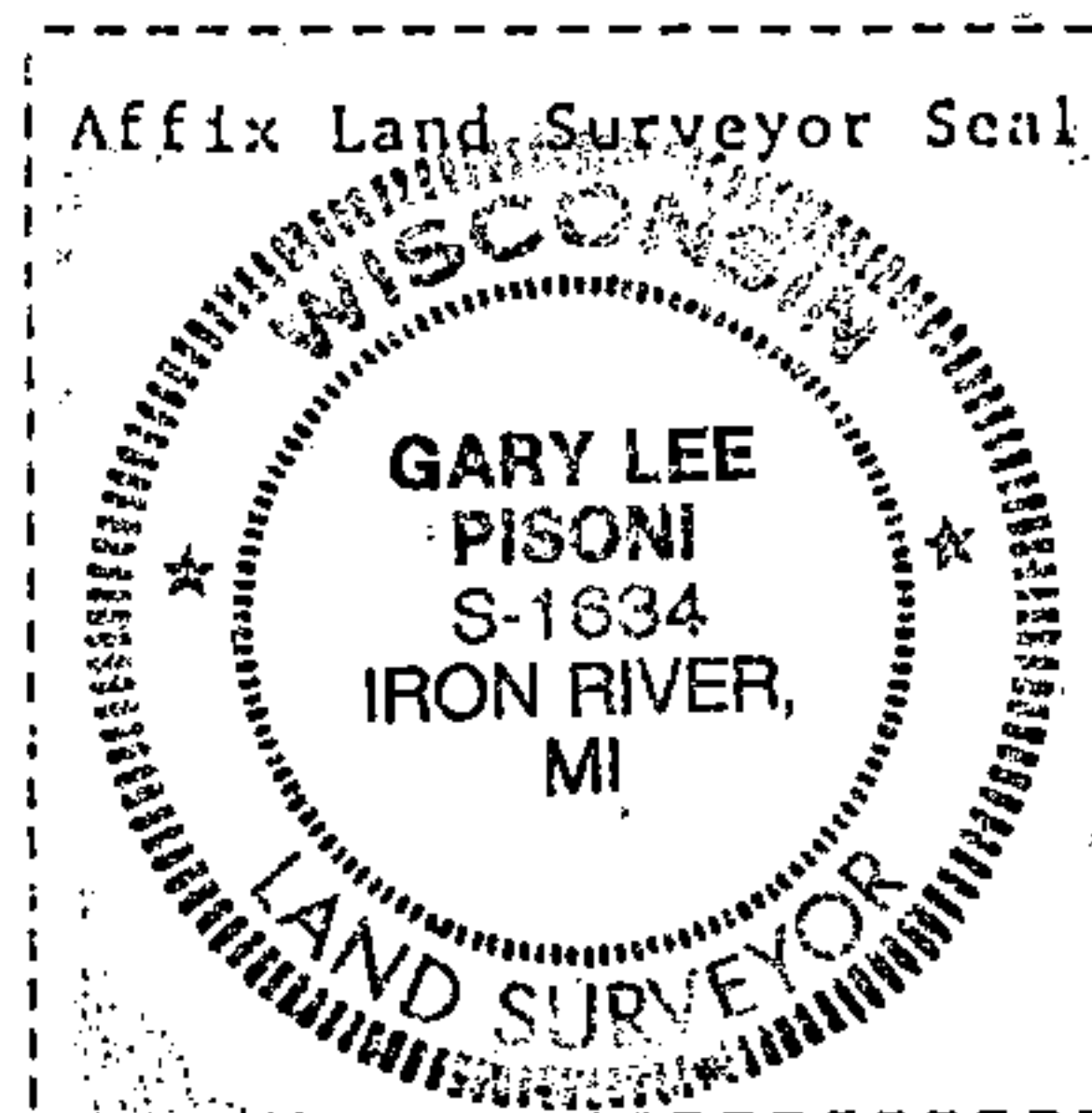

Signature Gary L. Pisoni Date Jan 12 1990

Survey requested by: [Signature] District Ranger Date 1-18-90