

CERTIFIED LAND CORNER RESTORATION

State of Wisconsin

County of Forest

ss.

I Jean F. Resvick, do hereby certify that on the 27th day of June, 1969, I found evidence of the Southwest Section corner of Section 15 Township 40 North, Range 14 East, Fourth Principal Meridian, as described hereon; and that from this evidence I established a new monument and accessories as described hereon to perpetuate the original location of this corner:

Description of original monument and accessories and subsequent restorations:

Surveyed in 1865 by Wm. E. Daugherty. Dependent resurvey 1950 by Hugh B. Crawford. From remains of original hemlock stump set an iron post, 30 inches long, 2 1/2 inches diameter, 26 inches in the ground, with brass cap marked.

T40N R14E

S16 | S15

S21 | S22

1950

From which

Poplar 5, bears N80°45'E, 19 lks.

Poplar 4, bears S40°15'E, 28 lks.

Cedar 7, bears S43°30'W, 111 lks.

Poplar 4, bears N55°30'W, 27 lks.

Description of corner evidence found:
Monument found as described above.
Poplar 9", N80°45'E, 12.5 ft.
Poplar snag 6", S40°E, 18.5 ft.
Cedar 11, S43°30'W, 73.3 ft.
Poplar 9, N55°30'W, 17.8 ft.

Description of ~~monument~~ and accessories I established to perpetuate the original location of this corner:

Blazed and scribed the following new bearing trees.

White spruce 5, N71E, 13.42 ft.

White birch 7, S65E, 17.20 ft.

Black spruce 4, N67W, 18.75 ft.

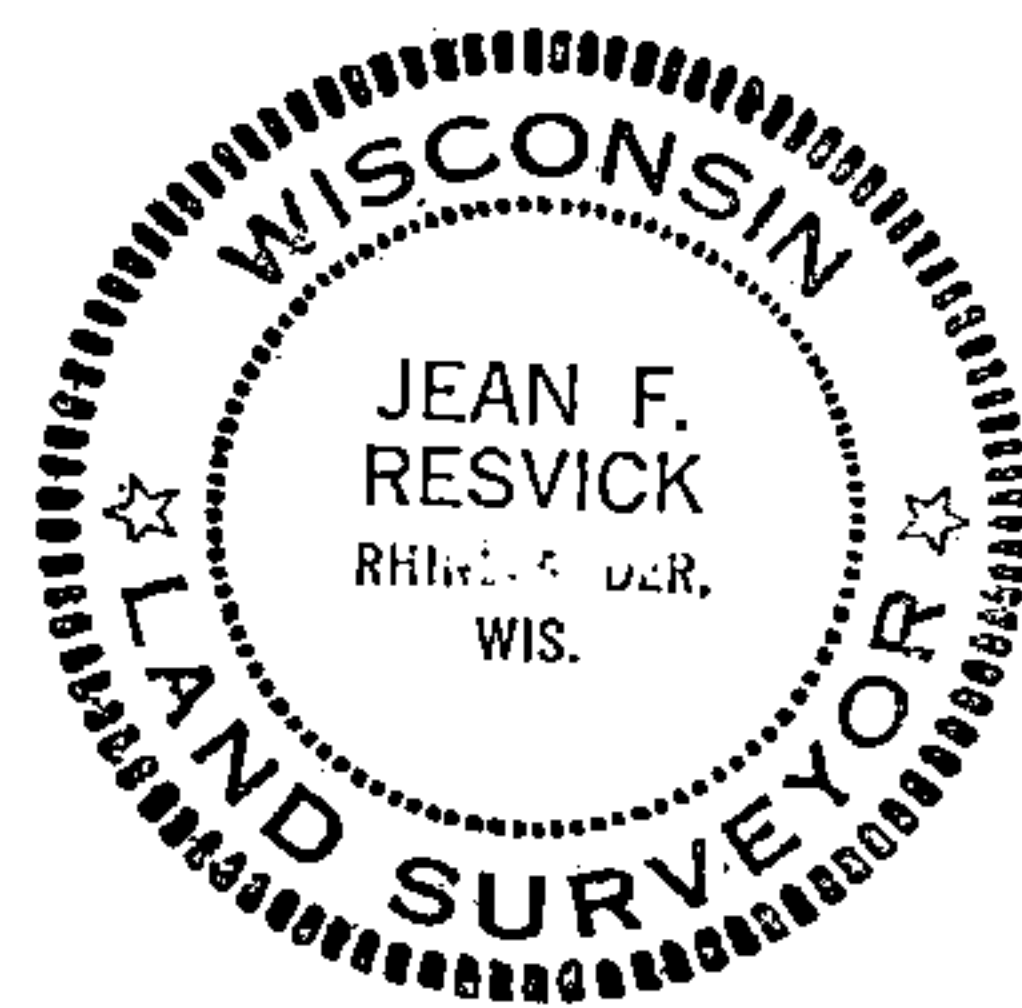

44014160000

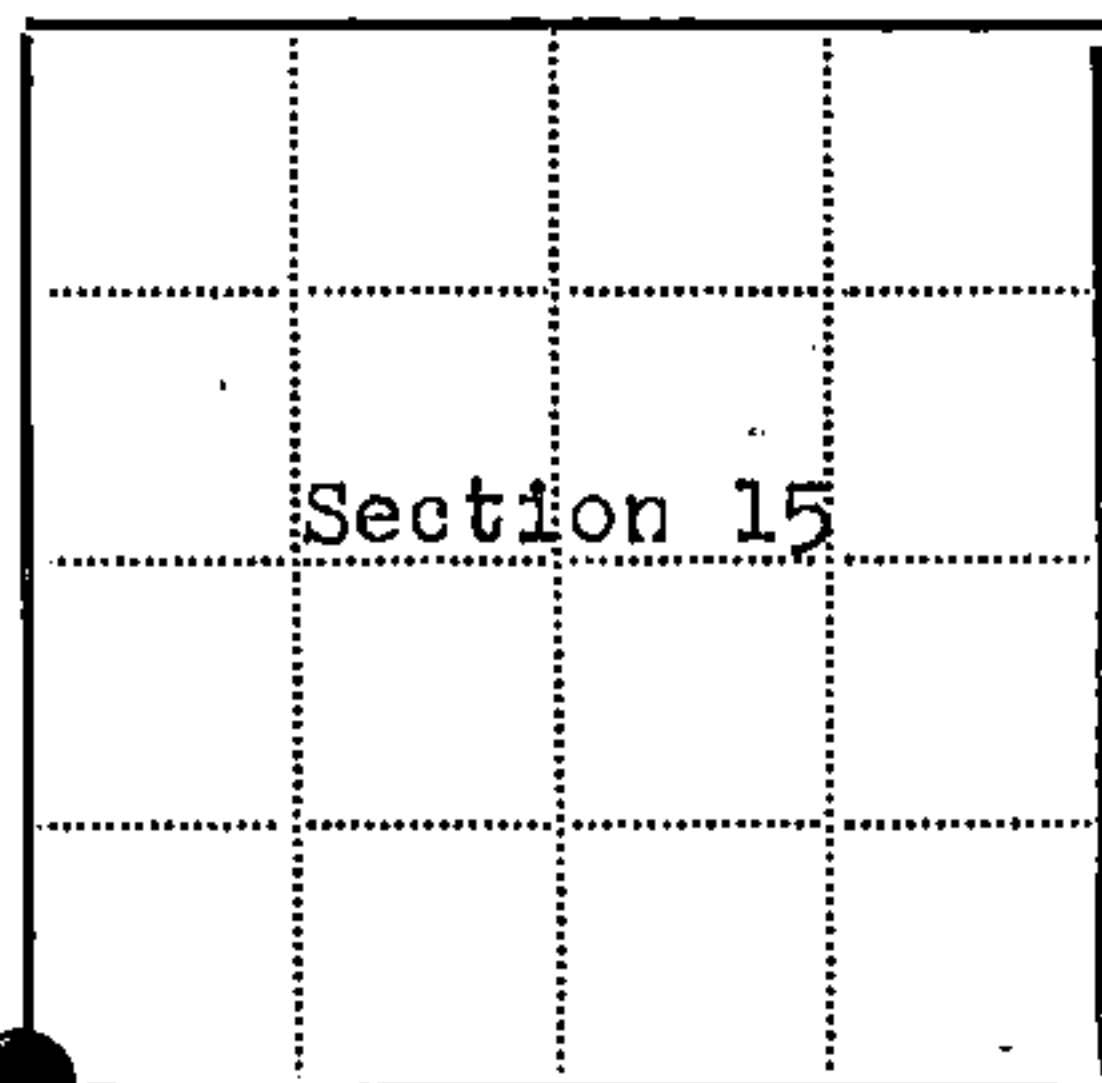

⊙ = Corner monument restored

□ =

Resident witnesses.....

Dated at Rhineland Wisconsin, this 16th day of April, 1970.

Signature Jean F. Resvick Title Cadastral Surveyor
(County Surveyor, Registered Land Surveyor, or other duly authorized official)

Surveyors Registration No. S-802 DOCUMENT No. 98069

Office of Register of Deeds County of Forest

I hereby certify that the within instrument was filed in this office for record on the 22nd day of May, 1970, and was filed in Book No. N-13 Page No. N-13 of County Records.

Signature Eugene Staszny Title Register of Deeds

Township 40 North, Range 14 East, Section 15, Index No. N-13, Page No. N-13

N13

U.S. PUBLIC LAND SURVEY MONUMENT RECORD

Index No. N-13

State of Wisconsin }
County of Forest } ss.

I, Gary L. Pisoni, do hereby
certify that on the 24th day
of June, 1986, I found
evidence of the Northeast
corner of Section 21
Township 40, North, Range
14E, Fourth Principal Meridian,
as described hereon; and that from this evidence
I established a new monument and accessories
as described hereon to perpetuate the original
location of this corner.

Resident witnesses:

Kyle Erickson

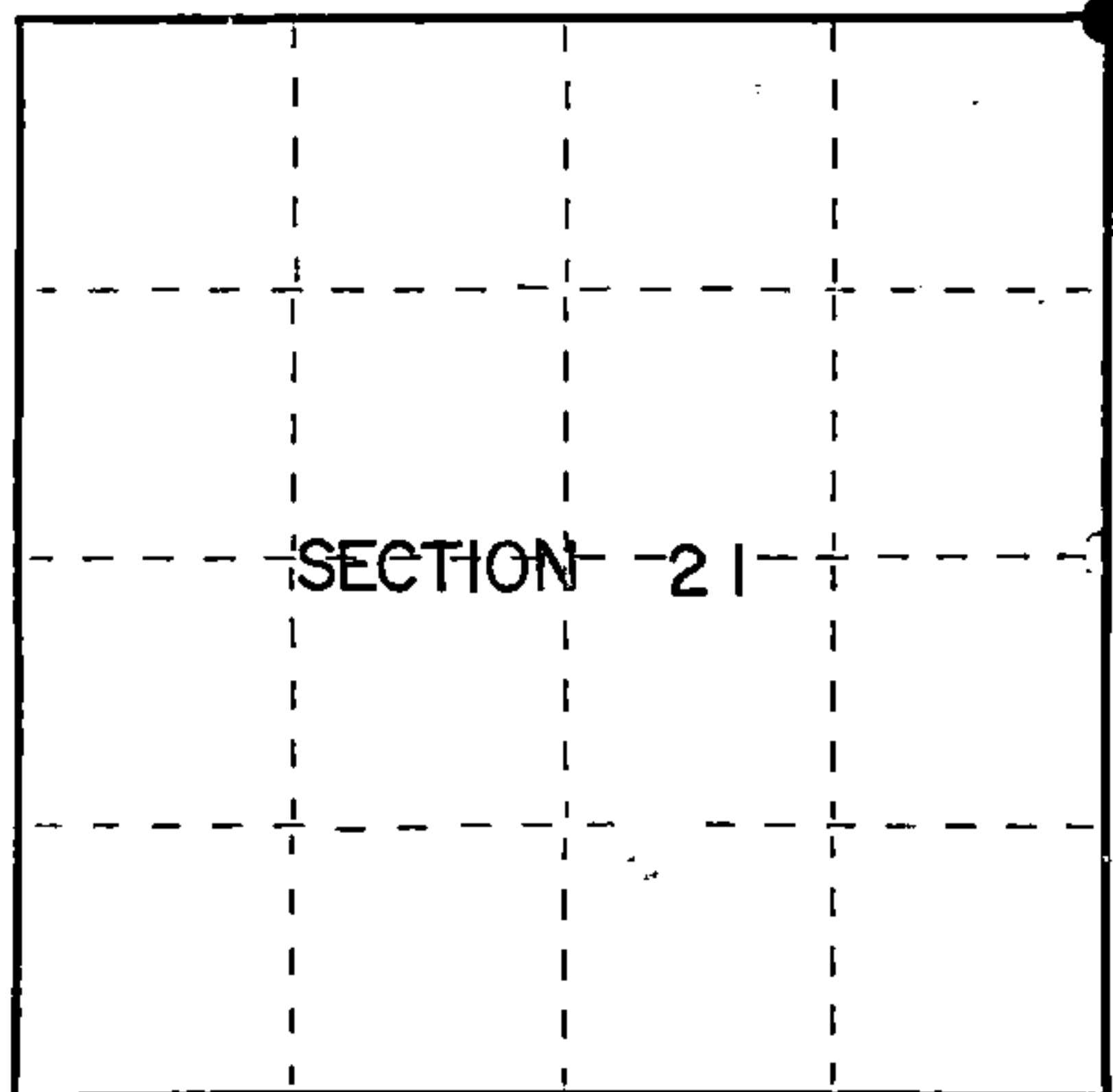

○ = Corner monument restored.

History of original corner establishment:

Original Government Survey in 1865 by Wm. E. Daugherty. Dependent resurvey 1950 by Hugh B. Crawford. Corner restored from remains of original hemlock stump. On 6/27/69, Jean Resvick, a land surveyor with the U.S. Forest Service found a 2½" diameter by 30" long iron pipe with a brass cap stamped and set by H. B. Crawford: T40N, R14E, S15, S16, S21, S22, 1950, B.L.M. from which the following bear:

Poplar	9"	N.80°45'E.	12.5 feet	White Spruce	5"	N.71°E.	13.42 feet
Cedar	11"	S.43°30'W.	73.3 feet	White Birch	7"	S.65°E.	17.20 feet
Poplar	9"	N.55°30'W.	17.8 feet	Black Spruce	4"	N.67°W.	18.75 feet

Description of corner evidence found:

Monument as described and in place, from which the following bear:

Black Spruce	4"	N.67°W.	19.10 feet
Poplar	14"	N.55°30'W.	17.80 feet
White Spruce	6"	N.71°E.	13.42 feet
White Birch	8"	S.65°E.	17.20 feet
Cedar	13"	S.43°30'W.	73.30 feet (distance to front of knotch)

Description of monument and accessories I established to perpetuate the original location of this corner.

Set a steel sign post: North, 1.3 feet

Dated at Iron River, MI, Wis, this 2nd day of November, 1987.

Signature Gary L. Pisoni Title Land Surveyor Registration No. S-1634
(County Surveyor, Registered Land Surveyor, or other duly authorized official)

Office of Register of Deeds, County of Forest, I hereby certify that the within
instrument was filed in this office for record on the 18th day of March, 1988
at 12:50 o'clock P. M.

Paul Aschenbrenner
(Register of Deeds)

By _____ Deputy

44014160000

(e) Describe any material discrepancy between the location of the corner as restored or reestablished and the location of that corner as previously restored or reestablished by distance and direction. Show the discrepancy on the plan view drawing under (d), above. Show the distances between the corner as previously restored or reestablished and (1) the corner as restored or reestablished, and (2) to at least 2 of the witness monuments shown on the drawing in (d), above.

See drawing below

(f) Was the corner restored through acceptance of (1) an obliterated evidence location, or, (2) a found perpetuated location?

Restored through acceptance of a found perpetuated location.

(g&h) Was the corner reestablished through lost corner proportionate methods? If so, show the method, including the directions and distances to other public land survey corners used as evidence or used for proportioning in determining the corner location?

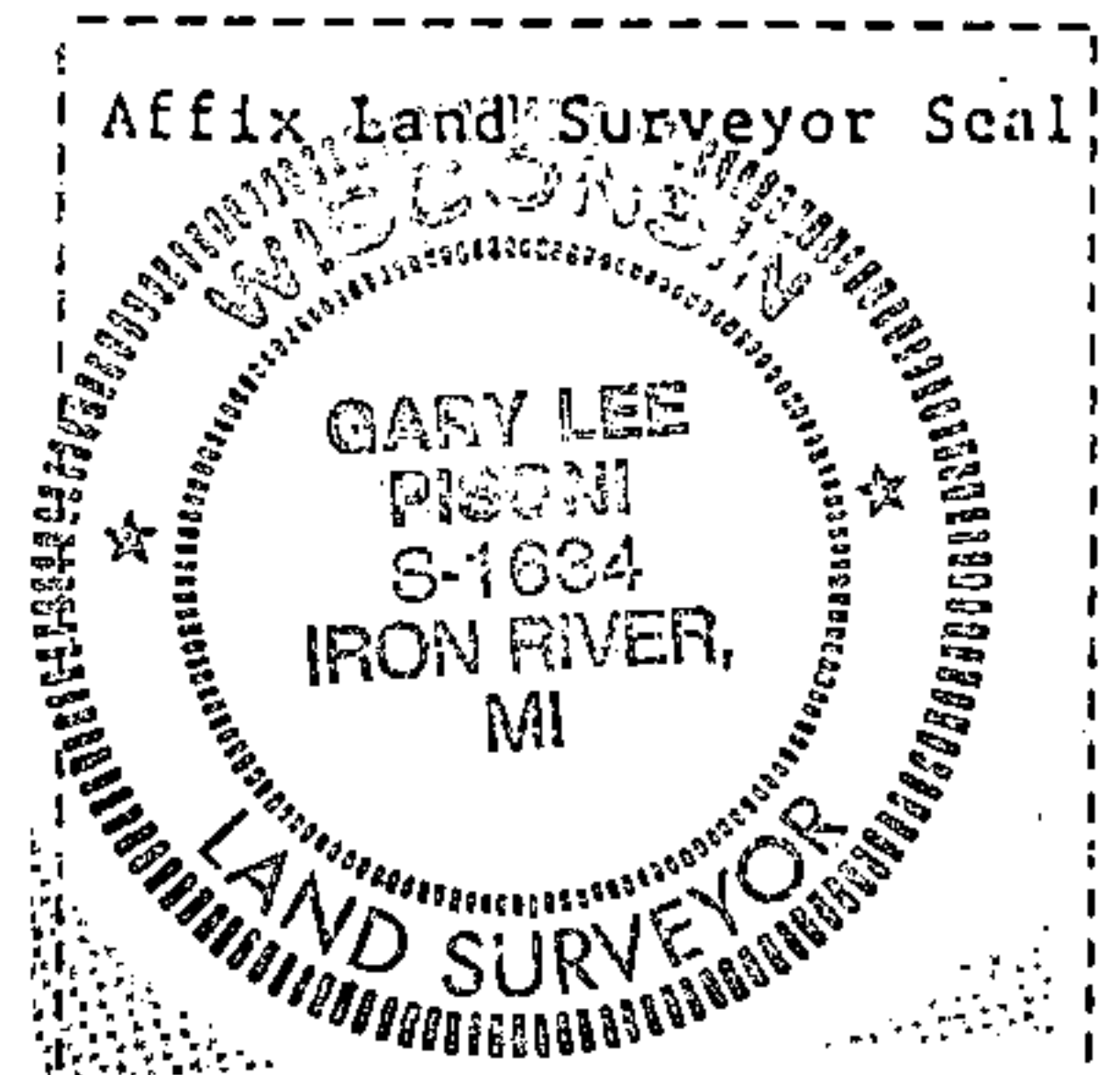
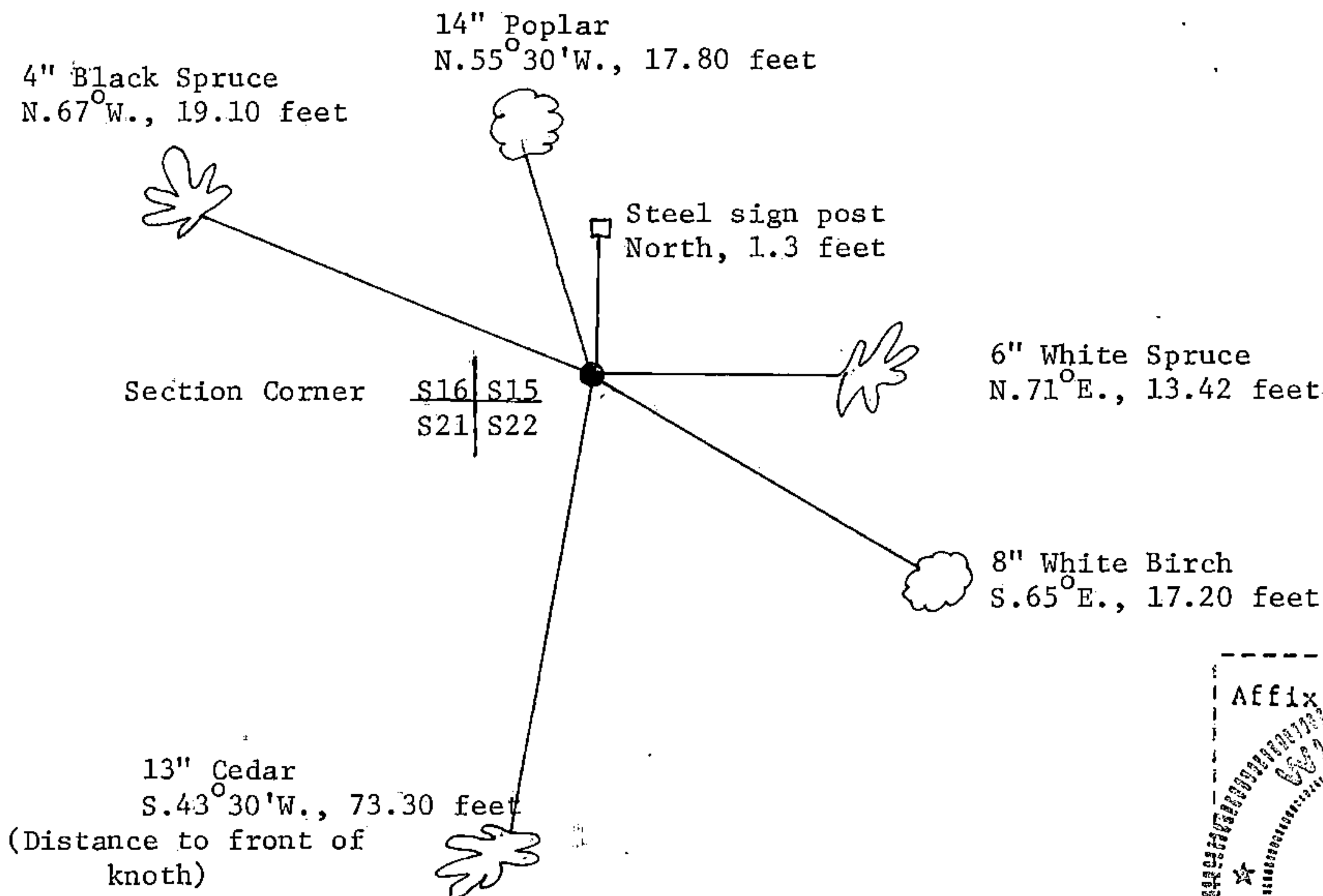

(i) I, Gary L. Pisoni
(type or print name) certify that the corner location shown on this record was determined by me or under my direction and control and that this U.S. Public Land Survey Monument Record is correct and complete to the best of my knowledge and belief.

Signature Gary L. Pisoni Date 11-2-87

Survey requested by: Edward [Signature] Date 3-7-88
District Ranger