

CERTIFIED LAND CORNER RESTORATION

State of Wisconsin }  
County of Forest } ss.

I William B. Cochrane, do hereby certify that on the 26th day of September, 1974, I found evidence of the East Meander corner of Sections 26 and 35 Township 40 North, Range 14 East, Fourth Principal Meridian, as described hereon; and that from this evidence I established a new monument and accessories as described hereon to perpetuate the original location of this corner:

Description of original monument and accessories and subsequent restorations:

Surveyed in 1865 by W. E. Daugherty  
Dependent Resurvey 1950 by H. B. Crawford  
Set iron post, 30 inches long, 2 1/2 inches diameter with brass cap marked MC, T40N, S26, S35, R14E, 1950.  
Spruce 4, N48E, 22.5 lks  
Spruce 4, S30°15'E, 84 lks

Description of corner evidence found:

Monument as described in place  
Spruce 4, dead and down, N48E, 22.5 lks  
Spruce 4, dead and down, S30E, 84 lks

Description of ~~monument~~ and accessories I established to perpetuate the location of this corner:

Blazed and scribed the following new bearing tree.  
Tamarack 4, S32E, 10.74 feet  
Set steel sign post, south and alongside of monument.

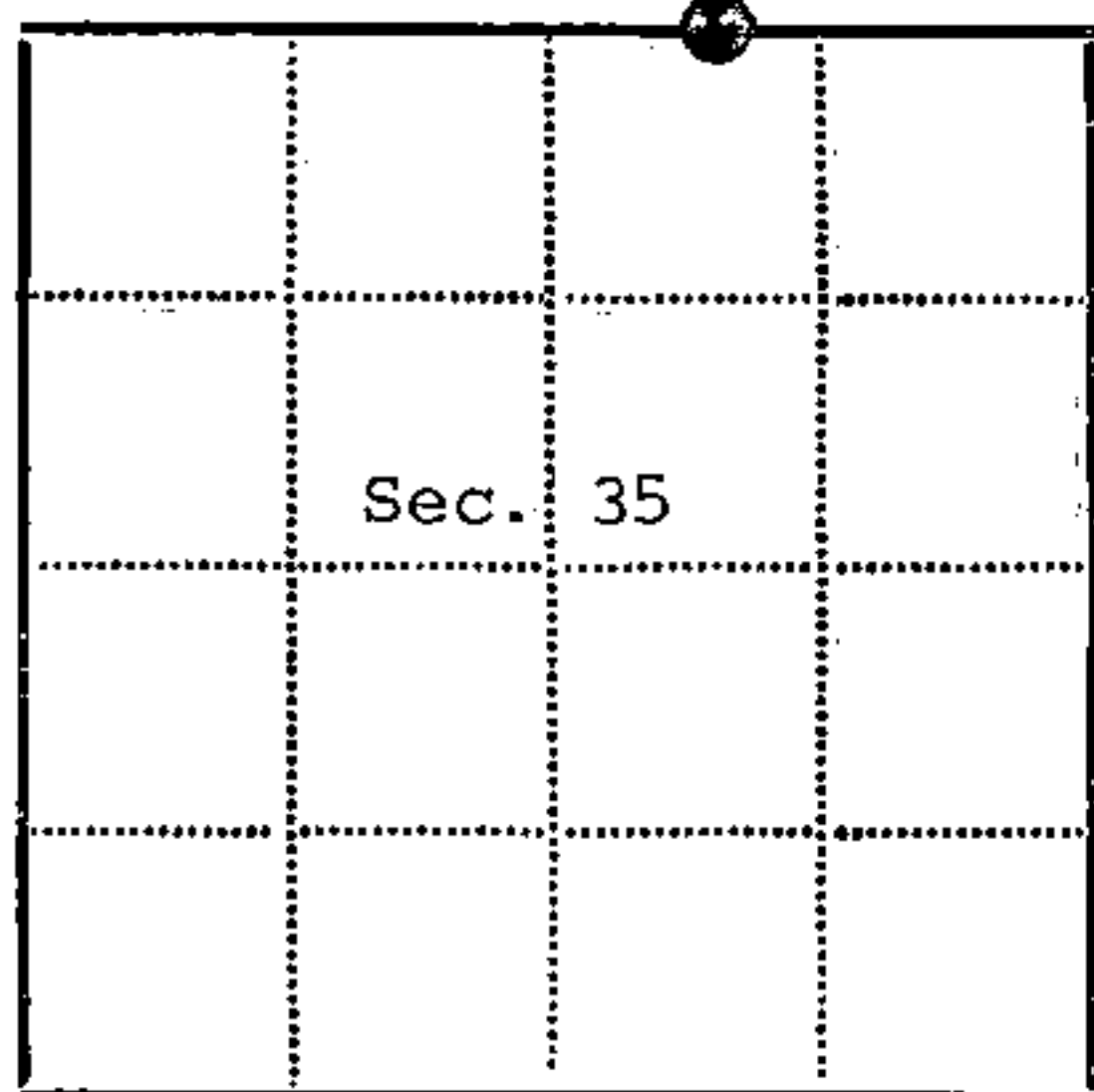
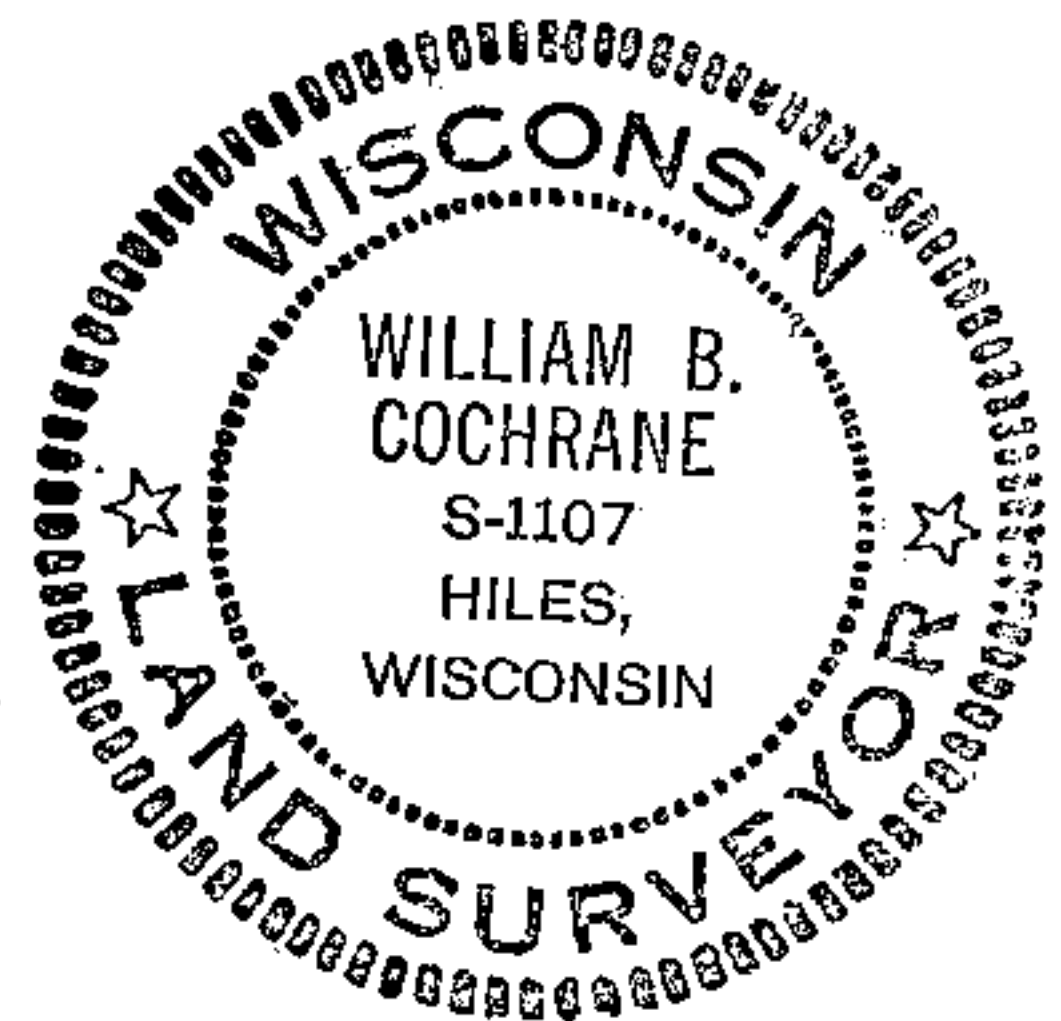

● = Corner monument restored  
□ =

Resident witnesses.....

Dated at Rhinelander Wisconsin, this 16th day of March 1975.

Signature William B. Cochrane Title Survey Technician  
(County Surveyor, Registered Land Surveyor, or other duly authorized official)

Surveyors Registration No. S-1107 Document Number 106892

Office of Register of Deeds County of Forest

I hereby certify that the within instrument was filed in this office for record on the 31st day of March 1975, and was filed in Book No. Corner Restorations Page No. V-19, 20 of County Records.

Signature Eugene Stutzmy Title Register of Deeds

Township 40 North, Range 14 East, Section 35, Index No. V-19, 20, Page No.

44014 260012

V 19  
219