

U.S. PUBLIC LAND SURVEY MONUMENT RECORD

Index No. R-17

State of Wisconsin }
County of FOREST } ss.

I John Schulke, do hereby
certify that on the 15th day
of August, 1985, I found
evidence of the Section
corner of 22, 23, 26 and 27
Township 41, North, Range
13 East, Fourth Principal Meridian,
as described hereon; and that from this evidence
I established a new monument and accessories
as described hereon to perpetuate the original
location of this corner.

Resident witnesses:

History of original corner establishment:

Original corner was established by Wm. E. Daugherty, Deputy Surveyor in
June 1865 in the survey of the subdivision of T41N, R13E.

Original Bearing Trees:	Cedar	12"	N86°E	6 lks.
	Birch	7"	S69°W	22 lks.

Description of corner evidence found:

Found 2" Dia. iron pipe set by Guy Veal in 1942 with a brass cap
stamped to identify the corner.

Recovered 1942 Bearing Trees:

Cedar stump	14"	S20°W	28.05 feet
Cedar snag	12"	N20°W	37.95 feet

Description of monument and accessories I established to perpetuate the original location of this corner.

Blazed and scribed the following new bearing trees:

Balsam	8"	N84°W	36.86 feet
Poplar	9"	S56°W	33.6 feet
Balsam	14"	S10°E	53.75 feet
Poplar	10"	N33°W	30.64 feet

Steel sign post set 1.9 feet West.

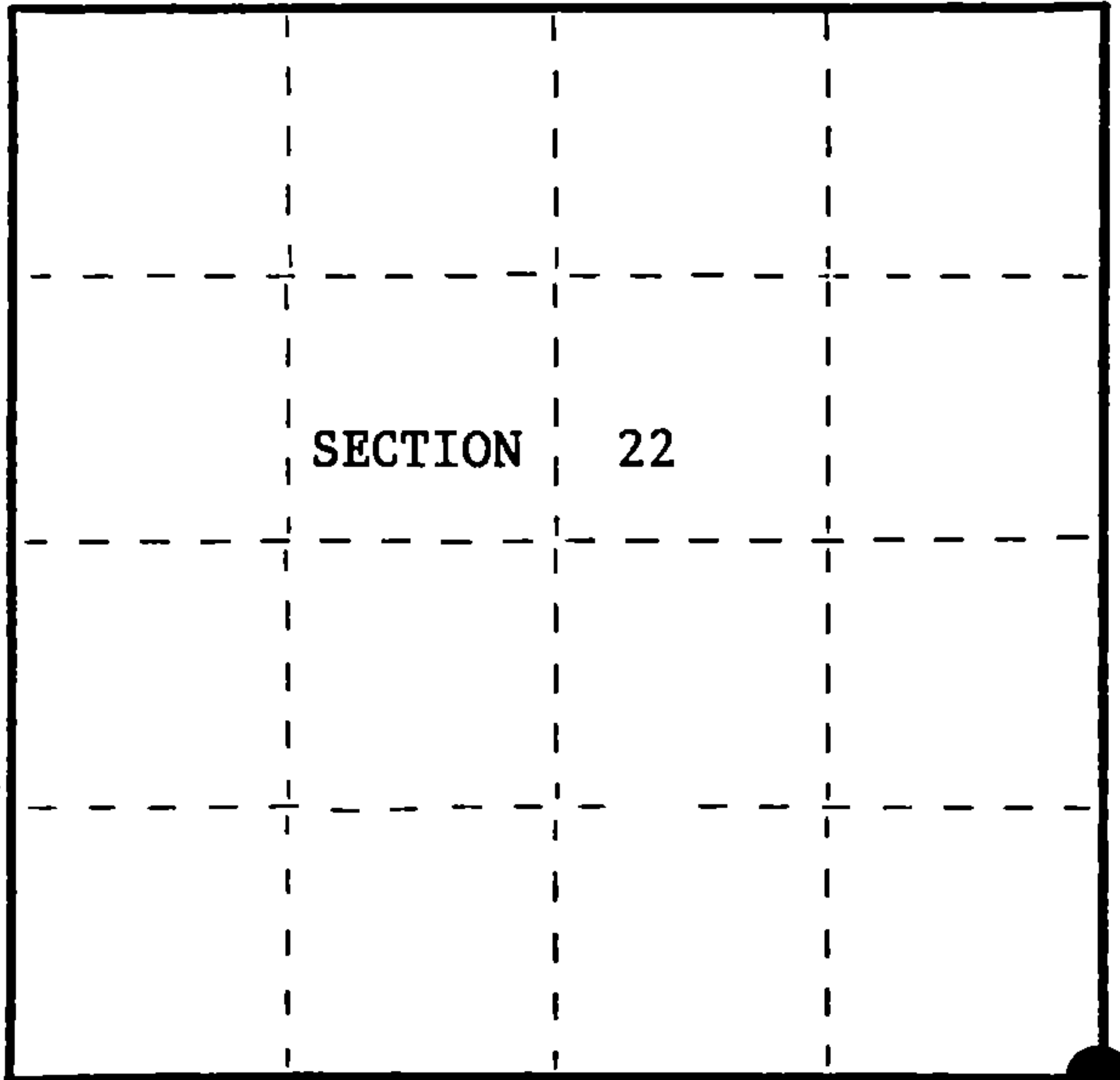

○ = Corner monument restored.

Dated at Crandon, Wis., this 10th day of October, 1985.

Signature John C Schulke Title R.L.S. Registration No. S-1665
(County Surveyor, Registered Land Surveyor, or other duly authorized official)

Office of Register of Deeds, County of Forest, I hereby certify that the within
instrument was filed in this office for record on the 21st day of November, 1985
at 1:10 o'clock P. M.

Paul Aschehenner
(Register of Deeds)

By _____ Deputy

FORM NO. 985-A
H.C. Miller Company

Stock No. 26273
DOCUMENT NUMBER 129282

44113220000

(e) Describe any material discrepancy between the location of the corner as restored or reestablished and the location of that corner as previously restored or reestablished by distance and direction. Show the discrepancy on the plan view drawing under (d), above. Show the distances between the corner as previously restored or reestablished and (1) the corner as restored or reestablished, and (2) to at least 2 of the witness monuments shown on the drawing in (d), above.

NONE

(f) Was the corner restored through acceptance of (1) an obliterated evidence location, or, (2) a found perpetuated location?

(g&h) Was the corner reestablished through lost corner proportionate methods? If so, show the method, including the directions and distances to other public land survey corners used as evidence or used for proportioning in determining the corner location?

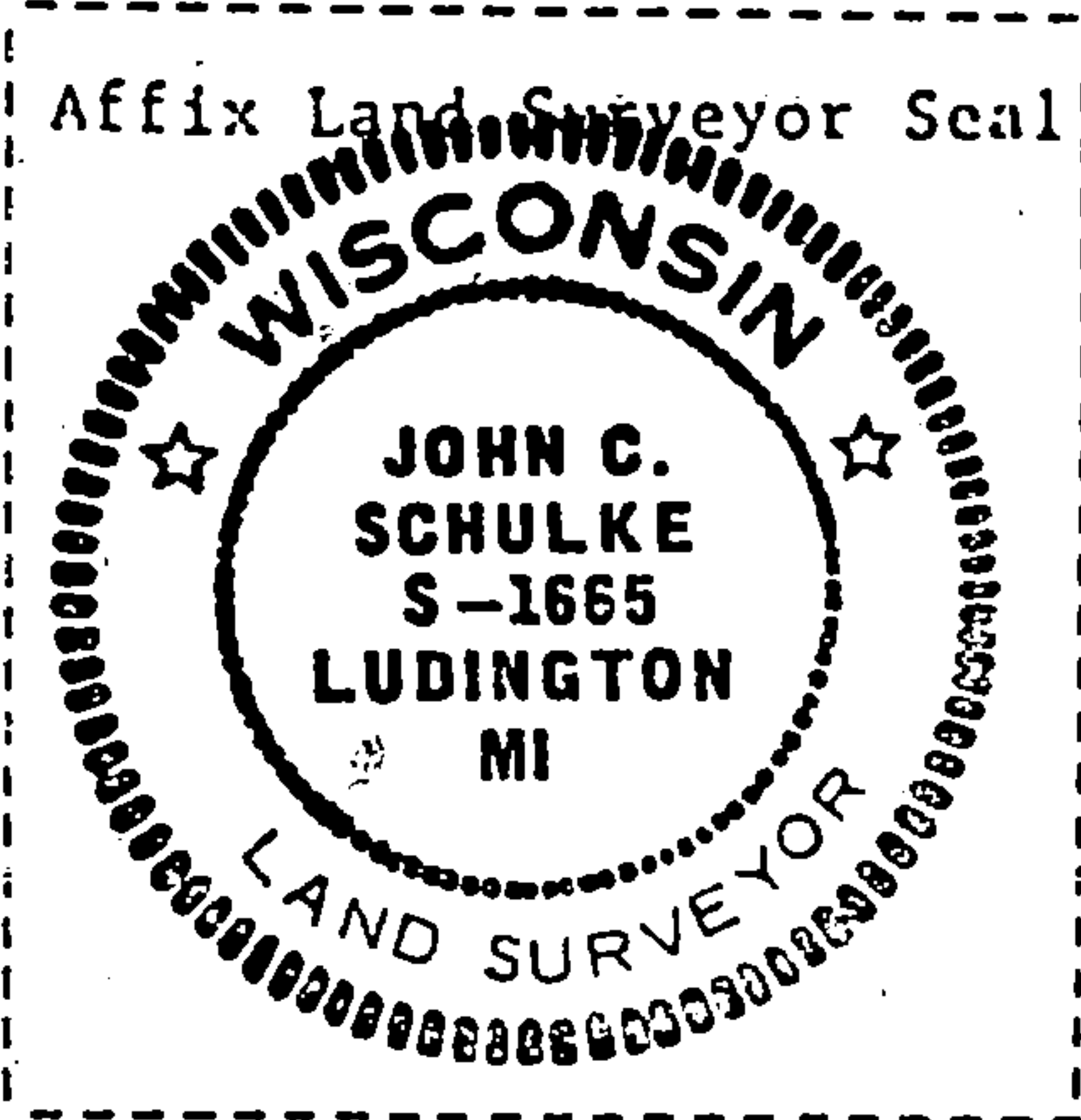
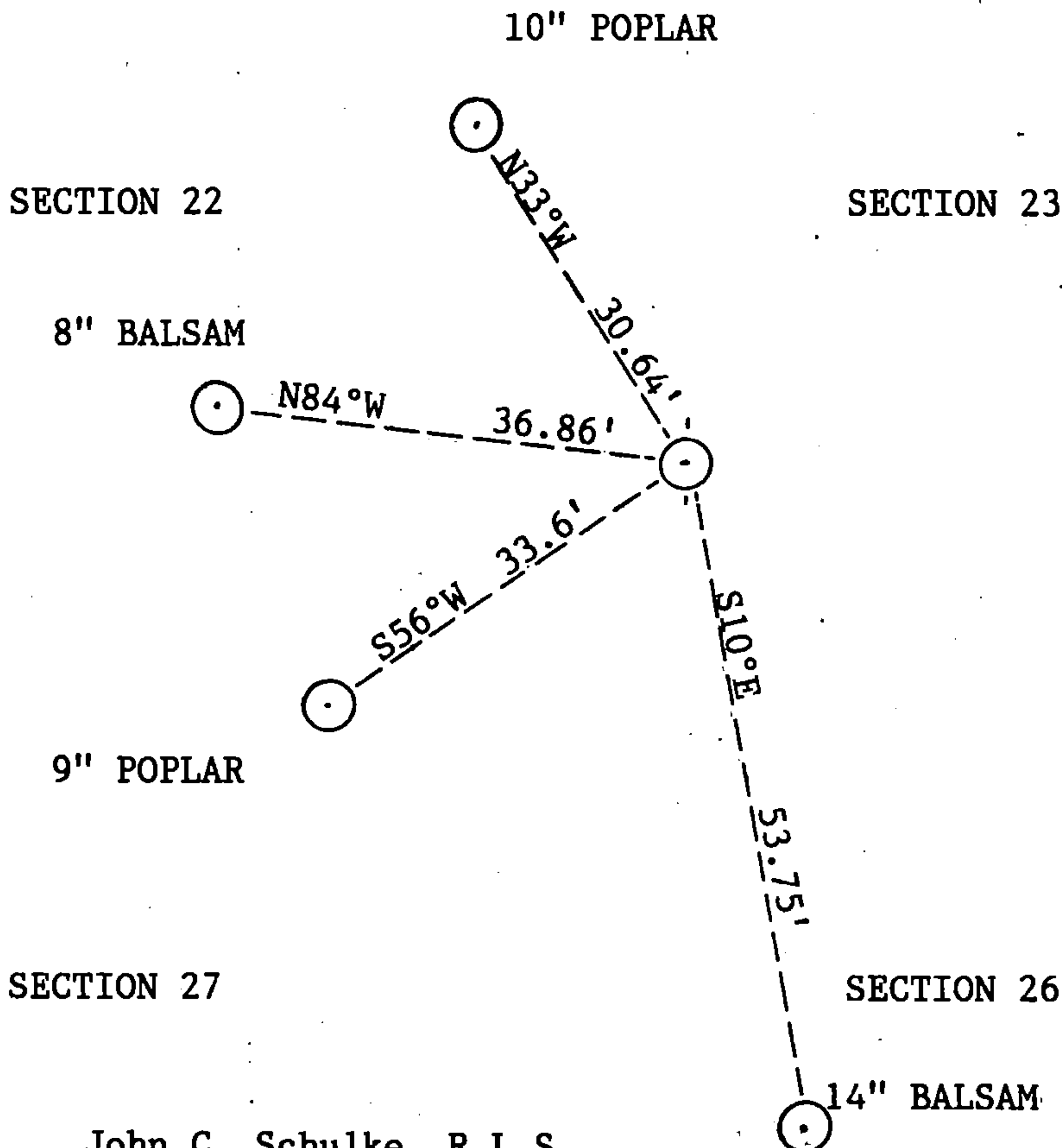

(i) I, John C. Schulke, R.L.S.
(type or print name) certify that the corner location shown on this record was determined by me or under my direction and control and that this U.S. Public Land Survey Monument Record is correct and complete to the best of my knowledge and belief.

John C. Schulke Oct 10, 1995
Signature Date