

CERTIFIED LAND CORNER RESTORATION

State of Wisconsin }  
County of Forest } ss.

I Jean F. Resvick, do hereby certify that on the 23 day of October, 1978, I found evidence of the Southeast Section corner of Section 33 Township 41 North, Range 14 East, Fourth Principal Meridian, as described hereon; and that from this evidence I established a new monument and accessories as described hereon to perpetuate the original location of this corner:

Description of original monument and accessories and subsequent restorations:

Surveyed in 1858 by Artemas Curtis  
Dependent resurvey in 1945 by H.B. Crawford  
Proportional distance set an iron post, 3 feet long, 2 inch diameter, 27 inches in ground with brass cap marked: S.C., T41N, R14E, S33, S34, 1945  
Poplar 9, N26E, 30 lks.  
Elm 6, N12 1/4W, 59 1/2 lks.

Description of corner evidence found:

Monument as described  
Poplar, fallen, rotted off, scribed, 19.80 feet  
Elm 10, N12W, 39.3 feet, dead  
Elm 7, N59W, 16.1 feet, dead  
Elm 5, N37E, 49.4 feet, dead

Description of ~~monument~~ and accessories I established to perpetuate the location of this corner:

Blazed and scribed the following new bearing trees:  
Maple 7, N10E, 21.41 feet  
Maple 6, N23W, 24.05 feet  
Set steel sign post 0.5 feet west of monument

44114330000

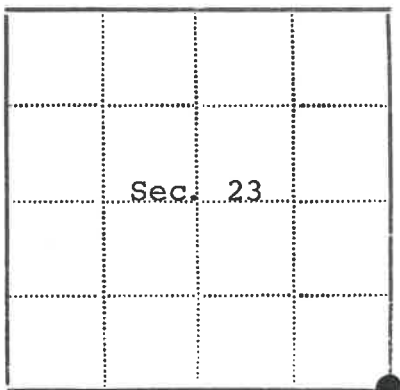
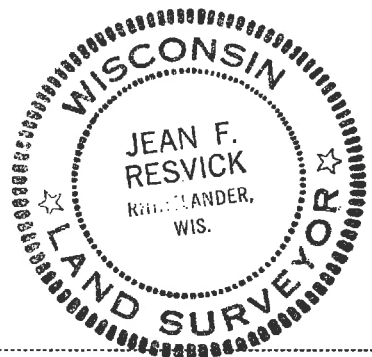

● - Corner monument restored  
□ -

Resident witnesses.....

Dated at Rhineland Wisconsin, this 2 day of November, 1978.

Signature Jean F. Resvick Title Land Surveyor  
(County Surveyor, Registered Land Surveyor, or other duly authorized official)

Surveyors Registration No. S-802 DOCUMENT NUMBER 115182

Office of REGISTER OF DEEDS County of FOREST

I hereby certify that the within instrument was filed in this office for record on the 27th day of November, 1978, and was filed in Book No. .... Page No. .... of County Records.

Signature Eugene Stutz Title Register of Deeds

Township 41 North, Range 14 East, Section 33, Index No. Z-13, Page No. ....