

# CERTIFIED LAND CORNER RESTORATION

State of Wisconsin }  
County of Forest } ss.

I William B. Cochrane, do hereby certify that on the 19 day of April, 1977, I found evidence of the Standard Quarter corner of Section 35 Township 41 North Range 14 East, Fourth Principal Meridian, as described hereon; and that from this evidence I established a new monument and accessories as described hereon to perpetuate the original location of this corner:

Description of original monument and accessories and subsequent restorations:

Surveyed in 1858 by Artemas Curtis.  
Dependent Resurvey in 1945 by H.B. Crawford  
From original evidence set a concrete monument 3 feet long, 4 inch diameter with a brass cap stamped: SC, 1/4, S35, 1945  
Spruce, 4", N29°15'E, 54 lks.  
Tamarack, 4", N59°30'W, 148 lks.

Description of corner evidence found:

Standard 1/4 corner as described. The concrete is rotting away from the iron pipe and brass cap.  
Spruce, 6", (dead) N30°E, 35.6 feet  
Tamarack, 5", N59°W, 97.7 feet

Description of monument and accessories I established to perpetuate the location of this corner:

Blazed and scribed the following new bearing trees:  
Tamarack, 5", N37°E, 36.17 feet  
Tamarack, 5", N83°W, 54.20 feet  
Set a steel sign post North, 0.50 ft.

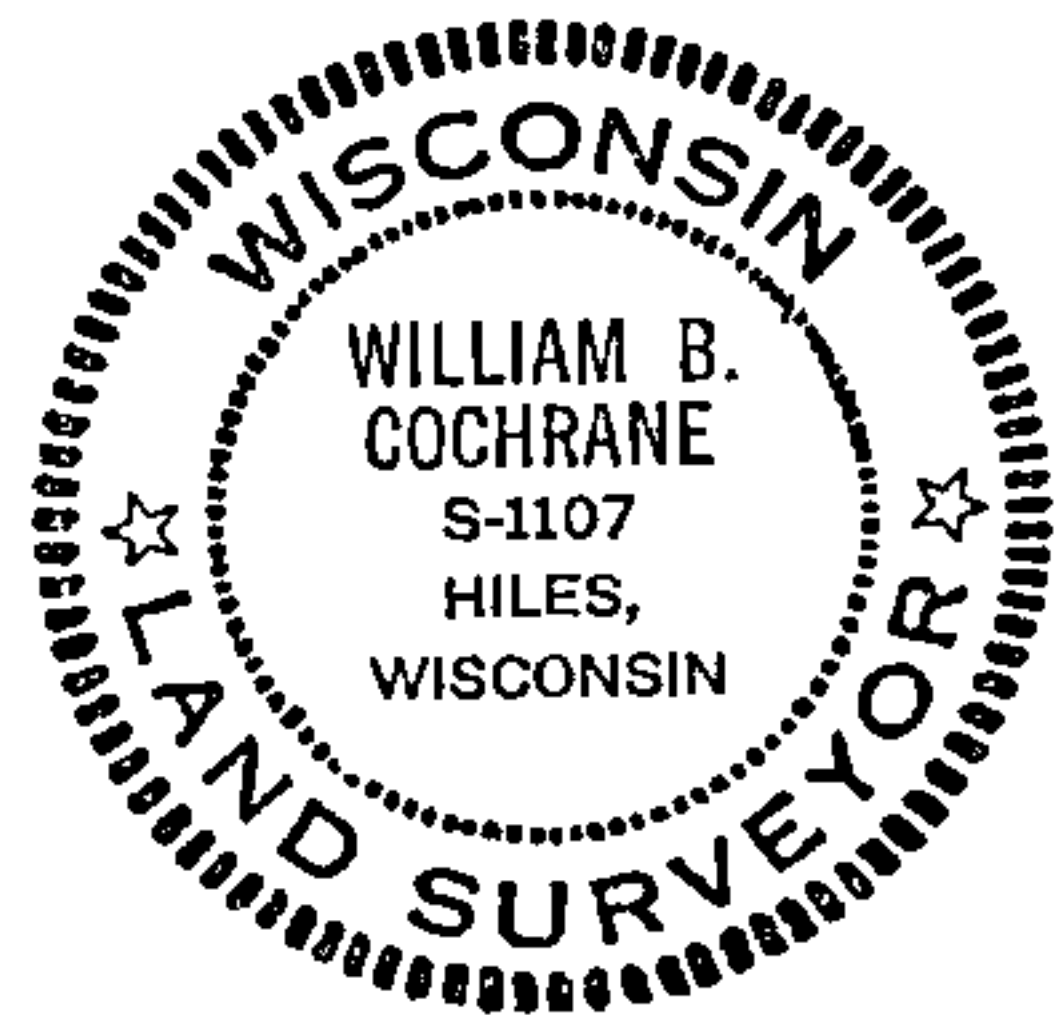

44114350020

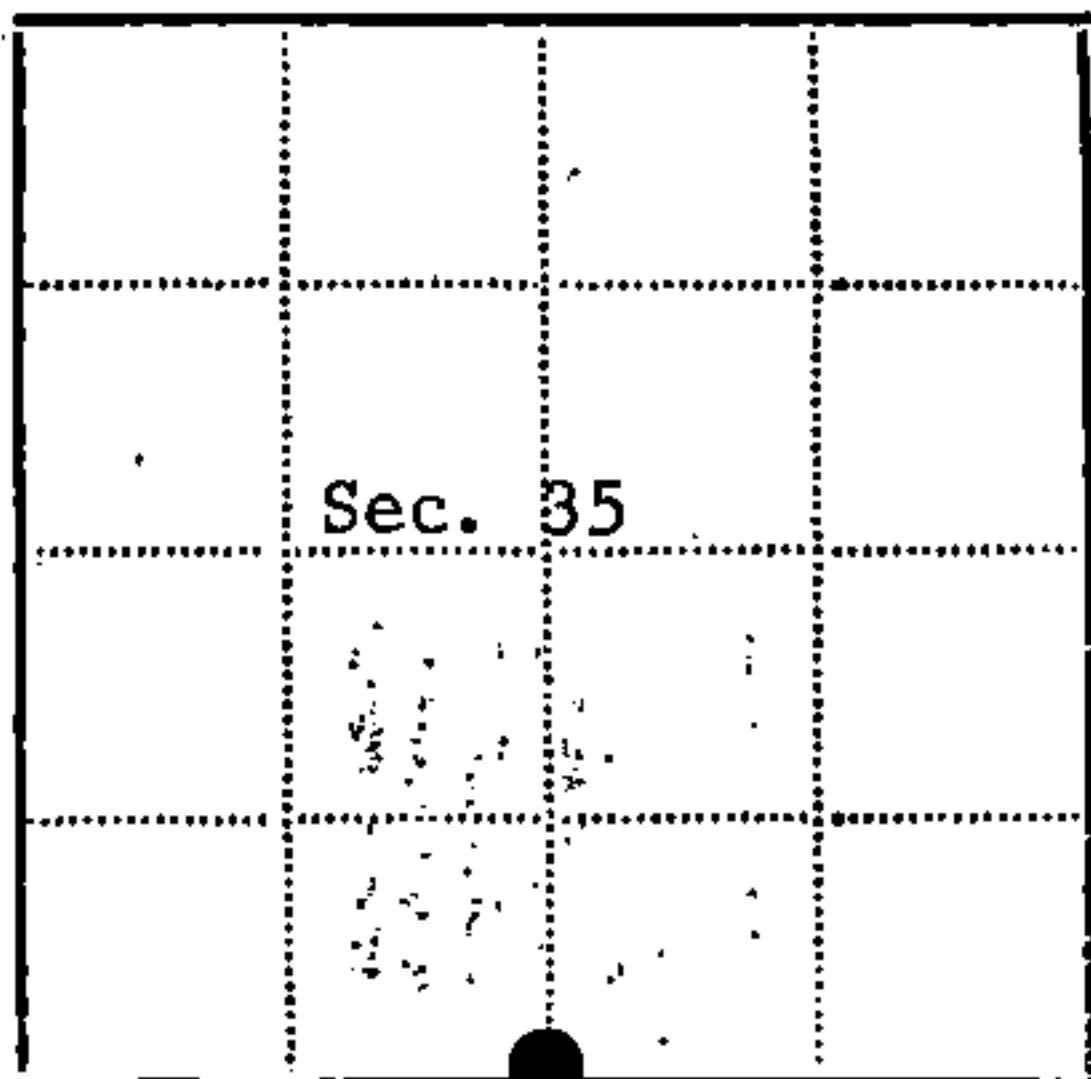

● - Corner monument restored  
□ -

Resident witnesses.....

Dated at Laona Wisconsin, this 20 day of July 1977.

Signature William B. Cochrane Title Survey Technician  
(County Surveyor, Registered Land Surveyor, or other duly authorized official)

Surveyors Registration No. S-1107 DOCUMENT NUMBER 113319

Office of Register of Deeds County of Forest

I hereby certify that the within instrument was filed in this office for record on the 13th day of February 1978, and was filed in Book No. \_\_\_\_\_ Page No. \_\_\_\_\_ of County Records.

Signature Eugen Statny Title Register of Deeds

Township 41 North, Range 14 East, Section 35, Index No. Z-19, Page No. \_\_\_\_\_