

BENCHMARKS

BM. NO.	STATION	DESCRIPTION	ELEV.
2	43+75	16d NAIL 8" POPLAR 89' LT.	473.20
3	65+00	1/4 CORNER SEC. 18,17 T.35E. R.15E. 50' RT.	500.27

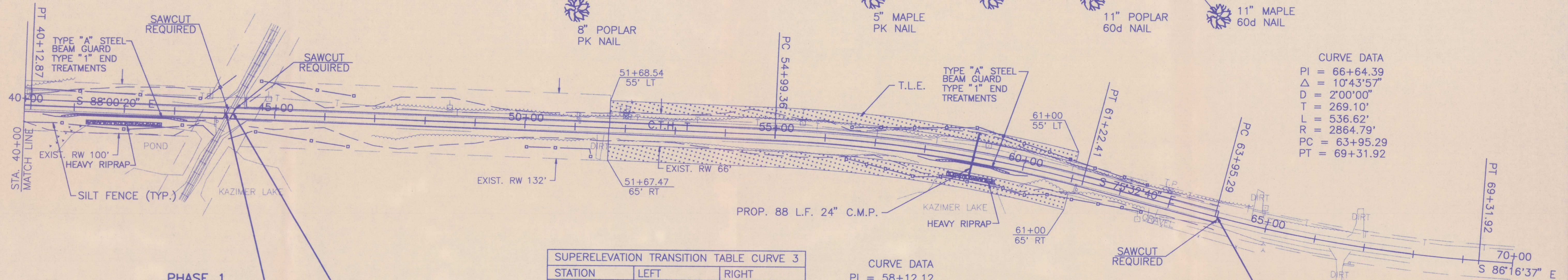

SUPERELEVATION TRANSITION TABLE CURVE 3

STATION	LEFT	RIGHT
53+20	-0.02 /FT.	-0.02 /FT.
53+90	0.0	-0.02
54+61.11	+0.02	-0.02
55+50	+0.045	-0.045
60+75	+0.045	-0.045
61+63.89	+0.02	-0.02
62+35	0.0	-0.02
63+05	-0.02 /FT.	-0.02 /FT.

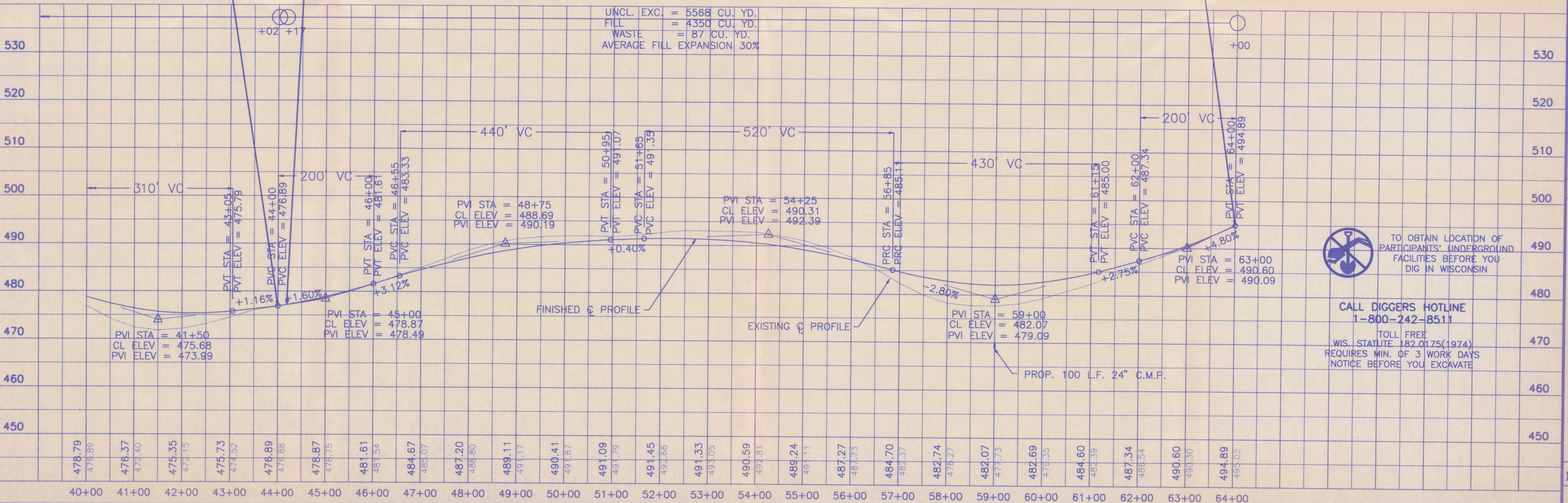

TO OBTAIN LOCATION OF PARTICIPANTS' UNDERGROUND FACILITIES BEFORE YOU DIG IN WISCONSIN

CALL DIGGERS HOTLINE 1-800-242-8511

TOLL FREE
WIS. STATUTE 182.0175(1974)
REQUIRES MIN. OF 3 WORK DAYS NOTICE BEFORE YOU EXCAVATE

MSA MID-STATE ASSOCIATES, INC.
Engineers-Architects-Planners-Surveyors-Scientists
1835 N. Stevens St. Rhinelander, WI 54501 (715-362-3244)
© 1984 MID-STATE ASSOCIATES

PROJECT NO.: 939405
DATE: JUNE, 1994
SCALE: H=1"=100', V=1"=10'

FILE NO. M00-000
SHEET 4 of 11

PLAN & PROFILE
C.T.H. STA. 40+00 TO STA. 64+00
FOREST COUNTY, WISCONSIN

DATE: 6-9-94
DRAWN BY: PJK
CHECKED BY: CAD