

A Parcel of Land Being Lot 2 of Crawford Lake Estates in Section 15, T34N, R13E, Town of Nashville, Forest County, Wisconsin

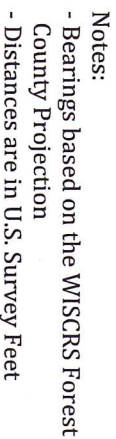

I, Christopher M. Stebbins, a Professional Land Surveyor in the State of Wisconsin, hereby certify that the above survey and map were completed in accordance with acceptable professional standards, that I have complied with the minimum requirements of AE-7 of the Wisconsin Administrative Code, and that the information presented is true and accurate to the best of my knowledge and belief.

- Found 3/4" rebar with yellow Tremi cap
- () Record measurement from Crawford Lake Estates Plat Doc. Number 191446
- △ Computed position
- Found 3/4" rebar
- ◎ Found 2.5" iron pipe
- ◎ Found Kimberly Clark aluminum monument
- ◎ Found 1.25" iron pipe

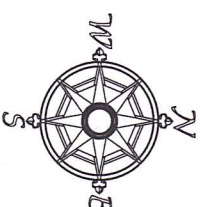
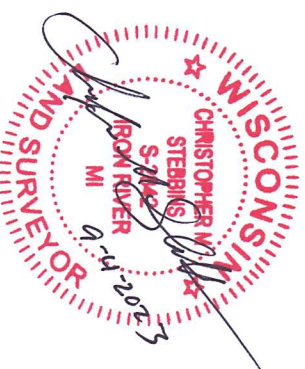

Project# 23057 Drawn By: Chris Stebbins

Scale 1"=200'

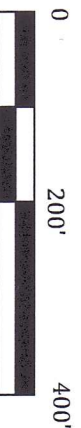

Sheet 1 of 1

022-01296-0001