

RECEIVED

DEC 08 22

CO. TREASURER

N

FOREST CO SURVEYOR

FILE # 341329-20221104

DATE BY

# FOREST COUNTY MAP OF SURVEY

LOCATED IN PART OF GOVT. LOT 4, LOT #29-15, UPHAMS ASSESSORS PLAT OF PICKEREL LAKE

IN SECTION 29, TOWNSHIP 34 NORTH, RANGE 13 EAST, TOWN OF POLAR, LANGLADE

TOWN OF NASHVILLE, FOREST COUNTY, WISCONSIN.

BEARINGS REFERENCED TO  
THE WEST LINE OF THE NW1/4  
OF SECTION 29, T34N, R13E  
TOWN OF NASHVILLE  
ASSUMED TO BEAR N3°11'14"W.

## LEGAL DESCRIPTION

COMENCING AT THE NW CORNER OF SAID SECTION 29;  
THENCE S3°11'14"E, 2540.06 FEET; THENCE N86°48'46"E, 486.92 FEET;  
THENCE S36°31'03"W, 59.64 FEET, WHICH IS THE POINT OF  
BEGINNING FOR THIS SURVEY; THENCE  
S51°11'15"E, 221.84 FEET, TO A MEANDER CORNER WHICH LIES  
23 FEET ± FROM THE SHORE OF PICKEREL LAKE; THENCE ALONG  
THE MEANDER LINE S55°25'09"W, 62.05 FEET TO MEANDER CORNER  
WHICH IS 26 FEET ± FROM THE SHORE OF PICKEREL LAKE;  
THENCE N50°38'45"W, 201.81 FEET; THENCE N36°31'03"E, 57.60 FEET  
TO THE POINT OF BEGINNING FOR THIS SURVEY.  
THIS PARCEL CONTAINS .32± ACRES OR 13,862± SQUARE FEET.

## SURVEYORS STATEMENT

I, DEAN WILLIAMS, LAND SURVEYOR, WISCONSIN  
REGISTRATION PLS-2468, DO HEREBY CERTIFY THAT I HAVE  
SURVEYED FOR OWNER AARON GRESH, THE LANDS SHOWN  
HEREON, AND THAT THE SAID SURVEY IS ACCURATE AND TRUE TO THE  
BEST OF MY KNOWLEDGE AND BELIEF; THAT THE MAP SHOWN HEREON  
IS A TRUE AND CORRECT REPRESENTATION OF THE SAID SURVEY,  
AND THAT I HAVE COMPLIED WITH THE APPLICABLE REQUIREMENTS  
OF SECTION A-E 7.01 OF THE WISCONSIN ADMINISTRATIVE CODE.  
AND THE REGULATIONS OF MARATHON COUNTY, WISCONSIN.

DATED THIS 9TH DAY OF SEPTEMBER, 2022

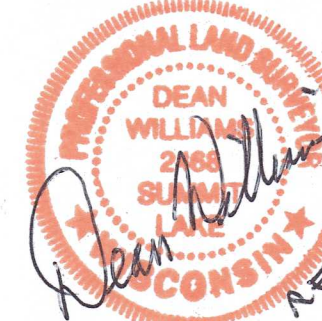

REVISED  
11-4-2022

SCALE 1" = 60'

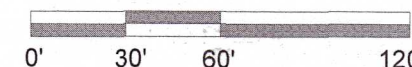

## LEGEND

- — Found 1.3" I.P., to 2" I.P.
- X — Not Fnd.
- ( ) — Record Bearing/Distance

22-1872