

RECEIVED

APR 08 24

CO. TREASURER

FOREST CO SURVEYOR

FILE # 34405-20180427

DATE 2/21/2025 BY JA

PLAT OF SURVEY

LOT 8 OF CERTIFIED SURVEY MAP VOLUME 1 PAGE 364,
LOT 1 OF CERTIFIED SURVEY MAP VOLUME 4 PAGE 100,
AND PART OF GOVERNMENT LOT 2, ALL LOCATED IN
GOVERNMENT LOTS 1 AND 2, SECTION 5, T34N-R14E,
TOWN OF FREEDOM, FOREST COUNTY, WISCONSIN

LEGEND

- () RECORDED DISTANCE
- W WELL
- ⊙ SEPTIC TANK
- ⊙ SEPTIC VENT
- △ COMPUTED POINT
- ⊙ FOUND 3/4" IRON ROD
- FOUND 1" IRON PIPE
- ⊙ FOUND 1.3" IRON PIPE
- ⊙ FOUND 1.5" IRON PIPE
- ⊙ FOUND ALUM. WIT. MON.
- SET 1.05" O.D. X 18" LONG IRON PIPE WEIGHING 1.13 LBS/LF

BEARINGS REFERENCED TO THE FOREST
COUNTY COORDINATE SYSTEM GRID.

Parcel 1 Description:

Commencing at the Northwest Corner of Section 5; Thence S01°17'19"W, 395.42 feet to a Meander Corner on the North Shore of Roberts Lake; Thence S32°19'13"E, 464.38 feet to the Point of Beginning; Thence N64°39'27"E, 837.14 feet; Thence S65°04'45"E, along the Southerly right-of-way of C.T.H. "W", 47.09 feet; Thence S64°21'45"E, along said right-of-way, 73.80 feet; Thence S54°32'45"E, along said right-of-way, 143.10 feet; Thence S70°37'47"W, 994.91 feet to a meander corner which lies N70°37'47"E, 20 feet more or less from the ordinary high water mark of Roberts Lake; Thence N22°21'36"W, along a meander line, 115.10 feet to a meander corner which lies N64°39'27"E, 24 feet more or less from the ordinary high water mark of said lake, the Point of Beginning.

Parcel 2 Description:

Commencing at the Northwest Corner of Section 5; Thence S01°17'19"W, 395.42 feet to a Meander Corner on the North Shore of Roberts Lake; Thence S32°19'13"E, 464.38 feet; Thence S22°21'36"E, 115.10 feet; Thence S14°57'29"E, 116.52 feet to the Point of Beginning; Thence N80°53'28"E, 993.00 feet; Thence S01°42'40"E, 342.14 feet; Thence N87°07'57"W, along the South line of Government Lot 1, 775.89 feet; Thence N35°08'31"E, along the westerly right-of-way of Maple Heights Road, 92.99 feet; Thence S80°51'18"W, 273.54 feet to a meander corner which lies N80°51'18"E, 31 feet more or less from the ordinary high water mark of Roberts Lake; Thence N10°34'59"E, along a meander line, 115.37 feet to a meander corner which lies N80°53'28"E, 20 feet more or less from the ordinary high water mark of said lake, the Point of Beginning.

Parcel 3 Description:

Commencing at the Northwest Corner of Section 5; Thence S01°17'19"W, 395.42 feet to a Meander Corner on the North Shore of Roberts Lake; Thence S32°19'13"E, 464.38 feet; Thence S22°21'36"E, 115.10 feet; Thence S14°57'29"E, 116.52 feet; Thence N80°53'28"E, 993.00 feet; Thence S01°42'40"E, 342.14 feet to the Point of Beginning; Thence continuing S01°42'40"W, 94.58 feet; Thence N87°05'46"W, 750.54 feet; Thence N31°14'12"E along the easterly right-of-way of Maple Heights Road, 106.92 feet; Thence S87°07'57"E, 775.89 feet to the Point of Beginning.

Surveyor's Certificate:

I, Timothy J. Rusch, Professional Land Surveyor, do hereby certify:

That I have surveyed and mapped by the order of Ken Whitney, owner of Parcel 1 hereon, and John Whitney, owner of Parcels 2&3 hereon, parcels being Lot 8 of Certified Survey Map Volume 1 Page 364, Lot 1 of Certified Survey Map Volume 4 Page 100, and part of Government Lot 2, all located in Government Lots 1 and 2 of Section 5, T34N-R14E.

That this survey was for the purpose of locating property boundaries only. Other geographical features were not mapped.

That this is a true and correct representation of the boundaries surveyed to the best of my knowledge and belief.

SURVEYED BY:
RUSCH ENGINEERING & SURVEYING LLC
400 RUSCH ROAD
ANTIGO, WI 54409
(715)623-5044
PROJECT #17-5741

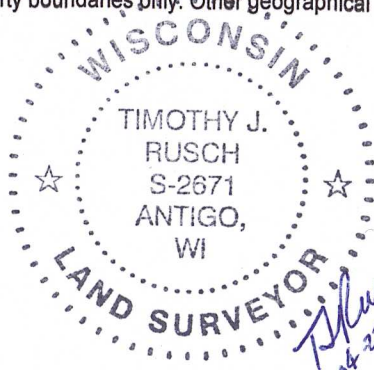

SCALE: 1 INCH = 120 FEET

120 60 0 120

