

## LAKE

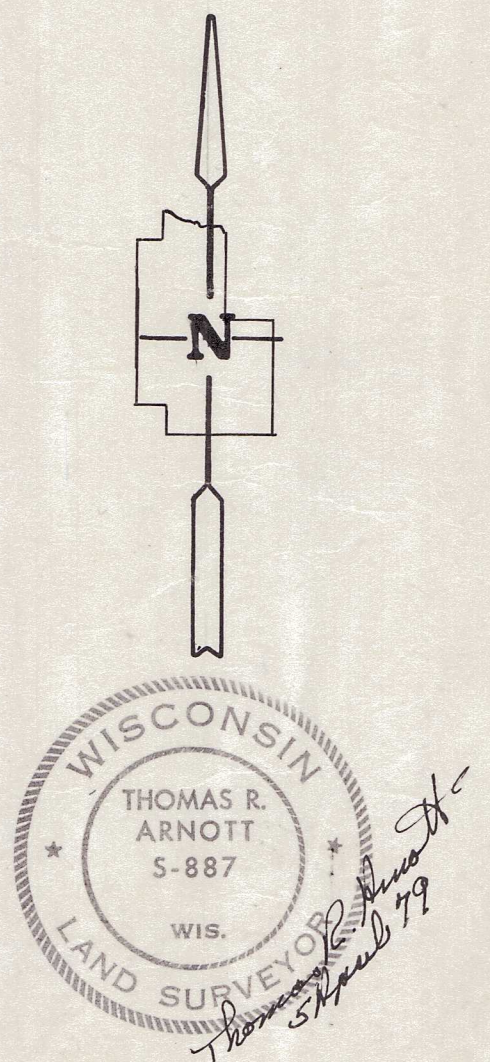

- - ALUMINUM CAPPED MONUMENT SET BY KIMBERLY - CLARK CORP. AND FOUND IN PLACE.
- ▲ - CONCRETE MONUMENT WITH BRASS CAP SET DURING THE DEPENDENT RESURVEY OF SEC. 6 IN 1946.
- - 1" IRON PIPE FOUND THAT WAS SET BY KIMBERLY - CLARK CORP. IN THE PROCESS OF LAND DEVELOPMENT.
- - 2" X 30" IRON PIPE SET DURING THIS SURVEY.

SURVEY OF THE NE 1/4 - NE 1/4, SEC. 12,  
T34N, R13E, TOWN OF NASHVILLE AND  
GOV'T LOT 1 AND PART OF GOV'T LOT 2,  
BOTH OF SEC. 7, T34N, R14E, TOWN  
OF FREEDOM, ALL OF FOREST COUNTY,  
WISCONSIN.

FOREST CO SURVEYOR  
FILE # 341407-19790405  
DATE 2/4/25 BY KL

THOMAS R. ARNOTT  
REGISTERED LAND SURVEYOR  
ROUTE 1, BOX 208  
CRANDON, WIS. 54520

MAP OF SURVEY FOR  
KIMBERLY - CLARK, INC.

SCALE : 1" = 200'

DATE: 5 APRIL 1979