

THE NORTHWEST 1/4 OF THE SOUTHWEST 1/4 AND PART OF THE SOUTHWEST 1/4 OF THE SOUTHWEST 1/4 OF SECTION 29, TOWNSHIP 34 NORTH, RANGE 15 EAST, TOWN OF WABENO, FOREST COUNTY, WISCONSIN.

I JOSHUA W. PRENTICE, WISCONSIN PROFESSIONAL LAND SURVEYOR S-2852, DO HEREBY CERTIFY TO THE BEST OF MY KNOWLEDGE AND BELIEF: THAT I HAVE SURVEYED AND MAPPED THE NORTHWEST 1/4 OF THE SOUTHWEST 1/4 AND PART OF THE SOUTHWEST 1/4 OF THE SOUTHWEST 1/4 OF SECTION 29, TOWNSHIP 34 NORTH, RANGE 15 EAST, TOWN OF WABENO, FOREST COUNTY, WISCONSIN, MORE PARTICULARLY DESCRIBED AS FOLLOWS:

THAT SAID PARCEL CONTAINS 3,270,173 SQUARE FEET, 75.073 ACRES, MORE OR LESS.

THAT SAID PARCEL IS A CORRECT AND ACCURATE REPRESENTATION OF THE EXTERIOR  
BOUNDARY OF SAID PARCEL.

REI  
JOSHUA W. PRENTICE  
WI P.L.S. S-2852

- - 1-1/4 IN. O.D. IRON PIPE FOUND
- - 1-1/4 IN. O.D. X 18 IN. IRON PIPE  
WEIGHING 1.68 LBS/LIN. FT. SET
- (126') - RECORDED BEARING/LENGTH  
FROM FLAT OF SURVEY OF NE  
1/4 - SW 1/4 AND SE 1/4 - SW 1/4
- 126.00' - MEASURED BEARING/LENGTH

1. BEARINGS ARE BASED ON THE FOREST COUNTY COORDINATE SYSTEM, NAD 83(2011) DATUM AND REFERENCED TO THE WEST LINE OF THE SOUTHWEST 1/4 OF SECTION 29, TOWNSHIP 34 NORTH, RANGE 15 EAST, MEASURED TO BEAR NORTH 00°50'54" EAST.
2. FIELD WORK WAS COMPLETED ON 08/04/2022.
3. THE INTENT OF THIS SURVEY IS TO MONUMENT THE EXTERIOR BOUNDARIES OF THE TWO PARCELS. THIS MAP IS NOT INTENDED TO COMBINE THESE PARCELS IN ANYWAY.
4. ELLIOT ROAD RIGHT-OF-WAY IS BASED ON SURVEYS OF RECORD AND GAS TAP MAPPING. THE IMPROVEMENTS APPEAR TO THE GENERALLY MATCH THE RIGHT-OF-WAY.

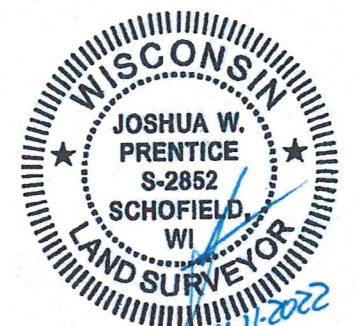

 **REI**  
REI No. 10529  
SHEET 1 OF 1

DATE	REVISION	BY	CHK'D
10-12-2022	UPDATED MAP NOTES	JWP	JLR

PLAT OF SURVEY  
241529-2003072

LOT 2  
OWNED BY  
OTHERS

LOT 1  
OWNED BY  
OTHERS

—APPLE LANE

SOUTH 1/4 CORNER  
SEC. 29, T34N, R15E  
FOUND 60D SPIKE

RIGHT-OF-WAY