

RECEIVED

NOV 15 19

CO. TREASURER

PLAT OF SURVEY

ALL OF LOTS 1, 2, AND 3 OF BLOCK B OF THE VILLAGE OF CARTER PLAT, LOCATED IN THE NORTHEAST 1/4 OF THE NORTHWEST 1/4 OF SECTION 33, TOWNSHIP 34 NORTH, RANGE 15 EAST, TOWN OF WABENO, FOREST COUNTY, WISCONSIN.

SURVEYOR'S CERTIFICATE

I JOSHUA W. PRENTICE, WISCONSIN PROFESSIONAL LAND SURVEYOR S-2852, DO HEREBY CERTIFY TO THE BEST OF MY KNOWLEDGE AND BELIEF: THAT I HAVE SURVEYED AND MAPPED ALL OF LOTS 1, 2, AND 3 OF BLOCK "B" OF THE VILLAGE OF CARTER PLAT, LOCATED IN THE NORTHEAST 1/4 OF THE NORTHWEST 1/4 OF SECTION 33, TOWNSHIP 34 NORTH, RANGE 15 EAST, TOWN OF WABENO, FOREST COUNTY, WISCONSIN, MORE PARTICULARLY DESCRIBED AS FOLLOWS:

COMMENCING AT THE NORTH 1/4 CORNER OF SAID SECTION 33, THENCE NORTH 88°43'26" WEST, COINCIDENT WITH THE NORTH LINE OF THE NORTHWEST 1/4 462.16 FEET; THENCE SOUTH 01°16'34" WEST, 656.47 FEET TO THE NORTHEAST CORNER OF SAID LOT 1, THE INTERSECTION OF THE SOUTH RIGHT-OF-WAY LINE OF MAIN STREET AND THE WEST RIGHT-OF-WAY LINE OF FIRST STREET AND THE POINT OF BEGINNING; THENCE SOUTH 00°11'47" EAST, COINCIDENT WITH SAID WEST RIGHT-OF-WAY LINE OF FIRST STREET, 120.38 FEET TO THE SOUTHEAST CORNER OF SAID LOT 1; THENCE SOUTH 89°37'50" WEST, COINCIDENT WITH THE NORTH RIGHT-OF-WAY LINE OF THE ALLEY IN SAID BLOCK "B", 179.69 FEET TO THE SOUTHWEST CORNER OF SAID LOT 3; THENCE NORTH 00°11'47" WEST, COINCIDENT WITH THE WEST LINE OF SAID LOT 3, 120.56 FEET TO THE NORTHWEST CORNER OF SAID LOT 3 AND SAID SOUTH RIGHT-OF-WAY LINE OF MAIN STREET; THENCE NORTH 89°41'17" EAST, COINCIDENT WITH SAID SOUTH RIGHT-OF-WAY LINE, 179.69 FEET TO SAID NORTHEAST CORNER OF LOT 1, SAID INTERSECTION OF THE SOUTH RIGHT-OF-WAY LINE OF MAIN STREET AND THE WEST RIGHT-OF-WAY LINE OF FIRST STREET AND THE POINT OF BEGINNING.

THAT SAID PARCEL CONTAINS 21,647 SQUARE FEET OR 0.497 ACRES MORE OR LESS.

THAT I HAVE MADE THIS SURVEY AND MAP THEREOF AT THE DIRECTION OF THE FOREST COUNTY POTAWATOMI COMMUNITY, AGENT OF SAID PARCEL.

THAT SAID PARCEL IS SUBJECT TO EASEMENTS, RESTRICTIONS, AND RIGHT-OF-WAYS OF RECORD.

THAT I HAVE FULLY COMPLIED WITH THE PROVISIONS OF WISCONSIN ADMINISTRATIVE CODE A-E7.

THAT SAID PARCEL IS A CORRECT AND ACCURATE REPRESENTATION OF THE EXTERIOR BOUNDARY OF SAID PARCEL.

DATED THIS 13TH DAY OF NOVEMBER 2019

REI
JOSHUA W. PRENTICE
WI P.L.S. S-2852

LEGEND

- - 1-1/4 IN. O.D. IRON PIPE FOUND
- - 1-1/4 IN. O.D. X 18 IN. IRON PIPE WEIGHING 1.68 LBS/LIN. FT. SET
- ⊗ - CHISELED "X" SET
- (120') - RECORDED BEARING/LENGTH
- 120.00' - MEASURED BEARING/LENGTH

NOTES:

- BEARINGS ARE BASED ON THE FOREST COUNTY COORDINATE SYSTEM, NAD 83(2011) DATUM AND REFERENCED TO THE NORTH LINE OF THE NORTHWEST 1/4 OF SECTION 33, TOWNSHIP 34 NORTH, RANGE 15 EAST MEASURED TO BEAR NORTH 88°43'26" WEST.
- FIELD WORK WAS COMPLETED ON 10-25-2019.
- THE SOUTHWEST CORNER OF THE SEPTIC FIELD IS ±8.9' SOUTH OF THE PROPERTY LINE.
- RIGHT-OF-WAYS ARE BASED ON SURVEYS OF RECORD AND VERIFIED WITH MONUMENTS FOUND.

PLAT OF SURVEY

MICHAEL ASHBECK
3945 MAIN STREET
WABENO, WI 54566

REI
REI No. 8960
SHEET 1 OF 1

28-684

DRAWING FILE: P:\8900-9999\8960 - ASHBECK PROPERTY PLAT OF SURVEY.DWG SURVEY\8960 POS2.DWG LAYOUT: PLAT OF SURVEY-11X17
PLOTTED: NOV 12, 2019 - 2:39PM PLOTTED BY: JESSER

FOREST CO SURVEYOR

FILE # 341533-20191113

DATE BY

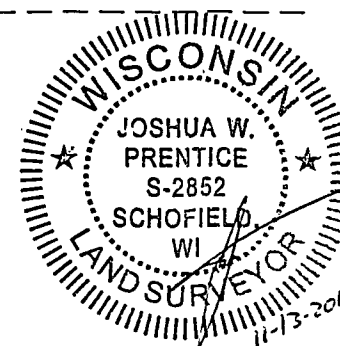

REI Engineering, INC.
4080 N. 20TH AVENUE
WAUSAU, WISCONSIN 54401
PHONE: 715.675.9784 FAX: 715.675.4060
EMAIL: MAIL@REIENGINEERING.COM



REI CIVIL & ENVIRONMENTAL
ENGINEERING, SURVEYING

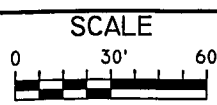

DATE	REVISION	BY	CHK'D

DESIGNED BY:	CHECKED BY: JWP
SURVEYED BY: CLF	APPROVED BY: JWP
DRAWN BY: MJS	DATE: 10-29-2019