

PLAT OF SURVEY U.S. GOVERNMENT LAND

BEING THE E 1/2 OF THE FRACTIONAL NW 1/4, THE S 1/2 OF THE NE 1/4, THE NE 1/4 OF THE NE 1/4, THE N 1/2 OF THE SE 1/4, GOV'T LOT 1, AND THE NE 1/4 OF THE FRACTIONAL SW 1/4 OF SECTION 7, TOWNSHIP 34 NORTH, RANGE 16 EAST, 4TH PRINCIPAL MERIDIAN, FOREST COUNTY, WISCONSIN

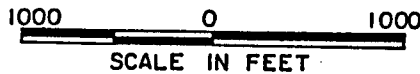
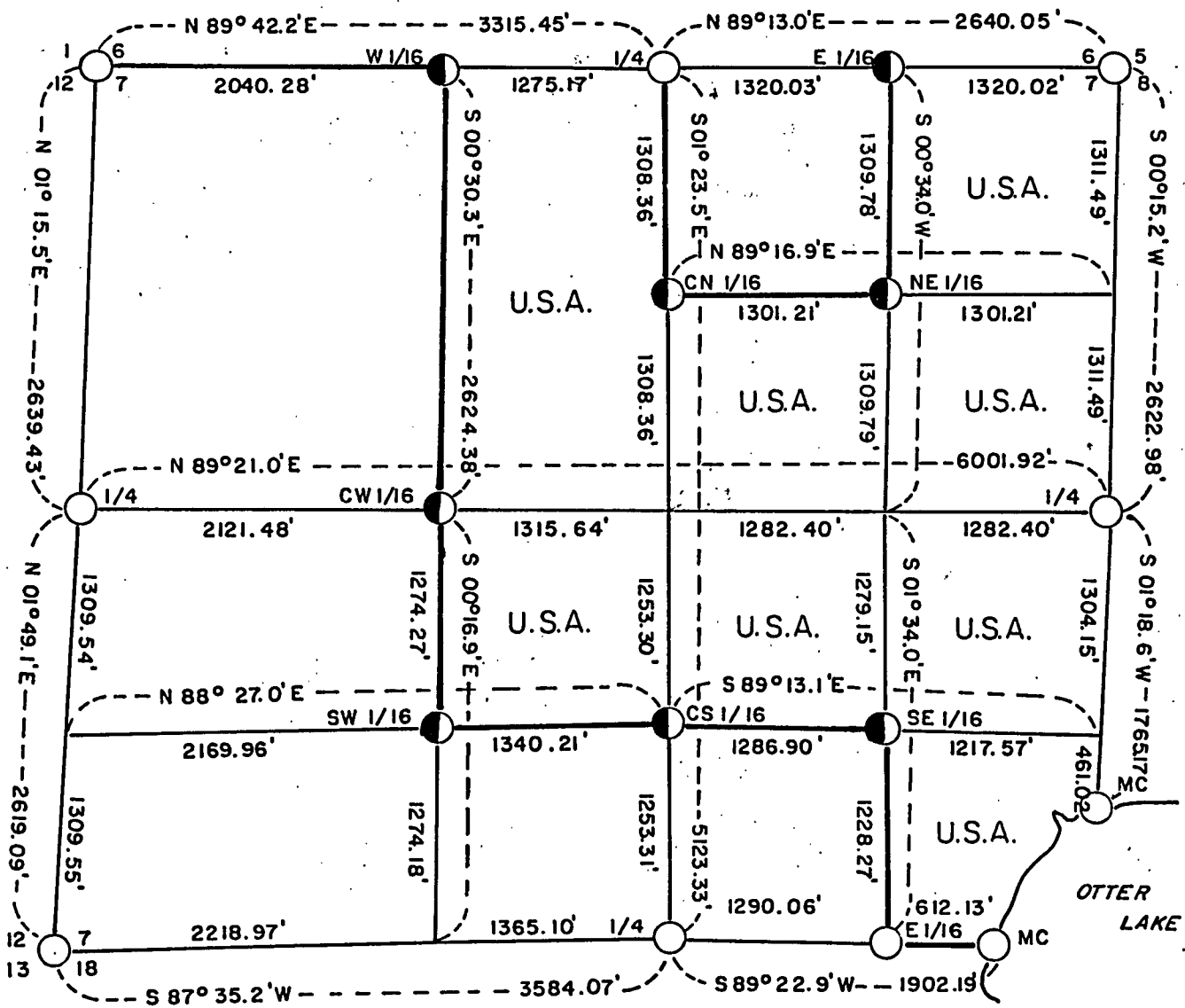

LEGEND

- Existing Forest Service monuments
- Set 2" Diameter Aluminum Monuments, 36" Long
- Marked Boundary Lines of U.S. Government Lands

CONVERSION FACTOR:

Feet to Meters = 0.3048
Meters to Feet = 3.280833

Stock No. 26273

Sheet two of five

SURVEY NOTES

This survey was made by AARON ASSOCIATES of Oconto Falls, Wisconsin under contract with the U.S. Department of Agriculture, Forest Service, using Forest Service section subdivisional data for the purpose of establishing subdivisional corners within Section 7, and for locating and marking the boundaries of U.S. Government lands on their perimeter and within Section 7, Township 34 North, Range 16 East, 4th Principal Meridian, Forest County, Wisconsin.

The U.S. Government lands were acquired in 1934 and 1936.

The Original Government Survey of this township was made in 1859.

The corner positions recovered, restored and established by this survey are marked with monuments described in the map legend.

The corner positions established by this survey were located to an accuracy of one part in 3000.

The bearings between corner positions are True Bearings as determined by Solar observations.

The field notes of this survey and a copy of the plat map are on file in the Forest Supervisor's Office at Rhinelander, Wisconsin.

CORNERS RECOVERED AND RESTORED

1. Section Corner to Sections 7-6-1-12, T34N, R16E, and T34N, R15E Resp.
Corner position found marked with a Forest Service monument.
Certificate on file in the Forest County courthouse.
2. Section Corner to Sections 5-6-7-8, T34N, R16E.
Corner position found marked with a Forest Service monument.
Certificate on file in the Forest County courthouse.
3. Section Corner to Sections 17-18-12-13, T34N, R16E, and T34N, R15E Resp.
Corner position found marked with a Forest Service monument.
Certificate on file in the Forest County courthouse.
4. Meander Corner to Sections - 7-8, T34N, R16E.
Corner position found marked with a Forest Service monument.
Certificate on file in the Forest County courthouse.
5. Quarter Corner to Sections 6-7, T34N, R16E.
Corner position found marked with a Forest Service monument.
Certificate on file in the Forest County courthouse.
6. Quarter Corner to Sections 7-8, T34N, R16E.
Corner position found marked with a Forest Service monument.
Certificate on file in the Forest County courthouse.
7. Quarter Corner to Sections 7-18, T34N, R16E.
Corner position found marked with a Forest Service monument.
Certificate on file in the Forest County courthouse.

Stock No. 26273

Sheet three of five

8. Quarter Corner to Sections 7-12, T34N, R16E and T34N, R15E Respectively,

Corner position found marked with a Forest Service Monument.
Certificate on file in the Forest County courthouse.

9. Meander Corner between Sections 7-18, T34N, R16E.

Corner position found marked with a Forest Service Monument.
Certificate on file in the Forest County courthouse.

CORNERS ESTABLISHED10. West Sixteenth Corner Between Sections 6-7, T34N, R16E.

Set this corner position at single proportionate position between the northwest and north quarter corners of Section 7 using Forest Service data.

Corner references:

Red Maple	9"	N58E	13.88 ft.
Sugar	11"	S45W	47.51 ft.
Sugar	6"	N74W	37.62 ft.
Sign Post		South	0.80 ft.

11. East Sixteenth Corner Between Sections 6-7-T34N, R16E.

Set this corner at midpoint between the north quarter and northeast corners of Section 7 according to Forest Service section data.

Corner references:

Popple	6"	S10E	45.56 ft.
Popple	5"	S58W	47.29 ft.
Sign Post		North	1.07 ft.

12. Northeast Sixteenth Corner of Section 7, T34N, R16E.

Set this corner position at the straight line intersection of sixteenth lines in the northeast quarter of Section 7 according to Forest Service section data.

Corner references:

Db1 Maple	11"	N52W	84.35 ft.
B. Cherry	6"	N36W	29.58 ft.
Maple	10"	N05W	103.89 ft.
Sign Post		West	1 foot

13. Center-North Sixteenth Corner of Section 7, T34N, R16E.

Set this corner position at midpoint between the center quarter and north quarter corners of Section 7 according to Forest Service section data.

Corner references:

Popple	4"	N85E	32.82 ft.
Popple	5"	S48E	31.86 ft.
Popple	10"	N63W	38.87 ft.
Sign Post		NE	0.55 ft.

14. Center-West Sixteenth Corner of Section 7, T34N, R16E.

Set this corner position at proportionate position along the line between the west quarter and center quarter corners of Section 7 according to Forest Service section data.

Corner references:

Stock No. 26273

Sheet four of five

11. (continued)

Popple	4"	N16E	1.85 ft.
Popple	4"	S62W	10.28 ft.
Popple	5"	N52W	27.25 ft.
Sign Post		South	0.80 ft.

15. Southwest Sixteenth Corner of Section 7, T34N, R16E.

Set this corner position at the straight line intersection of sixteenth lines in the southwest quarter of Section 7 according to Forest Service section data.

Corner references:

Yellow Birch	8"	S89W	44.90 ft.
Sugar	6"	S87E	5.00 ft.
Sugar	7"	S17W	36.06 ft.
Sign Post		North	0.93 ft.

16. Center-South Sixteenth Corner of Section 7, T34N, R16E.

Set this corner position at midpoint between the center quarter and south quarter corners of Section 7 according to Forest Service Section data.

Corner references:

Basswood	12"	N35E	23.89 ft.
Elm	7"	S21E	10.18 ft.
Elm	5"	S48W	18.27 ft.
Sign Post		West	1.77 ft.

17. Southeast Sixteenth Corner of Section 7, T34N, R16E.

Set this corner position at the straight line intersection of sixteenth lines in the southeast quarter of Section 7 according to Forest Service section data.

Corner references:

Cedar	7"	S62E	55.21 ft.
Db1. Cedar	6"	N08E	28.48 ft.
Black Ash	5"	S04E	28.31 ft.
Sign Post		West	0.83 ft.

18. East Sixteenth Corner between Sections 7-18, T34N, R16E.

Corner position found marked with a Forest Service monument. Certificate on file in the Forest County courthouse.

Stock No. 26273

Sheet five of five

SURVEYOR'S AFFIDAVIT

STATE OF WISCONSIN)
COUNTY OF FOREST)SS

I, Kim H Pritzlaff, Registered Land Surveyor in the State of Wisconsin hereby certify: that I have surveyed and subdivided Section 7, Township 34 North, Range 16 East, 4th Principal Meridian, Forest County, Wisconsin.

That the Plat map and notes herewith are a true and correct representation of the land surveyed and subdivided using Forest Service section data and that I have surveyed and subdivided said Section 7 in accordance with the rules of survey of the public lands and with the Statutes of the State of Wisconsin.

Date of Survey: 1986.

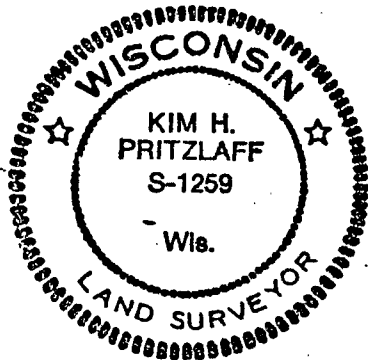

Kim H. Pritzlaff

Kim H Pritzlaff, RLS No. 1259
AARON ASSOCIATES
Oconto Falls, Wisconsin

Plat ready for filing

Dee S. Stage
District Ranger

