

PLAT OF SURVEY U.S. GOVERNMENT LANDS

BEING THE S.W. 1/4 OF SECTION 22, TOWNSHIP 35 NORTH,
RANGE 15 EAST, FOURTH PRINCIPAL MERIDIAN,
FOREST COUNTY, WISCONSIN.

SCALE IN FEET

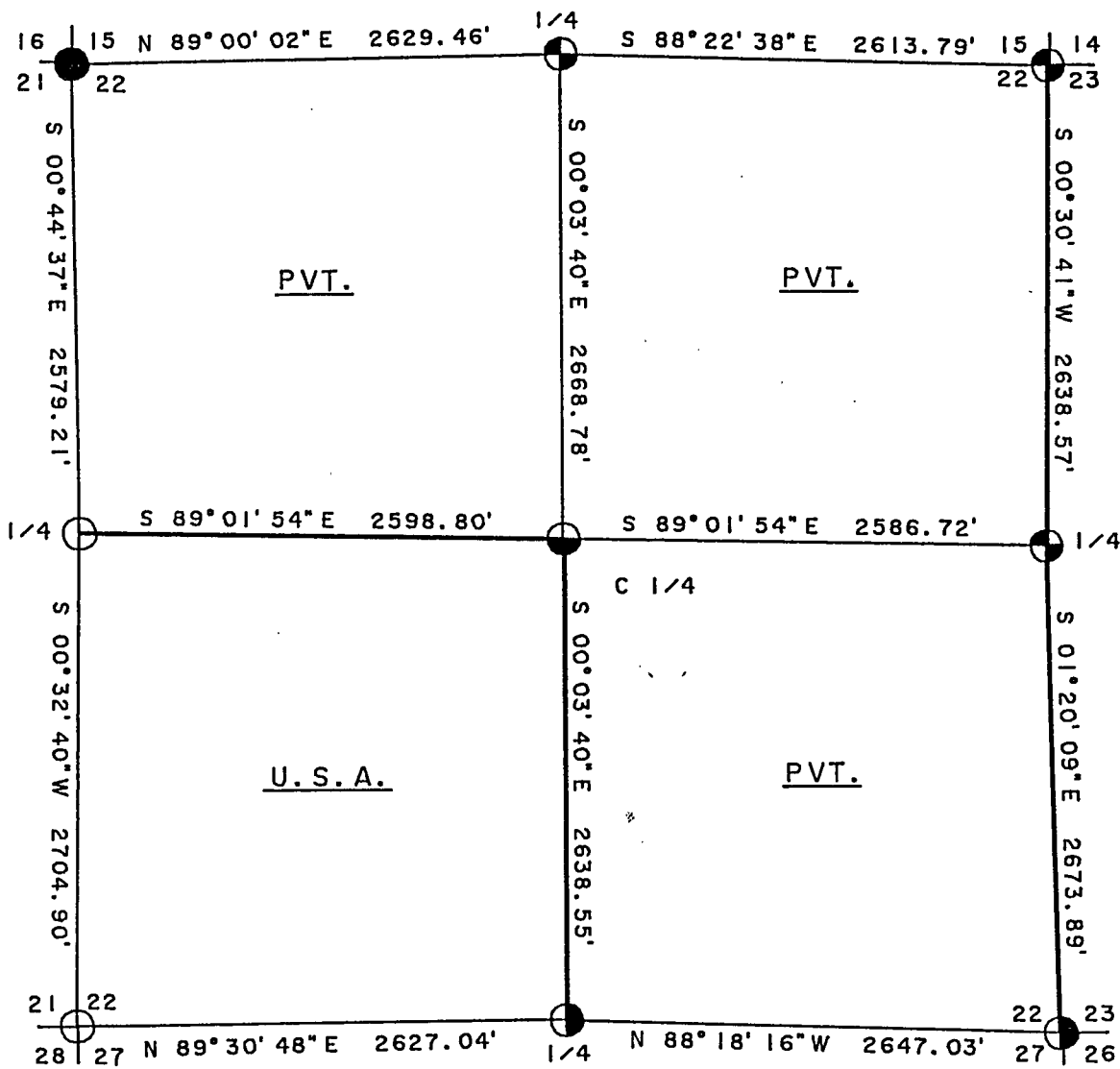
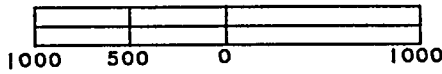

LEGEND

- RAILROAD SPIKE, SET THIS SURVEY.
- ◐ 1" x 36" ALUMINUM MONUMENT, SET THIS SURVEY.
- ◑ 2" IRON PIPE, FOUND IN PLACE.
- ⊕ 2 1/2" ALUMINUM MONUMENT, FOUND IN PLACE.
- RAILROAD SPIKE, FOUND IN PLACE.
- MARKED BOUNDARY LINES OF U.S. GOVERNMENT LANDS.

Stock No. 26273

Sheet 2 of 3

SURVEY NOTES

This survey was made by the U.S. Department of Agriculture, Forest Service, for the purpose of restoring and establishing corners on the perimeter of Section 22 for establishing subdivisional corners within Section 22 and for locating and marking the boundaries of U.S. Government land on their perimeter and within Section 22, Township 35 North, Range 15 East, 4th Principal Meridian, Forest County, Wisconsin.

The U.S. Government lands in this section were acquired in 1944.

The original government subdivision survey of this township was made in 1859. A subsequent survey was performed in 1904 by N. Smith.

The corner positions recovered, restored and established by this survey are marked by the monument described in the map legend.

The corner positions established were located to an accuracy of one part in 5000.

The bearings between corner positions are true bearings as determined by solar observations.

The field notes of this survey and a copy of this plat are on file in the Forest Supervisor's Office at Rhinelander, Wisconsin.

CORNERS RECOVERED OR RESTORED1. Corner Common to Sections 15, 16, 21, and 22.

Corner position recovered marked by a railroad spike set in County Hwy. "H" at the intersection of fence lines east and west. Believed to be a perpetuation of the original corner and accepted as such.

Corner References:

Sugar	5"	S.60°E.	76.35 feet (slope tape)
Power Pole	#3515 Z1E 10	S.77°W.	41.11 feet
Witness Corner	1"x 36"	West	47.21 feet
White Ash	8"	N.37°W.	89.42 feet
Steel Sign Post		West	48.21 feet

2. Corner Common to Sections 14, 15, 22, and 23.

Corner recovered as set by R. Widmar (BLM Surveyor), certificate on file in Forest County, document No. 140457.

3. Corner Common to Sections 22, 23, 26, and 27.

Corner recovered as set by Jean Resvick (R.L.S.), certificate on file in Forest County, document no. 131259.

4. Corner Common to Sections 21, 22, 27, and 28.

Corner position recovered at the intersection of center line roads North-South, and East, and fenceline West.

Corner References:

Elm	8"	N.50°E.	61.81 feet
Sugar	7"	S.37°E.	77.00 feet
Yellow Birch	6"	S.27°E.	75.65 feet
Witness Corner	2½"x 36"	West	35.10 feet
Steel Sign Post		West	35.63 feet

Stock No. 26273

Sheet 3 of 3

5. Quarter Corner Common to Sections 15 and 22.
Corner recovered as set by Milo Stefan (R.L.S.), certificate on file in Forest County, document no. 124187.

6. Quarter Corner Common to Sections 22 and 23.
Corner recovered as set by Anthony Carrow (B.L.M. Surveyor).
Corner References:

Sugar	9"	S.11°E.	15.89 feet
Sugar	10"	S.74°W.	29.54 feet
Sugar	12"	N.71°W.	18.30 feet
Steel Sign Post		Northeast	0.61 feet

7. Quarter Corner Common to Sections 22 and 27.
Corner recovered as set by Jean Resvick (R.L.S.), certificate on file in Forest County, document no. 131260.

8. Quarter Corner Common to Sections 21 and 22.
Corner position recovered at the intersection of center line County Hwy. "H" at intersection of fencelines east and west.
Corner References:

Witness Corner	2"x 36"	East	45.78 feet
Sugar	7"	S.51°E.	46.48 feet
Sugar	7"	N.82°W.	68.88 feet
Steel Sign Post		East	46.74 feet

CORNERS ESTABLISHED

1. Center Quarter Corner to Section 22.
Position established at the intersection of the north-south and east-west quarter lines of Section 22.
Corner References:

Balsam	7"	S.40°W.	23.69 feet
Basswood	5"	N.50°W.	14.62 feet
Steel Sign Post		South	1.09 feet

SURVEYOR'S AFFIDAVIT

State of Wisconsin] SS
County of Forest]

I, Alan D. Harrison, Land Surveyor, U.S.D.A. Forest Service and a Registered Land Surveyor in the State of Wisconsin, do hereby certify that I have surveyed and subdivided Section 22, Township 35 North, Range 15 East, Fourth Principal Meridian, State of Wisconsin.

The plat map and the notes herewith are a correct representation of the land surveyed and divided. I have surveyed and subdivided said section in accordance with the rules for survey of the public lands and with the statutes of the State of Wisconsin.

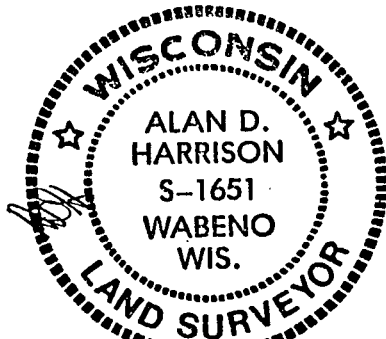

Date of Survey: 1991

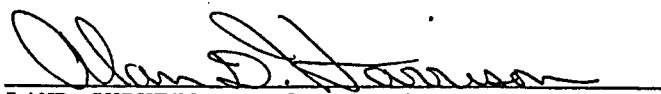
LAND SURVEYOR, U.S.D.A. Forest Service
R.L.S. Number S-1651
State of Wisconsin

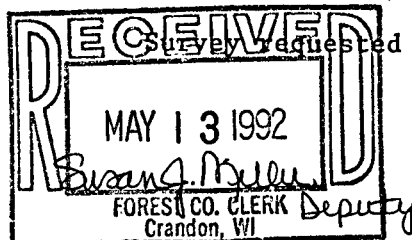

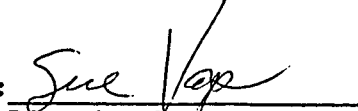
Survey requested by: 
District Ranger