

Section  
Corner  
16 15  
21 22

Being a Part of The  
**NW1/4-NW1/4, Section 22**  
**T 35 N, R 15 E**  
Town of Wabeno  
Forest County, Wisconsin

Bearings are based on  
the Section Line bearing  
of S 2°26'49"E from a  
Devon VandenHeuvel  
survey dated 8/13/1999.

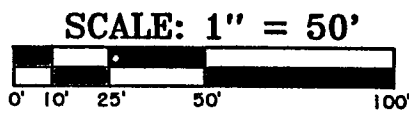

(66')

(405.11')

Iron rod had been  
knocked out by  
highway reconstruction

(N 90°00'00"E 283.70')  
(S 89°59'33"E 283.77')

(S 84°10'39"E 245.03')  
(S 84°04'03"E 244.99')

**3686 Chief Wabeka Drive**

53,638 Sq.Ft.  
1.23 Acres

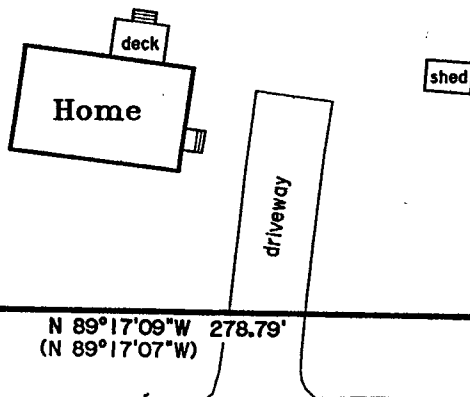

(S 00°01'21"W 192.43')  
(S 0°00'00"E 192.47')

Iron rod was bent by  
utility box installation  
and reset in the  
described position

(S 02°26'49"E  
(S 2°26'49"E

(N 01°29'40"W 189.06')

(N 87°33'11"E

Iron rod had been  
knocked out by  
highway reconstruction

(N 89°17'09"W 278.79')  
(N 89°17'07"W)

utility  
peds

County Hwy. H

(2174.72')  
2174.65')

Section Line

West 1/4  
Corner

existing pavement

**Chief Wabeka Drive**

(60')

**SURVEYOR'S CERTIFICATE**

" I HEREBY CERTIFY THAT I HAVE SURVEYED AND MAPPED  
THE LANDS SHOWN HEREON AND THAT, TO THE BEST OF MY  
KNOWLEDGE AND BELIEF, THIS SURVEY AND MAP IS A  
TRUE AND CORRECT REPRESENTATION THEREOF, AND THAT  
I HAVE COMPLIED WITH THE APPLICABLE REQUIREMENTS  
OF CHAPTER A-E 7 OF THE WISCONSIN ADMINISTRATIVE  
CODE, MINIMUM STANDARDS FOR PROPERTY SURVEYS.

DATED THIS 22nd DAY OF MARCH, 2012.

*Thomas A. Boettcher*  
THOMAS A. BOETTCHER, R.L.S. 1763

**-Legend-**

- ⊙ MAGNETIC P.K. NAIL SET IN PAVEMENT FROM REFERENCE MONUMENTS
- ⊗ 3/4" IRON RE-BAR FOUND IN PLACE
- 1" IRON PIPE SET
- △ COMPUTED ANGLE POINT
- ( ) BEARING & DISTANCE OF RECORD

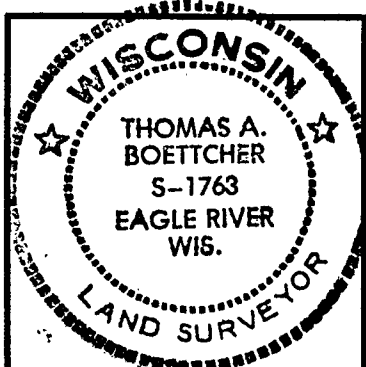

Survey For  
**Potawatomi Tribal Housing**  
5460 KakYok Lane  
Crandon, WI 54520

SCALE 1" = 50' DATE 3/22/2012 DWN. BY. TAB  
Drawing No. **E3689** Eagle Landmark Surveying, Inc.  
5035 Hwy. 70 West, Eagle River, WI 54521  
P&F (715)479-9610 eaglelandmark@frontier.com

*part of 28-1572*