

REVISIONS	BY

PARAGON ASSOCIATES
 Environmental Design & Consulting
 ARCHITECTURE, SURVEYING
 CIVIL ENGINEERING, LANDSCAPE ARCHITECTURE
 632 COPELAND AVENUE, LA CROSSE, WI 54603
 Tel: 608.781.3110 Fax: 608.781.3197 Paragon-Assoc.biz

PLAT OF SURVEY
SOUTHWEST QUARTER OF THE SOUTHWEST QUARTER (SE-SW)
SECTION 26, TOWNSHIP 36 NORTH, RANGE 12 EAST
TOWN OF CRANDON, FOREST COUNTY, WISCONSIN

DRAWN	J.K.S.
DATE SURVEYED	4-15-22
SCALE	1"=150'
CAD FILE	Kurt-2.dwg
PROJECT NUMBER	
SHEET	

DESCRIPTION

PARCEL A

A PARCEL OF LAND LOCATED IN THE SE-SW, OF SECTION 26, TOWNSHIP 36 NORTH, RANGE 12 EAST, TOWN OF CRANDON, FOREST COUNTY, WISCONSIN. DESCRIBED AS FOLLOWS:

COMMENCING AT THE SOUTH 1/4 OF SAID SECTION THENCE S87°34'52"W, 1035.98 FEET ALONG THE SOUTH LINE OF SAID SE-SW TO A POINT ON THE SOUTH LINE OF SAID SE-SW AND POINT OF BEGINNING; THENCE S87°34'52"W, 248.95 FEET TO THE SOUTHWEST CORNER OF SAID SE-SW; THENCE N02°14'52"E, 1215.55 FEET TO THE NORTHWEST CORNER OF SAID SE-SW; THENCE S88°14'46"E, 244.79 FEET ALONG THE NORTH LINE OF SAID SE-SW; THENCE S02°05'17"W, 1197.41 FEET TO THE SOUTH LINE OF THE SE-SW AND POINT OF BEGINNING.

SAID PARCEL CONTAINS 297,354.85 SQ.FT.± OR 6.826 ACRES±
 PARCEL IS SUBJECT TO ANY/ALL EASEMENTS IMPLIED AND/OR RECORDED.

PARCEL B

A PARCEL OF LAND LOCATED IN THE SE-SW, OF SECTION 26, TOWNSHIP 36 NORTH, RANGE 12 EAST, TOWN OF CRANDON, FOREST COUNTY, WISCONSIN. DESCRIBED AS FOLLOWS:

COMMENCING AT THE SOUTH 1/4 OF SAID SECTION THENCE S87°34'52"W, 550.87 FEET ALONG THE SOUTH LINE OF SAID SE-SW TO A POINT ON THE SOUTH LINE OF SAID SE-SW AND POINT OF BEGINNING; THENCE S87°34'52"W, 485.11 FEET; THENCE N02°05'17"E, 1197.41 FEET TO THE NORTH LINE OF SAID SE-SW; THENCE S88°14'46"E, 476.83 FEET ALONG THE NORTH LINE OF SAID SE-SW; THENCE S01°45'14"W, 1162.09 FEET TO THE SOUTH LINE OF THE SE-SW AND POINT OF BEGINNING.

SAID PARCEL CONTAINS 566,595.73 SQ.FT.± OR 13.007 ACRES±
 PARCEL IS SUBJECT TO ANY/ALL EASEMENTS IMPLIED AND/OR RECORDED.

PARCEL C

A PARCEL OF LAND LOCATED IN THE SE-SW, OF SECTION 26, TOWNSHIP 36 NORTH, RANGE 12 EAST, TOWN OF CRANDON, FOREST COUNTY, WISCONSIN. DESCRIBED AS FOLLOWS:

BEGINNING AT THE SOUTH 1/4 OF SAID SECTION THENCE S87°34'52"W, 550.87 FEET ALONG THE SOUTH LINE OF SAID SE-SW TO A POINT ON THE SOUTH LINE OF SAID SE-SW; THENCE N01°45'14"W, 1162.09 FEET TO A POINT ON THE NORTH LINE OF SAID SE-SW; THENCE S88°14'46"E, 577.47 FEET ALONG THE NORTH LINE OF SAID SE-SW TO THE NORTHEAST CORNER OF SAID SE-SW; THENCE S03°11'12"E, 1122.36 FEET ALONG THE EAST LINE OF SAID SE-SW TO THE POINT OF BEGINNING.

SAID PARCEL CONTAINS 643,193.85 SQ.FT.± OR 14.765 ACRES±
 PARCEL IS SUBJECT TO ANY/ALL EASEMENTS IMPLIED AND/OR RECORDED.

NOTE

OWNER HAS WAIVED THE MONUMENTATION OF KENDALL LANE PER AE-7.01(4)

Kurt Kincaid 8/5/2022
 KURT KINCAID

LEGEND

- SET MONUMENT (AS NOTED)
- FOUND SECTION CORNER (AS NOTED)
- FOUND MONUMENT (AS NOTED)
- ✕ COMPUTED CORNER

CERTIFICATE

I, JACOB K. STEPHENSON, PROFESSIONAL LAND SURVEYOR #3076, HEREBY CERTIFY THAT I HAVE SURVEYED AND MAPPED THE ABOVE PARCEL AT THE DIRECTION OF KURT KINCAID, AND THE ATTACHED MAP IS TRUE AND CORRECT TO THE BEST OF MY KNOWLEDGE AND BELIEF.

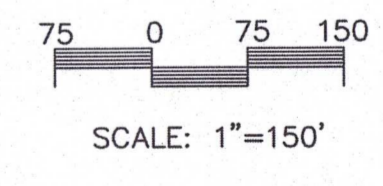
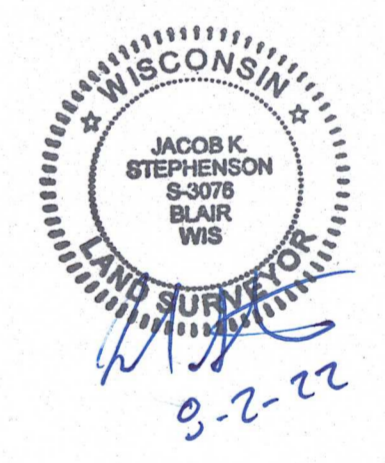

BASIS FOR BEARINGS
 SOUTH LINE OF THE SE-SW,
 SEC. 26, T36N, R12E,
 ASSUMED TO BEAR AS SHOWN.



FOUND 1-1/2" PIPE
 33.02' NORTH ON SECTION LINE
 WITNESS TO SECTION CORNER

FOREST CO SURVEYOR
 FILE # 362226-20220802
 DATE 08/05/2022 BY *J.S.*