



CENTER SEC. 35
C.A.M., FOUND

CORNER ESTABLISHED FROM PLAT
OF SURVEY BY MICHAEL E. WEBER
DATED 4-18-2006 & 12-6-2009



BEARINGS REFERENCED TO
ASSUMED N89°49'02"W
ALONG S. LINE, SE1/4 SEC. 35



NW-SE

33' WIDE EASEMENT FOR
INGRESS AND EGRESS &
UTILITIES FOR BENEFIT
OF ADJUTING OWNER
ON WEST SIDE. SAID
EASEMENT LOCATED
AT GATE AREA

SW-SE

LEGEND

- 3/4" x 18" IRON ROD, SET
- (M) MEASURED
- (R) RECORDED
- X— FENCE

LANDS BEING PART OF THE NW1/4
OF THE SE1/4 AND PART OF NE1/4
OF THE SE1/4, SECTION 35, T.36N.,
R.12E., TOWN OF CRANDON, FOREST
COUNTY, WISCONSIN

I, EUGENE C. UTTECH, REGISTERED LAND SURVEYOR OF THE
STATE OF WISCONSIN, HEREBY CERTIFY THAT I HAVE SURVEYED,
MAPPED AND DESCRIBED THE LANDS SHOWN ON THIS PLAT OF
SURVEY. THAT SAID PLAT IS A TRUE AND CORRECT
REPRESENTATION OF THE EXTERIOR BOUNDARIES OF LANDS
SURVEYED, AND THAT I HAVE FULLY COMPLIED WITH CHAPTER
A-E 7 OF THE WISCONSIN ADMINISTRATIVE CODE, TO THE BEST
OF MY KNOWLEDGE AND BELIEF.

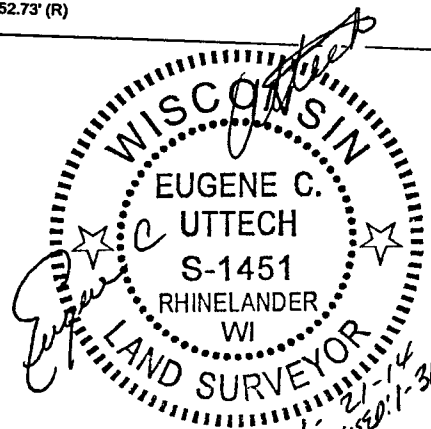

PARCEL 'D'
10.0 ACRES

NOTE:
PARCEL CONTAINS HOUSE
AND OUTBUILDINGS - NOT LOCATED



FOREST CO SURVEYOR
FILE # 361235-2014.0131
DATE BY

RECEIVED

JUL 22 16

CO. TREASURER

SE COR. SEC. 35-36-12
RR SPIKE, FOUND

S1/4 COR. SEC. 35
1 1/2" I.P., FOUND

SIPPLE ROAD

PROJECT NO.	SECTION	SCALE	AS SHOWN	DATE	REVISION

MSA PROFESSIONAL SURVEYING
TRANSPORTATION • MUNICIPAL
DEVELOPMENT • ENVIRONMENTAL
1326 N Stevens St., Rhinelander, WI 54501
715-382-3244 1-800-844-7854 Fax: 715-382-4118
Web Address: www.msa-ge.com
© 2014 Professional Surveying Inc.

PLAT OF SURVEY

PARCEL D
EVERGREEN LAND COMPANY CO FRED HAGENY
TOWN OF CRANDON, FOREST COUNTY, WISCONSIN

PLAT NO.	13027004
SHEET	1/2

DESCRIPTION PARCEL D

A parcel of land being part of the NW.1/4 of the SE.1/4 and part of NE.1/4 of the SE.1/4 of Section 35, T.36 N., R.12 E., Town of Crandon, Forest County, Wisconsin and being more particularly described as follows:

Commencing at the Southeast corner of said Section 35; thence N.5°09'32"E., along the East line of said SE.1/4, a distance of 1262.23 feet to the Southeast corner of said NE.1/4 of the SE.1/4; thence N.88°38'58"W., along the South line of said NE.1/4 of the SE.1/4, a distance of 58.87 feet to a 3/4 inch diameter iron rod set on the West right-of-way line of CTH "S" and being the point of beginning of parcel to be described; thence continuing N.88°38'58"W., along said South line of the NE.1/4 of the SE.1/4 and the South line of the NW.1/4 of the SE.1/4, a distance of 1285.24 feet to a 3/4 inch diameter iron rod set; thence N.03°55'29"E., a distance of 275.63 feet to a 3/4 inch diameter iron rod set; thence N.85°39'34"E., a distance of 1041.31 feet to a 3/4 inch diameter iron rod set; thence S.88°38'48"E., a distance of 266.03 feet to a 3/4 inch diameter iron rod set on said West right-of-way line of CTH "S"; thence S.05°46'59"W., along said right-of-way line, a distance of 379.74 feet to the point of beginning.

Said parcel contains 10.00 acres, more or less.

Said parcel being subject to a 33' wide easement for ingress and egress and utilities for the benefit of owner of land abutting on the West side. Said easement located at the gate area in the Southwest corner of the above described lands.

Project No. 13027005
Sheet 2 of 2 Sheets

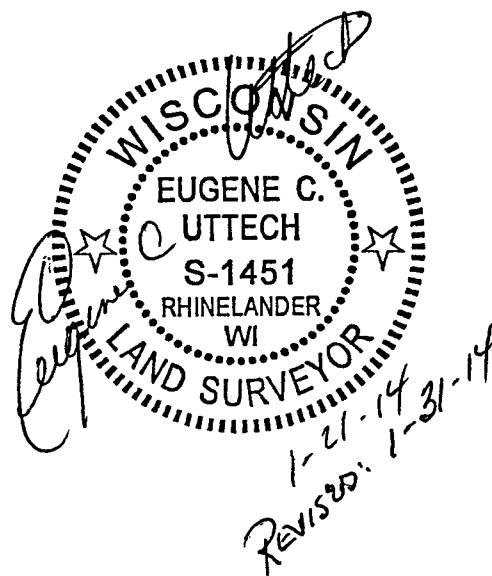

S87°35'54"E
N88°46'58"W

1350.88' (M)
1350.73' (R)

S87°29'57"E
N88°41'01"W
1352.68' (M)
1352.73' (R)

E1/4 SEC. 36
PK NAIL, FOUND

CENTER SEC. 35
C.A.M., FOUND

CORNER ESTABLISHED FROM PLAT
OF SURVEY BY MICHAEL E. WEBER
DATED 4-18-2008 & 12-8-2009



BEARINGS REFERENCED TO
ASSUMED N89°49'02"W
ALONG S. LINE, SE1/4 SEC. 35

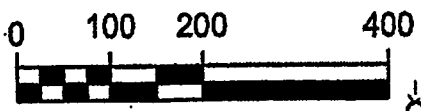

LANDS BEING PART OF THE NW1/4
OF THE SE1/4 AND PART OF NE1/4
OF THE SE1/4, SECTION 35, T.36N.,
R.12E., TOWN OF CRANDON, FOREST
COUNTY, WISCONSIN

I, EUGENE C. UTTECH, REGISTERED LAND SURVEYOR OF THE
STATE OF WISCONSIN, HEREBY CERTIFY THAT I HAVE SURVEYED,
MAPPED AND DESCRIBED THE LANDS SHOWN ON THIS PLAT OF
SURVEY. THAT SAID PLAT IS A TRUE AND CORRECT
REPRESENTATION OF THE EXTERIOR BOUNDARIES OF LANDS
SURVEYED, AND THAT I HAVE FULLY COMPLIED WITH CHAPTER
A-E 7 OF THE WISCONSIN ADMINISTRATIVE CODE, TO THE BEST
OF MY KNOWLEDGE AND BELIEF.

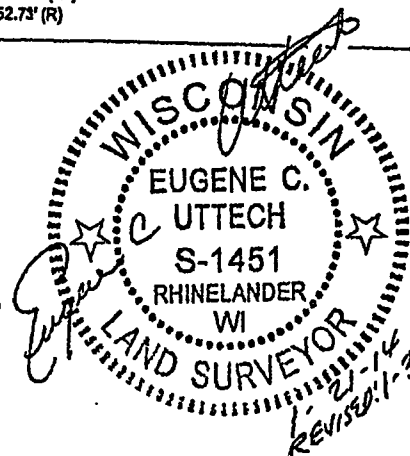

PARCEL 'D'
10.0 ACRES

NOTE:
PARCEL CONTAINS HOUSE
AND OUTBUILDINGS - NOT LOCATED

33' WIDE EASEMENT FOR
INGRESS AND EGRESS &
UTILITIES FOR BENEFIT
OF ADJUTING OWNER
ON WEST SIDE, SAID
EASEMENT LOCATED
AT GATE AREA

LEGEND

- 3/4" x 18" IRON ROD, SET
- (M) MEASURED
- (R) RECORDED
- X— FENCE

GARAGE

CTH'S

FOREST CO SURVEYOR
FILE # 361235-20140131
DATE _____
BY _____

Review by Eugene Uttech for the

S1/4 COR. SEC. 35
1 1/2" I.P., FOUND
1311.31'
N89°47'02"W

2622.62'

SIPPLE ROAD

1311.31'

SE COR. SEC. 35-36-12
RR SPIKE, FOUND

NO.	DATE	BY	REVISION

MSA
 SURVEYING & ENGINEERING
 1425 N. Lincoln St., Rhinelander, WI 54581
 715-362-0214 715-362-0215 Fax 715-362-0218
 Web Address: www.msa-wi.com

PLAT OF SURVEY

PARCEL D
EVERGREEN LAND COMPANY C/O FRED HAGENY
TOWN OF CRANDON, FOREST COUNTY, WISCONSIN

PLAT NO.
13027004
SHEET
1/2