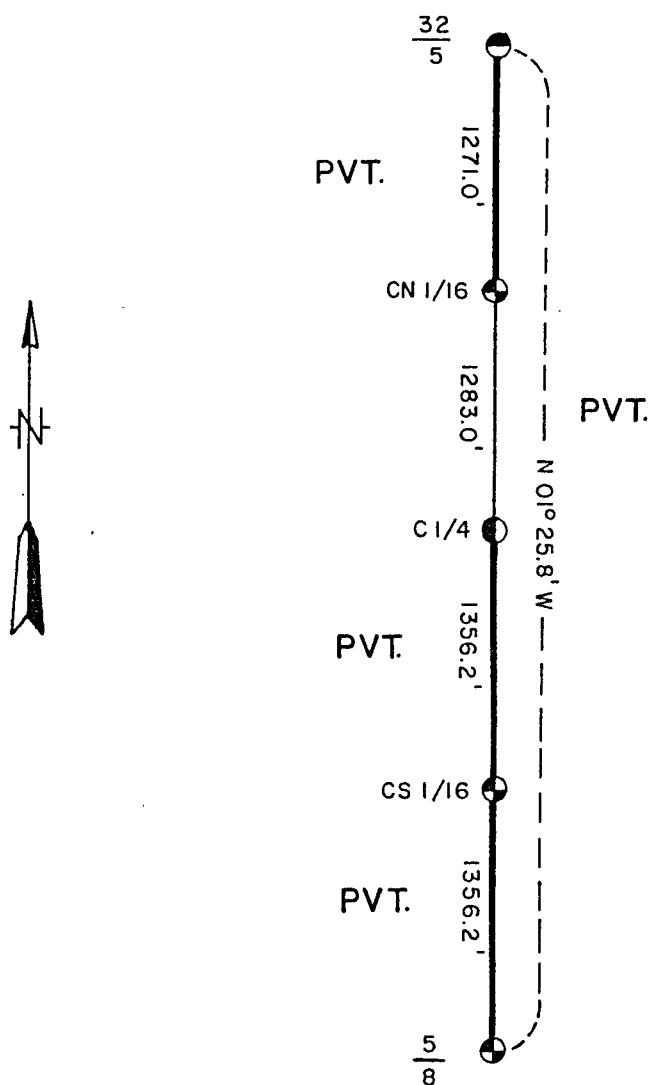
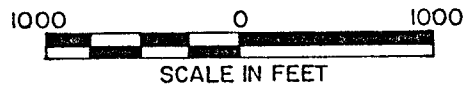

Stock No. 26273

SHEET 1 OF 3

CERTIFIED LAND CORNER RESTORATION

Being Corners on the North-South Quarter Line of Section 5
Township 36 North, Range 15 East, Fourth Principle Meridian
FOREST COUNTY, WISCONSIN

**LEGEND**

- 2" Aluminum Monument, 30" Long.
- ⊕ 2" Aluminum Monument, 36" Long.
- ⊙ 2" Aluminum Monument, 60" Long.
- U.S. Government Boundry Line to Standard.

Conversion Factor:
Feet to Meters - 0.304801
Meters to Feet - 3.280833

Stock No. 26273

Sheet 2 of 3

SURVEY NOTES

This survey was made by the U. S. Department of Agriculture, Forest Service, for the purpose of restoring and establishing corners on the north-south quarter line of Section 5, for establishing subdivisional corners within Section 5, and for locating and marking the boundaries of U. S. Government lands on the north-south quarter line of Section 5, Township 36 North, Range 15 East, Fourth Principal Meridian, Forest County, Wisconsin.

The U. S. Government lands in this section were acquired in 1935.

The original Government subdivision survey of this township was made in 1857. About 1915, a subdivision survey of this section was conducted by John J. Melindy. Felix Alderton assisted Melindy with this survey.

The corner positions recovered, restored, and established by this survey are marked by the monument described in the map legend.

The corner positions established were located to an accuracy of one part in 3000.

The bearings between corner positions are true bearings as determined by solar observations.

The field notes of this survey and a copy of this plat are on file in the Forest Supervisor's Office at Rhinelander, Wisconsin.

CORNERS RECOVERED AND RESTORED1. Quarter Corner to Sections 5-32, T.36-37N., R.15E.

Corner position found marked by a 1½" x 18" iron pipe in post hole with 6" x 6" x 24" very rotten Cedar post alongside pipe. Stump holes of original bearing trees found at proper bearing and distance.

Corner References:

Sugar Maple	4"	N.65°E.	20.39 feet
Sugar Maple	4"	S.89°W.	34.59 feet
Basswood	11"	N.5°W.	12.53 feet
Steel Sign Post		North	1.00 feet

2. Quarter Corner to Sections 5-8, T.36N., R.15E.

Corner position restored by extending the north-south quarter line in Section 5 from north quarter through center north one-sixteenth, center quarter, and center south one-sixteenth southerly to this corner position. The center quarter, center north one-sixteenth, and center south one-sixteenth were set by J. J. Melindy in 1915; we found the center north one-sixteenth, center quarter, and center south one-sixteenth to be in alignment and at proper proportional positions.

Corner References:

Power Pole #349-3615-5R1		N.13°E.	31.24 feet
Sugar Maple	8"	N.48°E.	77.58 feet
Sugar Maple	9"	S.37°E.	62.97 feet
Steel Sign Post		South	13.70 feet

Stock No. 26273

Sheet 3 of 3

3. Center Quarter Corner to Section 5, T.36N., R.15E.

Corner position found marked by an iron pipe with post alongside. J. J. Melindy set this corner for Felix Alderton's father in about 1915; Felix helped Melindy and found the post point in the fall of 1981. He placed an iron pipe alongside post.

Corner References:

White Birch	8"	N.51°E.	39.03 feet
Red Maple	4"	S.52°E.	36.44 feet
Black Ash	4"	S.34°W.	9.70 feet
Steel Sign Post		South	1.50 feet

4. Center North One-Sixteenth Corner to Section 5, T.36N., R.15E.

Corner position found marked with 1" iron pipe with rotted wood post with some scribing visible. Post set by J. J. Melindy survey ±1915 and iron pipe set by Felix Alderton in 1981 to save corner position.

Corner References:

Red Maple	4"	S.82°E.	58.68 feet
Red Maple	8"	S.07°W.	12.48 feet
Black Spruce	6"	N.04°W.	20.38 feet
Steel Sign Post		North	1.50 feet

5. Center South One-Sixteenth Corner to Section 5, T.36N., R.15E.

Corner position found marked with an iron pipe and scribed squared post in mound of stone. Post set by J. J. Melindy in ±1915 and iron pipe set by Felix Alderton in 1981 to save corner position.

Corner References:

Oak	9"	N.49°E.	18.19 feet
Oak	9"	S.05°E.	17.35 feet
Sugar Maple	8"	N.53°W.	19.01 feet
Steel Sign Post		South	3.90 feet

SURVEYOR'S AFFIDAVIT

State of Wisconsin]
County of Forest] SS

I, Milo E. Stefan, Cadastral Surveyor, U. S. Forest Service, and a registered surveyor in the State of Wisconsin, hereby certify that I have surveyed and subdivided Section 5, Township 36 North, Range 15 East, Fourth Principal Meridian, State of Wisconsin.

The plat map and the notes herewith are a correct representation of the land surveyed and divided. I have surveyed and subdivided said section in accordance with the rules for survey of the public lands and with the statutes of the State of Wisconsin.



Date of Survey: 1982

Milo E. Stefan

Cadastral Surveyor, U. S. Forest Service
R.L.S., State of Wisconsin
Certificate S-1558

Plat Ready For Filing: *Dale B. Stange*

District Ranger

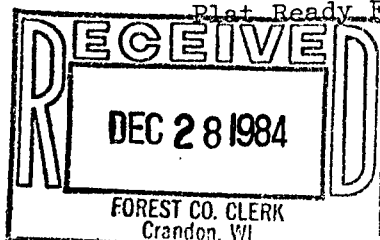

Sallie L. Deen

Deputy Co. Clerk