

PART OF THE SE 1/4 - SE 1/4 OF SECTION 6,
T36N, R15E, TOWN OF LAONA, FOREST COUNTY, WISCONSIN.

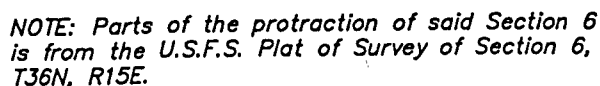

Bearings are referenced to the U.S.F.S. Plat of Survey of Section 6, the South Line of the SE 1/4 bears N 89°01'12" E.

I, Michael A. Trembl, Registered Land Surveyor, HEREBY certify that by the order of Frederick Alderton: I have surveyed, divided and mapped the hereon described and depicted lands and the within map is a true and correct representation of the lands surveyed to the best of my knowledge and belief.

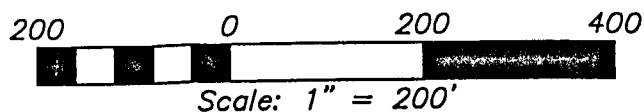

Michael A. Tremblé 12/10/04
Michael A. Tremblé, R.L.S. No. 2197 Date :

DWG. NO.: 2038-04 DRAWN BY: K.R.M. CHECKED BY: M.A.T.	☉ EXISTING 2" ALUMINUM PIPE MONUMENT	SHT. NO. 1 OF 2
	● EXISTING FOREST COUNTY MONUMENT OF RECORD (AS NOTED)	
	☉ SET P.K. NAIL () U.S.F.S DIMENSION	
	☉ SET 1" X 36" IRON PIPE ▲ COMPUTED POSITION	