

NW COR. SEC. 29  
South Line of SW 1/4 Sec. 20  
(U.S.F.S. Plot - S 89°57'48" W)  
S 89°57'48" W  
2645.15'  
(U.S.F.S. Plot - 2645.29')

Gov't  
SEC. 20  
SEC. 29  
Gordon Connor  
GOV'T LOT 1  
N 89°35'01" W  
1572.71'  
GOV'T LOT 3  
Melissa Pierce Demopoulos  
VOL. 216 - PG. 389-391

Meander Corner  
Waters Edge  
S 08°10'20" W  
144.11'

# PLAT OF SURVEY

FOR MELISSA PIERCE DEMOPOULOS

PART OF GOVERNMENT LOT 3 OF SECTION 29,  
TOWNSHIP 36 NORTH, RANGE 15 EAST, TOWN  
OF LAONA, FOREST COUNTY, WISCONSIN

## STATEMENT BY LAND OWNER

As owner of said lands shown hereon,  
Being surveyed by Michael A. Tremi,  
Land Surveyor No. S-2197, I hereby waiver  
Parts of the Wisconsin Administrative Code  
A-E 7, said parts being 7.03, 7.04 & 7.05 (2).

*Melissa Pierce Demopoulos* 2/11/03  
Owner Date

LOT

1145.86' LAKE FRONTAGE  
(Recorded As - 1138.0')

BIRCH LAKE

Bearings are referenced to the U.S.F.S. Plat  
of Survey of Section 20, T36N, R15E. The  
South line of the SW 1/4 bears S 89°57'48" W.

GOV'T

Melissa Pierce Demopoulos  
Vol. 224 - Pg. 55

100 0 100  
Scale 1" = 100'

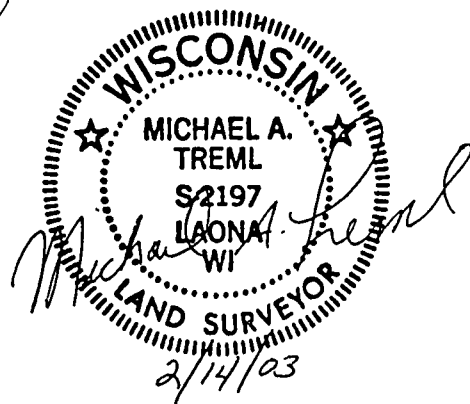

## SURVEYOR'S CERTIFICATE:

I, Michael A. Tremi, Registered Land Surveyor, HEREBY certify  
that by the order of Melissa Pierce Demopoulos, Trustee: I have  
surveyed and mapped the hereon depicted shoreline of Birch Lake  
and that this map is a true and correct representation of the  
lands surveyed to the best of my knowledge and belief.

## LEGEND:

- 2 1/2" DIA. ALUMINUM CAPPED PIPE MONUMENT FOUND
- 2" DIA. IRON PIPE W/STAMPED BRASS TABLET FOUND
- 3/4" DIA. IRON PIPE FOUND
- △ COMPUTED ANGLE POINT

SHT. NO.

1 of 1

DATE: FEBRUARY 14, 2003

DWG. NO.: 315-03