

30-36-15

SURVEY OF THE SOUTH 61.5 FEET OF LOT 1, BLOCK F,
CONNOR FIRST ADDITION, SECTION 30, T36N R15E,
TOWN OF LAONA, FOREST COUNTY WISCONSIN

FOR
LOYD JOHNVIN

NW CORNER
SECTION 30
NAIL IN PAVT

NORTH LINE LOT 4, BLOCK F
N 89°41'35"W 150.48'

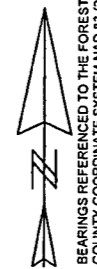

18' ALLEY

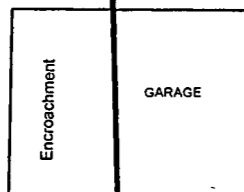

18-52
• 006.001.01

S 61.5' OF LOT 1 BLOCK F
CONNOR FIRST ADDITION
8910 SQ. FT.
0.20 ACRES

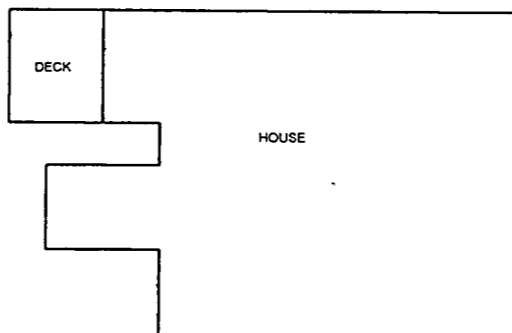

25'

25'

USH 8 (MAPLE STREET)

WEST LINE SECTION 30, T36N R15E
4698.34'

5243.12'

S 0°05'32"W 544.78'

SW CORNER
SECTION 30
PK NAIL IN PAVT

N 89°41'35"W 712.07'

N 89°41'35"W
145.80'

154.45'

S 0°27'04"W
61.50'

143.93'

ALLEY

18' ALLEY

GRAPHIC SCALE

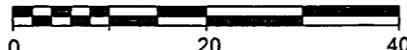

LEGEND

- FOREST COUNTY PLSS, AS NOTED
- 1-1/2 INCH IRON PIPE, FOUND
- 3/4 INCH REBAR, SET

