

CERTIFIED BOUNDARY LINE ESTABLISHMENT

U. S. GOVERNMENT LANDS
 BEING THE WEST LINE OF SECTION 19 AND THE NORTH 1/2
 OF THE WEST LINE OF SECTION 30; TOWNSHIP 36 NORTH
 RANGE 16 EAST; FOURTH PRINCIPAL MERIDIAN;
 FOREST COUNTY, WISCONSIN.

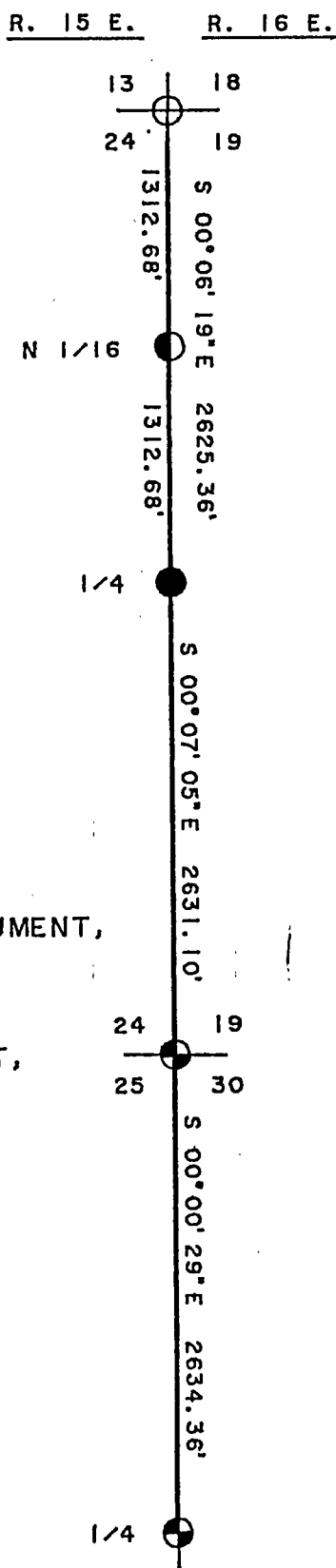

LEGEND

- 2" BRASS CAPPED MONUMENT, FOUND IN PLACE.
- ⊕ 2 1/2" ALUMINUM MONUMENT, FOUND IN PLACE.
- 2 1/2" X 36" ALUMINUM MONUMENT, SET THIS SURVEY.
- ⊙ 1" X 36" ALUMINUM MONUMENT, SET THIS SURVEY.
- MARKED BOUNDARY LINES OF U. S. GOVERNMENT LANDS.

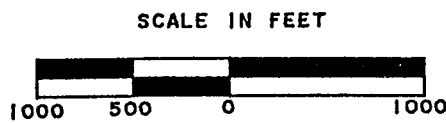
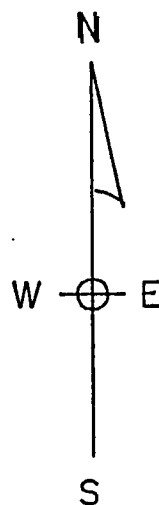

Stock No. 26273

Sheet 2 of 3

SURVEY NOTES

This survey was made by the U. S. Department of Agriculture, Forest Service, for the purpose of restoring and establishing corners on the west boundary of Sections 19 and 30, and for locating and marking the boundaries of U. S. Government land on the west boundary of Sections 19 and 30, Township 36 North, Range 16 East, Fourth Principal Meridian, Forest County, Wisconsin.

The U. S. Government lands in these sections were acquired in 1935.

The original government survey of this township was made in 1857 and 1858. John Melendy surveyed Section 19 in 1917.

The corner positions recovered, restored and established by this survey are marked by the monument described in the map legend.

The corner positions established were located to an accuracy of one part in 5000.

The bearings between corner positions are true bearings as determined by solar observations.

The field notes of this survey and a copy of this plat are on file in the Forest Supervisor's Office at Rhinelander, Wisconsin.

CORNERS RECOVERED OR RESTORED

1. Corner common to Sections 13, 18, 19, and 24, T.36N., R.15-16E.
Corner restored by retracement of John Melendy's 1917 survey from his quarter corner south through to north sixteenth corner.
Corner references:

Sugar	6"	N.78°E.	30.19 feet
Sugar	7"	S.10°E.	32.09 feet
Sugar	7"	S.49°W.	26.72 feet
Sugar	9"	N.39°W.	62.88 feet
Steel Sign Post		Northeast	1.18 feet

2. Corner common to Sections 19, 24, 25, and 30, T.36N., R.15-16E.
Corner recovered by William Cochrane, R.L.S. Certificate on file in Forest County.

3. Quarter corner to Sections 19 and 24, T.36N., R.15-16E.
Corner recovered by Jean REsvick, R.L.S. Certificate on file in Forest County.

4. Quarter corner to Sections 25 and 30, T.36N., R.15-16E.
Corner recovered by Milo Stefan, R.L.S. Certificate on file in Forest County.

5. North sixteenth corner to Sections 19 and 24, T.36N., R.15-16E.
Corner found marked by squared wood post, 2" iron pipe, and Melendy's Cedar B.T.

Corner references:

Cedar	2"	S.22°E.	5.02 feet
Cedar	15"	N.89°W.	23.36 feet
Steel Sign Post		South	0.73 feet



Stock No. 26273

SURVEYOR'S AFFIDAVIT

State of Wisconsin
County of Forest]

I, Alan D. Harrison, Land Surveyor, U.S.D.A. Forest Service and a Registered Land Surveyor in the State of Wisconsin, do hereby certify that I have surveyed the west line of Sections 19 and 30, Township 36 North, Range 16 East, Fourth Principal Meridian, State of Wisconsin.

The plat map and the notes herewith are a correct representation of the land surveyed and divided. I have surveyed and subdivided said section in accordance with the rules for survey of the public lands and with the statutes of the State of Wisconsin.

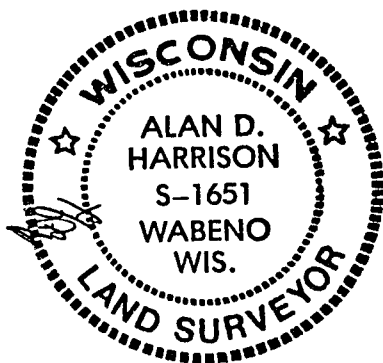

Alan D. Harrison

LAND SURVEYOR, U.S.D.A Forest Service
R.L.S. Number S-1651
State of Wisconsin

Plat Ready for Filing:

Paul B. Staege

District Ranger

Date of Survey: 1990

