

Stock No. 26273

PLAT OF SURVEY FOR CERTIFIED LAND CORNER RESTORATION AND ESTABLISHMENT OF U.S. GOVERNMENT LAND

BEING THE CORNERS FOR THE NW 1/4, THE W 1/2 OF THE NE 1/4, THE N 1/2 OF THE SW 1/4 AND THE SW 1/4 OF THE SW 1/4.
SECTION 4, T37N, R12E, FOURTH PRINCIPAL MERIDIAN
FOREST COUNTY, STATE OF WISCONSIN

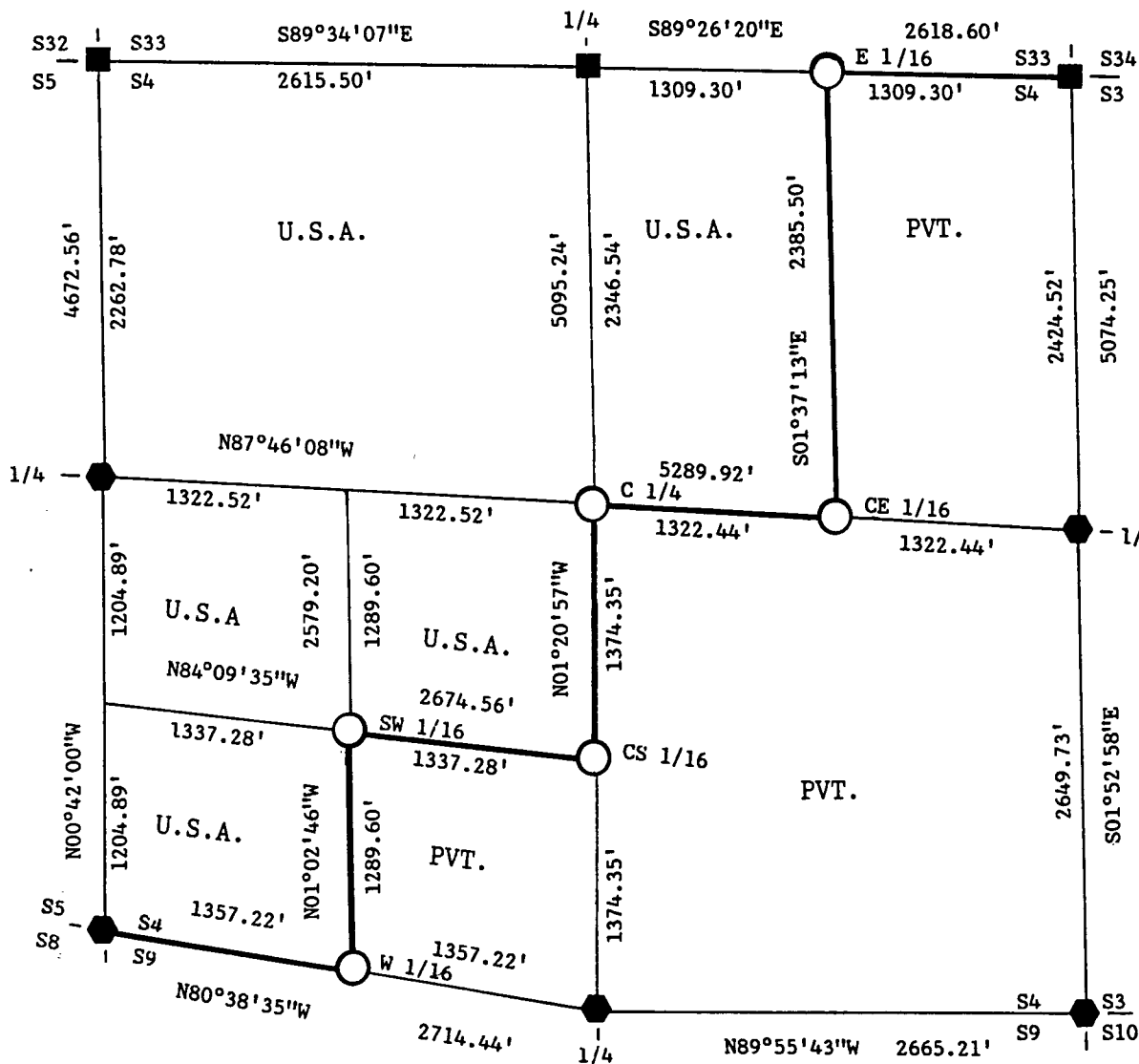

SCALE: 1"=1000'

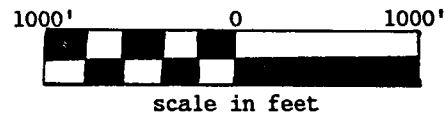

LEGEND

- Boundary line marked to standard.
- 1 inch diameter aluminum pipe monument, 36 inches long with an aluminum cap stamped to identify the corner.
- ◐ 2 1/2 inch diameter aluminum pipe aluminum, 36 inches long with an aluminum cap stamped to identify the corner.
- General Land Office Dependent Resurvey Monuments.

NOTE: Bearings are referenced to solar observations.

FOREST CO SURVEYOR
FILE # 371204-19860922
DATE _____ BY _____

Stock No. 26273

Sheet 2 of 5

SURVEY NOTES

This survey was made by John C. Schulke, a Registered Land Surveyor in the State of Wisconsin, for the U.S. Department of Agriculture, Forest Service. The purpose of the survey was for recovery, establishing, marking and perpetuating the corners and boundary lines of the U.S. Government Land on the perimeter and within Section 4, Township 37 North, Range 12 East, Fourth Principal Meridian, Forest County, Wisconsin.

The original Government survey of the township boundary was done by Alfred Millard, a U.S. Deputy Surveyor, in May and June of 1858. The original Government subdivision survey of this township was done by William E. Daugherty in 1859. A Dependent Resurvey on the North Township line was done by Mr. Wesson Cook and was approved by the General Land Office in 1937. The control for this North township line survey is based on the 1937 Dependent Resurvey.

The bearings between corner positions are true bearings as determined by reference to solar observations. The accuracy of this survey exceeds the State requirement for closure of 1 in 3,000. Corners recovered or established by this survey are marked as described in the map legend. Each monumented corner is referenced to blazed, scribed, painted and tagged bearing trees. Tie bearings are magnetic, and not corrected for declination.

CORNERS RECOVERED AND RESTORED1. Section Corner Common to Sections 4, 5, 32 and 33.

Corner monument recovered in place. A square post marked with metal tags was found beside the monument. The center of Wisconsin Highway 32 is S20°W 310 feet. The highway bears N70°W. The only trees available in this area is listed below.

New Corner References:

Spruce	4"	N28°E	50.98 feet
Tamarack	3"	N35°E	38.76 feet
Spruce	5"	N32°W	69.78 feet
Steel sign post		NE	0.7 feet

2. Quarter Corner Between Sections 4 and 33.

Corner monument recovered in place. Forest Service Road #2184 intersects the Section line West 896 feet of the corner.

Corner References:

Dead Hemlock	12"	S52°W	31.7 feet
Maple stump	12"	N69°W	9.2 feet

New Corner References:

Sugar Maple	5"	N17°W	17.24 feet
Sugar Maple	9"	N26°E	32.98 feet
Sugar Maple	13"	N89°E	23.68 feet
Sugar Maple	8"	S12°W	13.08 feet
Steel sign post		SE	1.0 feet

3. Section Corner Common to Sections 3, 4, 33 and 34.

Recovered 1937 B.L.M. concrete monument, leaning Southeasterly, reset and placed firmly as possible in the ground. Square post was laying beside the monument. Cedar tree used as a fence post corner is Southeast approximately 17.85 feet of the monument. Two track running North and South is East 40 feet of the corner.

Stock No. 26273

Sheet 3 of 5

Corner References:

Cedar	10"	N81°W	27.1	feet
Cedar stump	10"	S70°E	20.5	feet
Decayed Cedar stump	8"	S57°W	24.5	feet

New Corner References:

Cedar	12"	N12°W	18.84	feet
Cedar	5"	S24°E	14.17	feet
Cedar	10"	S48°W	10.75	feet
Steel sign post		NW	1.0	feet
Square wooden post		SE	1.6	feet

4. Quarter Corner Between Sections 3 and 4.

Corner position restored by single proportionate measurement between the Northeast and the Southeast Section corners of Section 4.

Corner References:

Elm	8"	N07°E	26.25	feet
White Pine	35"	S01°W	94.52	feet
Apple tree	11"	S51°E	111.4	feet
Steel sign post		NW	1.0	feet

5. Section Corner Common to Sections 3, 4, 9 and 10.

Recovered aluminum pipe monument in place and as described on Certified Land Corner Restoration form in the Forest County records, Document #130686, in 1986 by William Cochrane (S-1107).

6. Quarter Corner Between Sections 4 and 9.

Corner position restored as an obliterated corner at the intersection of an old boundary fence line. Monument next to a fence corner running North South and East. Old fence bears N80°W along Section line to the West.

Corner References:

Red Maple	8"	N52°W	55.93	feet
Tamarack	5"	S11°W	93.95	feet
Triple Red Maple	6"	N21°E	48.68	feet
Tamarack	4"	S28°E	67.22	feet
Steel sign post		NE	0.8	feet

7. Section Corner Common to Sections 4, 5, 8 and 9.

Corner monument recovered in place and as described on Certified Land Corner Restoration form in the Forest County records, Document #124239, in 1982 by Milo Stefan (S-1558).

8. Quarter Corner Between Sections 4 and 5.

Corner position restored by single proportionate measurement between the Northwest and the Southwest Section corners of Section 4. The center of the existing road N50°W 29 feet from the corner.

Corner References:

Sugar Maple	8"	N83°W	8.15	feet
Sugar Maple	9"	S53°W	25.13	feet
Sugar Maple	7"	S55°E	7.16	feet
Sugar Maple	12"	N10°W	19.78	feet
Steel sign post		SE	0.9	feet

Stock No. 26273

Sheet 4 of 5

CORNERS ESTABLISHED1. East Sixteenth Corner Between Section 4 and 33.

Corner position is established at the midpoint and on line between the North Quarter corner and the Northeast Section corner of Section 4. The fence corner N44°E 9.6 feet which the fence line runs East and South. The monument is half way down the North side of the hill.

Corner References:

Sugar Maple	9"	S75°W	20.62 feet
Sugar Maple	8"	N45°E	16.87 feet
Sugar Maple	6"	N61°W	27.41 feet
Steel sign post		NW	0.6 feet

2. Center Quarter Corner of Section 4.

Corner position is established at the intersection of the straight lines between opposing Quarter corners on the perimeter of Section 4. Open field to the East of the corner and a fence line running North-South N87°W 44 feet of the monument.

Corner References:

Aspen	4"	S04°W	69.47 feet
Balsam	7"	S56°W	32.58 feet
Twin Sugar Maple	7"	N87°W	46.19 feet
Steel sign post		NW	0.7 feet

3. Center East Sixteenth Corner of Section 4.

Corner position is established at the midpoint and on line between the East Quarter corner and the Center Quarter corner of Section 4. Monument is South 0.3 feet from fence line running N45°W. The fence corner lies N45°W 54.7 feet from the corner.

Corner References:

Red Maple	12"	S04°E	17.17 feet
Red Maple	7"	N23°W	38.58 feet
Red Maple	10"	S61°W	18.29 feet
Steel sign post		SW	0.4 feet

4. Center South Sixteenth Corner of Section 4.

Corner position is established at the midpoint and on line between the South Quarter corner and the Center Quarter corner of Section 4. The fence corner is S02°W 97 feet from the monument. Fence line running North-South is West 26.3 feet of the corner.

Corner References:

Sugar Maple	8"	N67°E	20.06 feet
Sugar Maple	8"	S22°W	17.83 feet
Sugar Maple	5"	N68°W	10.89 feet
Steel sign post		SE	1.0 feet

5. Southwest Sixteenth Corner of Section 4.

Corner position is established at the intersection of the straight lines between opposing sixteenth corners on the perimeter of the Southwest Quarter of Section 4.

Corner References:

Cedar	14"	S54°E	10.69 feet
Twin Sugar Maple	8"	N45°E	12.76 feet
Triple Sugar Maple	6"	N58°W	12.06 feet
Steel sign post		NW	1.0 feet

Stock No. 26273

Sheet 5 of 5

6. West Sixteenth Corner Between Sections 4 and 9.

Corner position is established at the midpoint and on line between the South Quarter corner and the Southwest Section corner of Section 4.

Recovered 1 1/4" diameter iron pipe is N50°W 3.3 feet from the monument.

Corner References:

White Birch	16"	N10°W	8.85 feet
Balsam	19"	S38°W	43.85 feet
Aspen	9"	N62°E	26.00 feet
Steel sign post		NE	0.8 feet

SURVEYOR'S AFFIDAVIT

State of Wisconsin)
County of Forest)^{ss}

I, John C. Schulke, a Cadastral Surveyor, and a Registered Land Surveyor in the State of Wisconsin, hereby certify that I have surveyed and subdivided Section 4, Township 37 North, Range 12 East, Fourth Principal Meridian, State of Wisconsin.

The plat and survey notes herewith are a correct representation of the land surveyed and subdivided. I have surveyed and subdivided said section in accordance with the rules for the survey of the public lands and with the statutes of the State of Wisconsin.

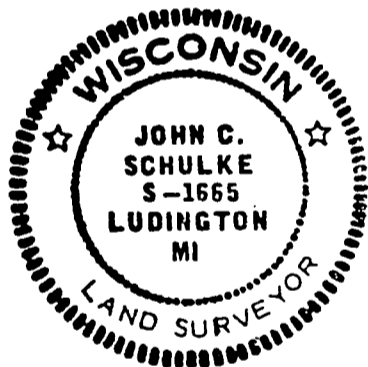

John C. Schulke
4604 South U.S.-31
Ludington, Michigan 49431
R.L.S. State of Wisconsin
Date of Survey 1986
Certificate S-1665

John C. Schulke
9-22-86

Plat ready for filing: *Dale B. Staege*

District Ranger

2/24/87

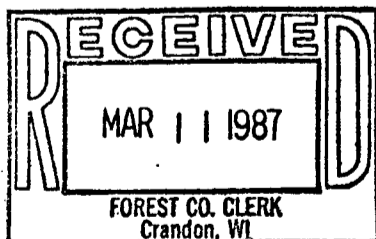

Dora C. James
County Clerk