

Being a part of the
Northeast 1/4 of the Southwest 1/4
Section 9, T 40 N, R 12 E
 Town of Hiles, Forest County, Wisconsin

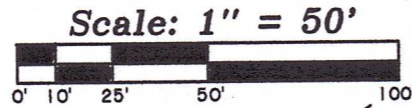

Parcel No.
016011010000

S.T. Highway "70"

11101 Hwy. 70 East
 Parcel No.
01611030000
 60,033 SQ.FT.
 1.38 ACRES

U.S.A. Lands
 Parcel No.
016010920000

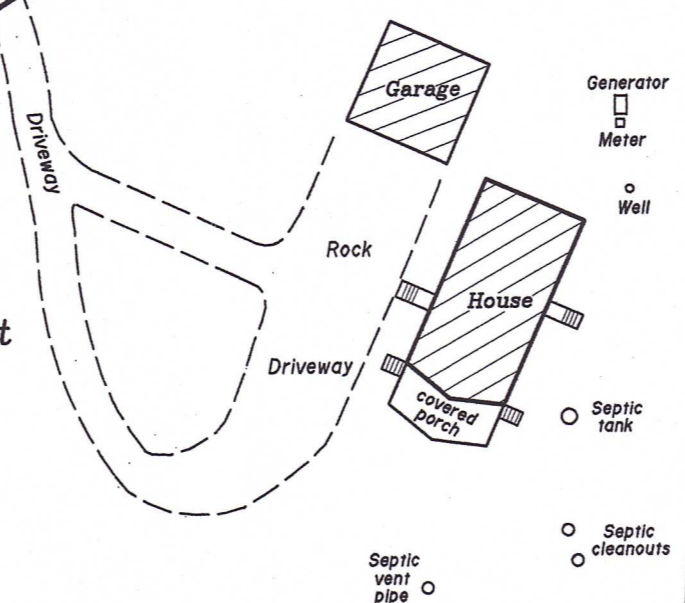

Center 1/4
Corner
 North-South 1/4 Line
 1078.15'
 2.67'

S 03°45'47"W 1375.86'
 (S 3°28'40"W 1376.30')

(D.O.T. - N 54°05'12"E) 190.36'
 (D.O.T. - N 57°00'12"E) 300.00'

(D.O.T. - N 58°01'03"E) 300.54'
 297.87'

N 86°03'08"W 2530.98'
 (N 86°20'50"W 2530.97')

Section Line

(N 2°27'10"E 1287.29')
 (N 02°45'08"E 1286.99')

S1/16
Corner

1/16th Line

CS1/16
Corner

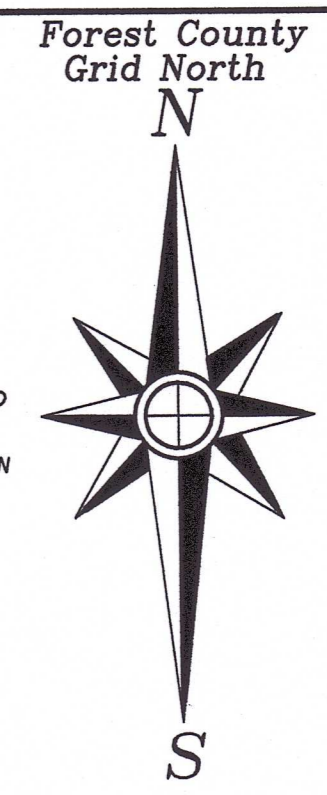

NOTE: DESCRIPTION IS PROVIDED
ON A SEPARATE SHEET.
 FIELD WORK WAS COMPLETED ON
JUNE 2nd, 2022.

U.S.A. Lands

-Surveyor's Certificate-

"I HEREBY CERTIFY, THAT I HAVE SURVEYED AND MAPPED
 THE LANDS SHOWN HEREON AND THAT, TO THE BEST OF
 MY KNOWLEDGE AND BELIEF, THIS SURVEY AND MAP IS A
 TRUE AND CORRECT REPRESENTATION THEREOF, AND THAT
 I HAVE COMPLIED WITH THE APPLICABLE REQUIREMENTS
 OF CHAPTER A-E 7 OF THE WISCONSIN ADMINISTRATIVE
 CODE'S MINIMUM STANDARDS FOR PROPERTY SURVEYS."
 DATED THIS 20th DAY OF JUNE, 2022.

Thomas A. Boettcher
 THOMAS A. BOETTCHER, P.L.S. NO. 1763

U.S.A. Lands

-Legend-

- G.L.O. 6" DIA. CONCRETE BRASS CAP MONUMENT FOUND IN PLACE
- ⊙ U.S.F.S. ALUMINUM CAP MONUMENT FOUND IN PLACE
- STEEL RIGHT-OF-WAY POST FOUND IN PLACE
- 1" DIA. IRON PIPE SET THIS SURVEY
- () BEARING & DISTANCE OF RECORD

FOREST CO SURVEYOR
 FILE # 401209-20220620
 DATE 02/03/2023 BY *JM*

8 9
17 18 Section
Corner

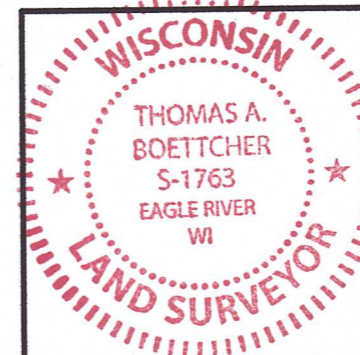

Survey For
Arthur F. & Nancy J. Laramie
 11101 S.T. Highway "70" East
 Eagle River, Wisconsin 54521

SCALE: 1" = 50' DATE: 6-20-2022 DWN. BY: K.W.S

Drawing No. **E4798** Eagle Landmark Surveying Inc.
 5035 Hwy. 70 West, Eagle River, WI 54521
 P&F (715)479-9610 survey@eaglelandmark.com