

BEARING BASIS OF RECORD

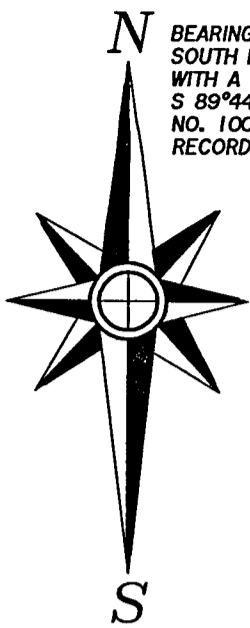

BEARINGS ARE BASED ON THE SOUTH LINE OF GOV'T. LOT 2 WITH A RECORD BEARING OF S 89°44'W FROM DOCUMENT NO. 100608, FOREST COUNTY RECORDS.

All of Lots 3 & 4 of Griswold's Butternut Lake Plat

Located in Gov't. Lot 2, Section 33 And Part of the Unplatted Part of Gov't. Lot 2, Section 33 T 40 N, R 12 E

Town of Hiles Forest County, Wisconsin

Scale: 1" = 40'



-5-

Knapp Road

Knapp

Plat

Lake

Butternut

Griswold's

Butternut Lake



sheds not shown

NOTE: Improvements not shown

-Legend-

- U.S. FOREST SERVICE CONCRETE MONUMENT-BRASS CAP FOUND IN PLACE
- U.S. FOREST SERVICE 2" IRON PIPE-BRASS CAP FOUND IN PLACE
- ⊕ 1-1/4" WELL POINT FOUND IN PLACE
- ⊖ 1-1/2" IRON PIPE FOUND IN PLACE
- 1" IRON PIPE FOUND IN PLACE
- ⊗ 3/4" IRON ROD FOUND IN PLACE
- 1" IRON PIPE SET
- △ COMPUTED ANGLE POINT
- () BEARING & DISTANCE OF RECORD

-1- There appears to be an error in the distance shown on the Griswold Plat. Document No. 100608 shows a measurement of 82.5' which checks with monumentation along the shoreline.

South line of Gov't. Lot 2 (214.4') 214.35' by U.S. Forest Service Special Meander Corner
S 89°44'00"W 656.25' (S 89°44'W 656.4')

-Surveyor's Certificate-

"I HEREBY CERTIFY, THAT I HAVE SURVEYED AND MAPPED THE LANDS SHOWN HEREON AND THAT, TO THE BEST OF MY KNOWLEDGE AND BELIEF, THIS SURVEY AND MAP IS A TRUE AND CORRECT REPRESENTATION THEREOF, AND THAT I HAVE COMPLIED WITH THE APPLICABLE REQUIREMENTS OF CHAPTER A-E 7 OF THE WISCONSIN ADMINISTRATIVE CODE'S MINIMUM STANDARDS FOR PROPERTY SURVEYS."
DATED THIS 28th DAY OF AUGUST, 2013.

THOMAS A. BOETTCHER, R.L.S. 1763

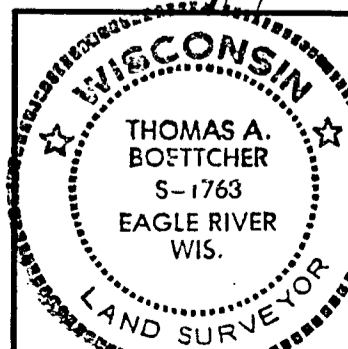

Survey For **Kenneth & Diane Gignac**
11421 192nd Street
Mokena, IL 60448
C/O CPL Dickinson Homes

SCALE: 1" = 40' DATE: 8/28/2013 DWN. BY: TAB
Drawing No. **E3814** Eagle Landmark Surveying Inc.
5035 Hwy. 70 West, Eagle River, WI 54521
P&F (715)479-9610 eaglelandmark@frontier.com

FOREST CO SURVEYOR
FILE # 401233-20130828
DATE _____ BY _____

filed 1-13-14

Parcels
16-1317
16-1316