

COUNTY AND HIGHWAY	ROUTE AND SECTION	CLASS AND AGREEMENT		FEDERAL DIVISION OFFICE	SHEET NUMBER	TOTAL SHEETS
		STATE	FEDERAL			
21.2	188.0	21.15	AUX. 3.1	4	4	

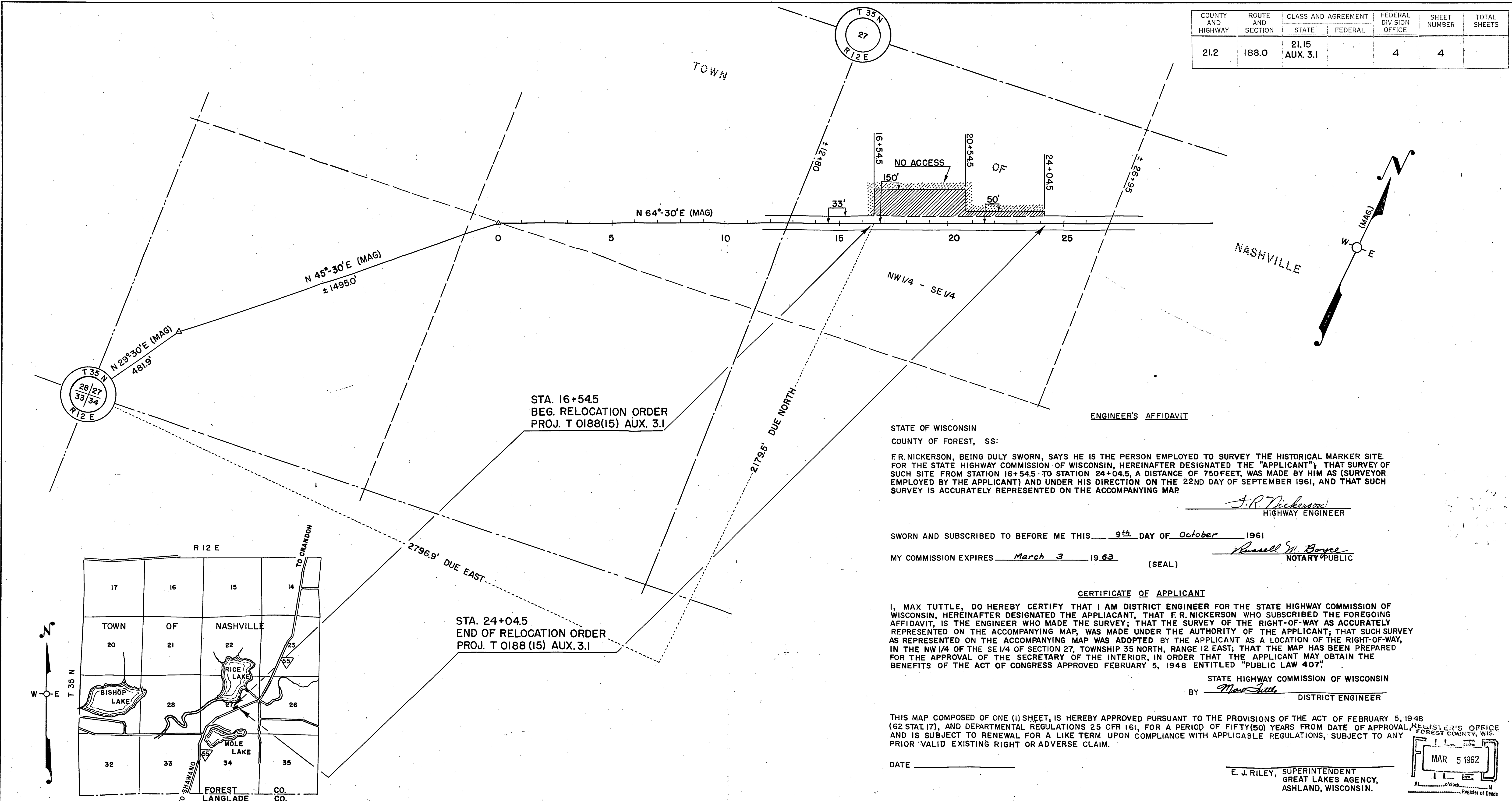

STA. 16+54.5  
BEG. RELOCATION ORDER  
PROJ. T 0188(15) AUX. 3.1

STA. 24+04.5  
END OF RELOCATION ORDER  
PROJ. T 0188 (15) AUX. 3.1

STATE OF WISCONSIN  
COUNTY OF FOREST, SS:  
F.R. NICKERSON, BEING DULY SWORN, SAYS HE IS THE PERSON EMPLOYED TO SURVEY THE HISTORICAL MARKER SITE FOR THE STATE HIGHWAY COMMISSION OF WISCONSIN, HEREINAFTER DESIGNATED THE "APPLICANT", THAT SURVEY OF SUCH SITE FROM STATION 16+54.5 TO STATION 24+04.5, A DISTANCE OF 750 FEET, WAS MADE BY HIM AS (SURVEYOR EMPLOYED BY THE APPLICANT) AND UNDER HIS DIRECTION ON THE 22ND DAY OF SEPTEMBER 1961, AND THAT SUCH SURVEY IS ACCURATELY REPRESENTED ON THE ACCOMPANYING MAP

*J.R. Nickerson*  
HIGHWAY ENGINEER

SWORN AND SUBSCRIBED TO BEFORE ME THIS 9<sup>th</sup> DAY OF October 1961

MY COMMISSION EXPIRES March 3 1963 (SEAL)

*Russell M. Boyce*  
NOTARY PUBLIC

CERTIFICATE OF APPLICANT

I, MAX TUTTLE, DO HEREBY CERTIFY THAT I AM DISTRICT ENGINEER FOR THE STATE HIGHWAY COMMISSION OF WISCONSIN, HEREINAFTER DESIGNATED THE APPLICANT, THAT F.R. NICKERSON WHO SUBSCRIBED THE FOREGOING AFFIDAVIT, IS THE ENGINEER WHO MADE THE SURVEY; THAT THE SURVEY OF THE RIGHT-OF-WAY AS ACCURATELY REPRESENTED ON THE ACCOMPANYING MAP, WAS MADE UNDER THE AUTHORITY OF THE APPLICANT; THAT SUCH SURVEY AS REPRESENTED ON THE ACCOMPANYING MAP WAS ADOPTED BY THE APPLICANT AS A LOCATION OF THE RIGHT-OF-WAY, IN THE NW 1/4 OF THE SE 1/4 OF SECTION 27, TOWNSHIP 35 NORTH, RANGE 12 EAST; THAT THE MAP HAS BEEN PREPARED FOR THE APPROVAL OF THE SECRETARY OF THE INTERIOR, IN ORDER THAT THE APPLICANT MAY OBTAIN THE BENEFITS OF THE ACT OF CONGRESS APPROVED FEBRUARY 5, 1948 ENTITLED "PUBLIC LAW 407"

STATE HIGHWAY COMMISSION OF WISCONSIN  
BY *Max Tuttle* DISTRICT ENGINEER

THIS MAP COMPOSED OF ONE (1) SHEET, IS HEREBY APPROVED PURSUANT TO THE PROVISIONS OF THE ACT OF FEBRUARY 5, 1948 (62 STAT 17), AND DEPARTMENTAL REGULATIONS 25 CFR 161, FOR A PERIOD OF FIFTY (50) YEARS FROM DATE OF APPROVAL, AND IS SUBJECT TO RENEWAL FOR A LIKE TERM UPON COMPLIANCE WITH APPLICABLE REGULATIONS, SUBJECT TO ANY PRIOR VALID EXISTING RIGHT OR ADVERSE CLAIM.

DATE \_\_\_\_\_

E. J. RILEY, SUPERINTENDENT  
GREAT LAKES AGENCY,  
ASHLAND, WISCONSIN.

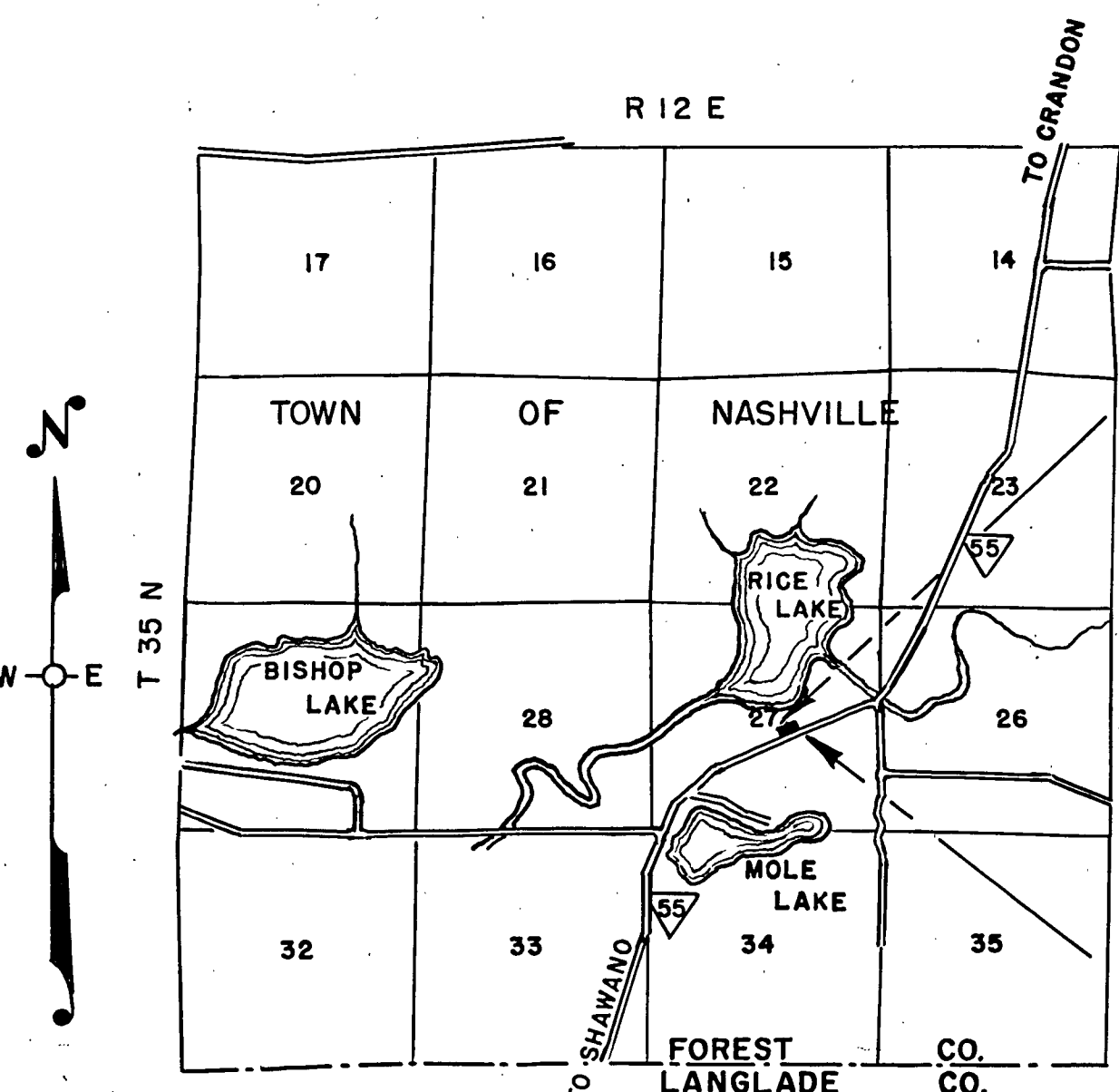
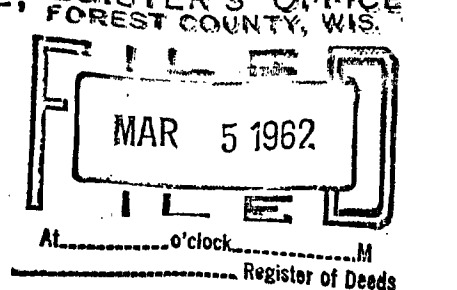

LOCATION SKETCH

STATE HIGHWAY COMMISSION OF WISCONSIN  
PLAT OF RIGHT OF WAY REQUIRED  
PROJECT T 0188(15) AUX. 3.1  
SOUTH COUNTY LINE - CRANDON ROAD  
"MOLE LAKE BATTLE GROUND" HISTORICAL MARKER  
S. T. H. 55 FOREST COUNTY

PAR. NO.	OWNER	ADDRESS	INTEREST REQUIRED	DESCRIPTION	ACRES REQUIRED				PAR. NO.	ALSO SHEET
					IMP	UNIMP	MARSH	TOTAL		
1	SOKAOGON CHIPPEWA COMMUNITY TRIBAL LAND	MOLE LAKE, WISCONSIN	EASEMENT	NW 1/4 - SE 1/4 SEC. 27, T35N, R12E	1.21			1.21	1	

SCALE  
LENGTH = 0.142 MILES  
0 100 200  
REVISED FEB. 2, 1962  
DATED OCTOBER 9, 1961