

# NEWALD CEMETERY

NORTH  
330' Var. 1° 45' E.

STREET

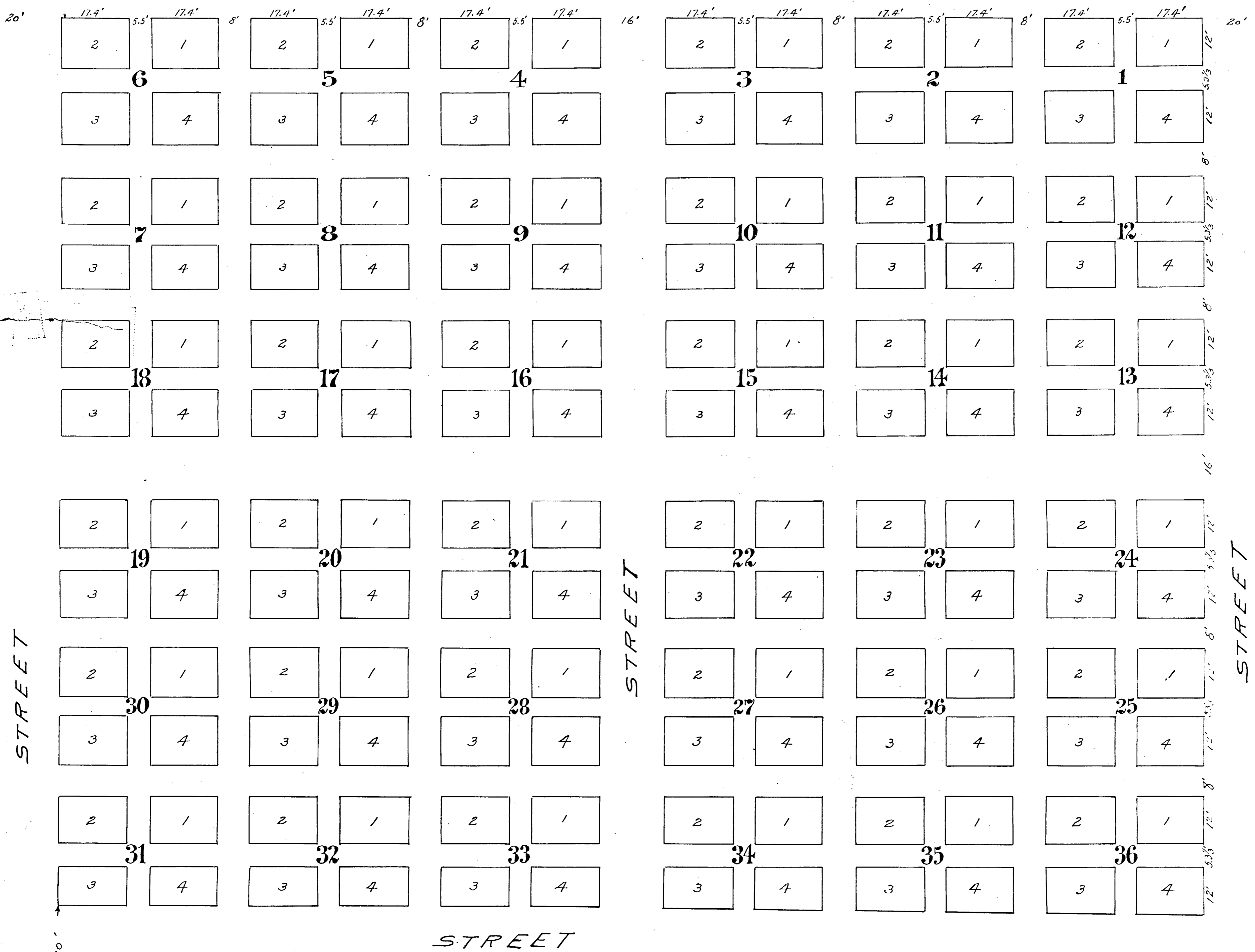

SECTION LINE Var. 1° 45' E.  
SOUTH

STATE OF WISCONSIN } S.S.  
COUNTY OF FOREST

I, I. R. RITTER, do hereby certify that I have surveyed and platted the South East 363 feet by 264 feet of the S.E. 1/4 of S.E. 1/4 of Section 23 Township 38 North Range 14 East of the 4th principal Meridian and situated in Forest County, and State of Wisconsin, as shown on the within map, the same to be known as "THE NEWALD CEMETERY."

That said survey was made by order and direction of the town board of the Town of Newald.

Dated May-24<sup>th</sup> A.D. 1922

Subscribed and sworn to before me this 24<sup>th</sup> day of May, A.D. 1922.

Notary Public, Forest Co. Wisconsin  
My Commission Expires June 18, 1922

STATE OF WISCONSIN } S.S.  
COUNTY OF FOREST

We the undersigned Cemetery Commission of the Town of Newald, Forest County, Wisconsin do hereby certify that we have caused the lands described in the foregoing certificate of I. R. RITTER, Surveyor to be surveyed and mapped as represented on the within map.

Dated May-31- A.D. 1922  
Cemetery Commission of the Town of Newald.

----- President  
----- Secretary  
----- Treasurer

STATE OF WISCONSIN } S.S.  
COUNTY OF FOREST

On this 6<sup>th</sup> day of June, A.D. 1922, before me came A.M. ROGERS, ED. GERL, RHINE FENSKI, known to me to be the Cemetery Commission board of the town of Newald, Forest County, Wisconsin, and acknowledged that they executed the foregoing certificate and acknowledged the same.

Justice of Peace of the Town of Newald.