

INDEX OF SHEETS

SHEET NO	1	TITLE
SHEET NO	2	TYPICAL CROSS SECTIONS
SHEET NO	3&3A	ESTIMATE OF QUANTITIES
SHEET NO	4	RIGHT OF WAY PLAT
SHEET NO	5-7	PLAN AND PROFILE STA. 12+69 TO STA. 96+994
SHEET NO	8-10	DRAINAGE STRUCTURES AND STANDARD DETAILS
SHEET NO	11-32	CROSS SECTIONS
SHEET NO	33	GRADE SHEET

FED. ROAD DIST. NO.	STATE	STATE PROJ. NO.	SHEET NO.	TOTAL SHEETS
4	WISC.	7068	1	33

DIVISION JOB NO. 7068

STATE OF WISCONSIN  
**WISCONSIN HIGHWAY COMMISSION**  
 PLAN AND PROFILE OF PROPOSED  
**CAVOUR - NEWALD ROAD**  
 FOREST COUNTY  
 STATE PROJECT 7068

BEGINNING AT THE CENTER OF SEC. 29, T37N, R15E, THENCE NORTHWESTERLY TO A POINT 200 FT. NORTH AND 210 FT. WEST OF THE N.W. CORNER OF SEC. 20, T37N, R15E.

SCALES | PLAN 1 IN. = 100 FT.  
 | PROFILE HOR. 1 IN. = 100 FT. VERT. 1 IN. = 10 FT.  
 | CROSS SECTIONS HOR. 1 IN. = 5 FT. VERT. 1 IN. = 5 FT.

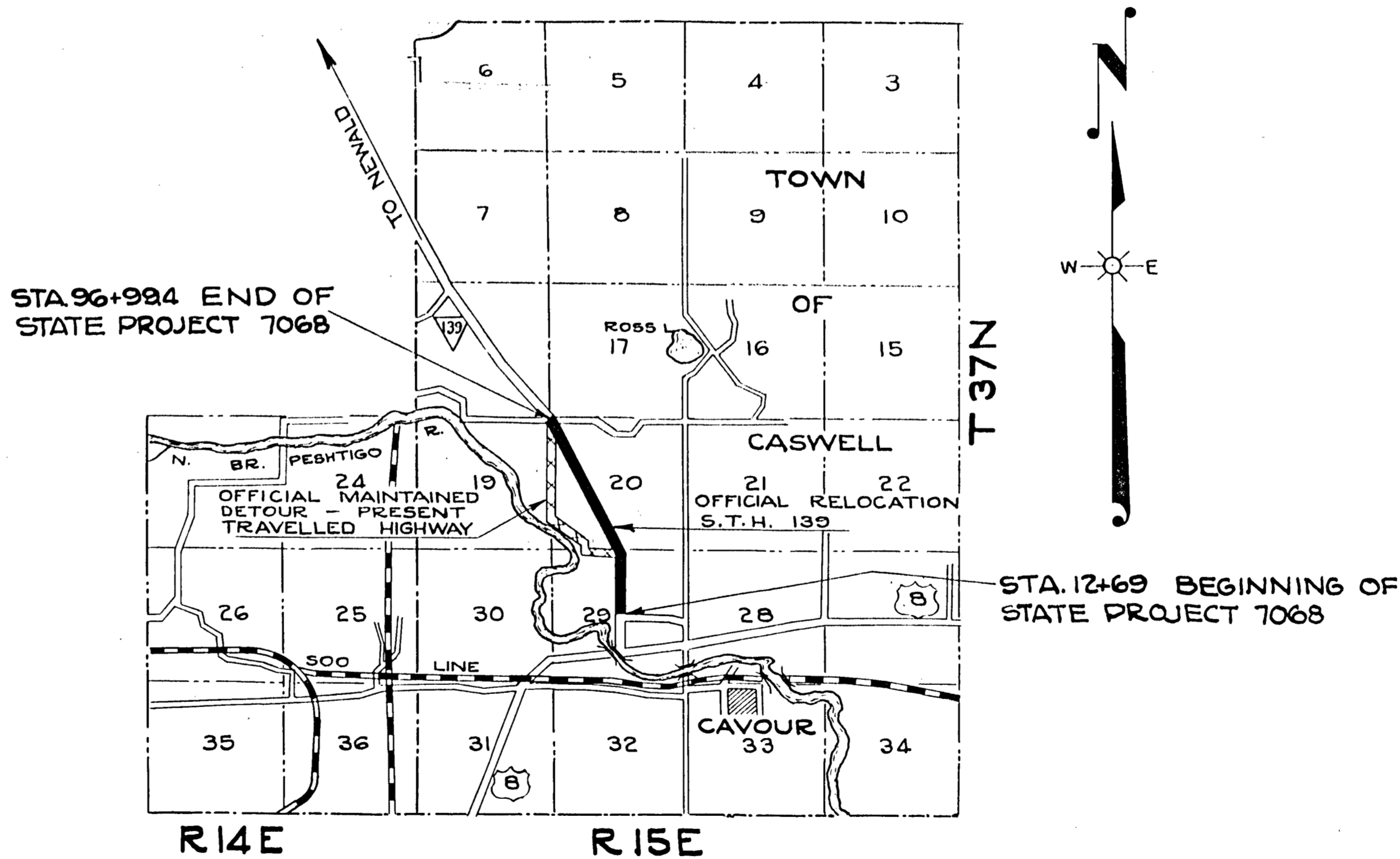

CONVENTIONAL SIGNS

STATE AND NATIONAL LINE.....	CULVERTS.....
COUNTY LINE.....	DROP INLET.....
CITY, VILLAGE, OR TOWN.....	TROLLEY POLE.....
TOWNSHIP LINE.....	POWER POLE.....
SECTION LINE.....	TELEPHONE OR TELEGRAPH POLES.....
FENCE LINE.....	MAIL BOX.....
GUARD RAIL.....	REFERENCE STAKES.....
UNFENCED PROPERTY.....	MARSH.....
RIGHT OF WAY LINE.....	HEDGE.....
TRAVELED WAY.....	TREES.....
RAILROADS.....	GROUND ELEVATION.....
RETAINING WALL.....	GRADE ELEVATION.....
LEVEE.....	
BASE OR SURVEY LINE.....	

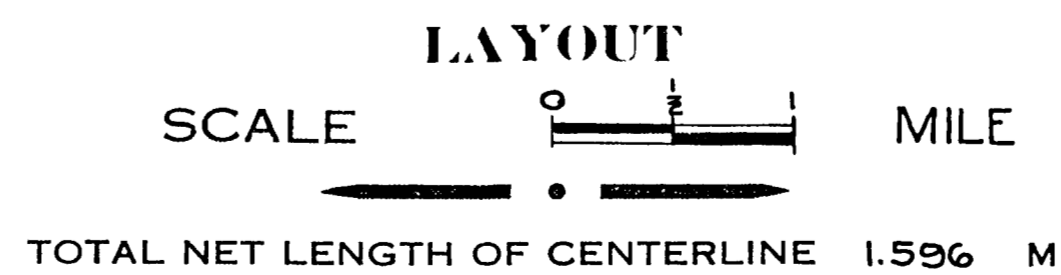

<p><b>WISCONSIN HIGHWAY COMMISSION</b> MADISON, WIS.</p> <p>Surveyor: C.J. DVORAK Note Book 7133, 7057...                  Div. Computer G.E. HARBECKM. O. Checker... none...                  Div. Checker K.H. BOLLER Correct.....</p> <p>CORRECT: <i>4/6/37 J. Labozarck</i>                  DISTRICT ENGINEER</p> <p>RECOMMENDED FOR APPROVAL: <i>Frank Crow</i>                  DESIGN ENGINEER CONST. ENGINEER</p> <p>APPROVED: <i>E.G. Rettig</i>                  STATE HIGHWAY ENGINEER</p> <p>DATE: 4/5 1937</p>	<p><b>U.S. DEPARTMENT OF AGRICULTURE</b> BUREAU OF PUBLIC ROADS</p> <p>RECOMMENDED FOR APPROVAL:                  [Signature] DISTRICT ENGINEER                  [Signature] CHIEF ENGINEER</p> <p>APPROVED:                  [Signature] DIRECTOR</p> <p>DATE: [Signature]</p>
--	---

FED. ROAD DIST. NO.	STATE	STATE PROJECT	SHEET NO.	TOTAL SHEETS
4	WISC.	7068	4	33

DIVISION JOB NO. 7068

PARCEL NO.	OWNER	ADDRESS	DESCRIPTION	ACRES PURCHASED			PARCEL NO.
				MARSH	UNIMPROVED	IMPROVED	
1	EDW. GRUMAN	CAVOUR WIS.	SW 1/4 NE 1/4 SEC. 29 T37N R15E		1.92		1
2	.. ..	.. ..	NW 1/4 NE 1/4 .. ..		1.98		2
3	RICHARD POPP	.. ..	PART OF SE 1/4 NW 1/4 .. ..			1.03	3
4	ASHENBREWER & GRUMAN	LAONA WIS.	.. ..		0.94		4
5	.. ..	.. ..	NE 1/4 NW 1/4 .. ..		1.93		5
6	FOREST COUNTY	CRANDON WIS.	SW 1/4 SE 1/4 SEC. 20 .. ..		0.67		6
7	ROSA KALATA	CAVOUR ..	SE 1/4 SW 1/4 .. ..		5.61		7
8	U.S. GOVERNMENT	.. ..	NE 1/4 SW 1/4 .. ..		6.59		8
9	.. ..	.. ..	SE 1/4 NW 1/4 .. ..		0.49		9
10	WM. ROEPEL	GREEN BAY WIS.	NW 1/4 SW 1/4 .. ..		0.09		10
11	FOREST COUNTY	CRANDON WIS.	SW 1/4 NW 1/4 .. ..		5.99		11
12	M.W. MILLISON	4932 LAKE PARK CHICAGO ILLINOIS	NW 1/4 NW 1/4 .. ..		5.49		12
TOTAL					31.70	1.03	32.73

STA. 0+00 BEG. OF RELOC. ORDER DIVISION JOB NO. 7899-1934

STA. 96+93.4 END STATE PROJ. 7068

STA. 92+85 END OF RELOCATION ORDER DIV. JOB NO. 7068

STA. 12+69 END OF RELOC. ORDER PROJ. 7973-1934

STA. 10+63.3 OF STATE PROJ. 7899

STA. 92+85 END OF RELOCATION ORDER DIV. JOB NO. 7068

SCALE 0 100 200

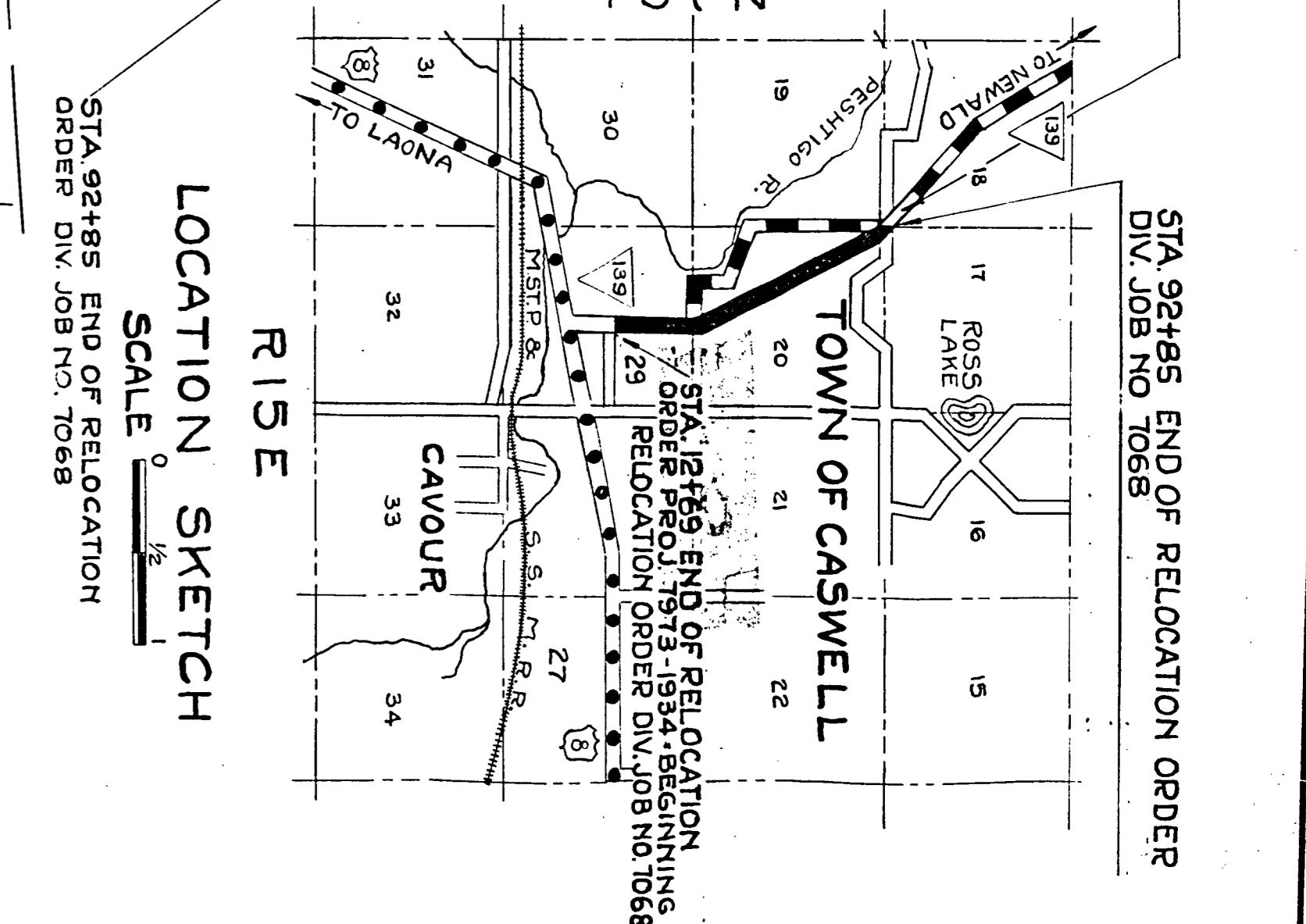
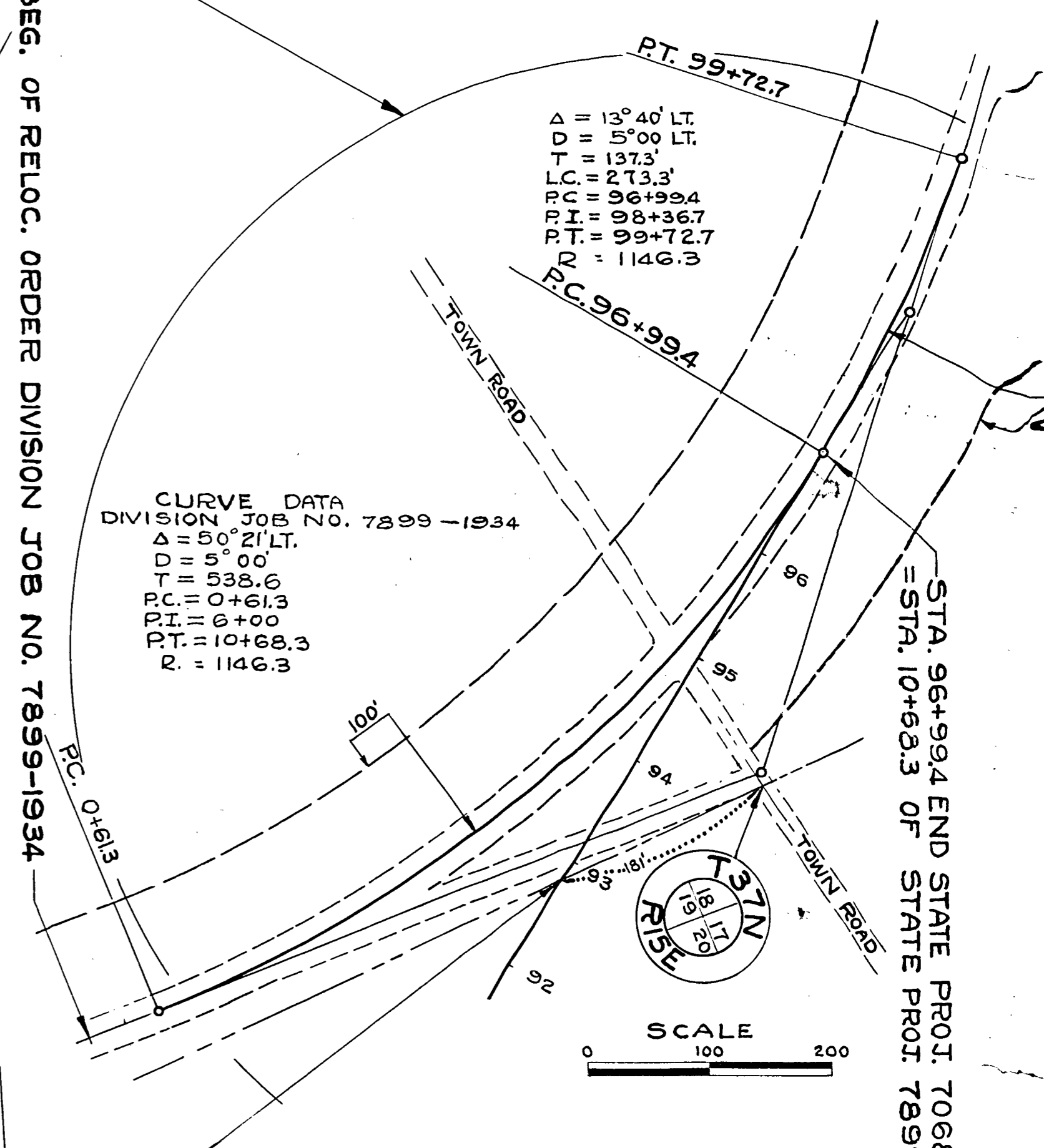

PLAT OF RIGHT OF WAY REQUIRED  
 DIVISION JOB NO. 7068  
 CAVOUR - NEWALD ROAD  
 S.T.H. NO. 139 FOREST COUNTY

SCALE 0 200 400 800

DRAWN BY F.W. MARCH - 1937  
 COMPLETED BY F.W. MARCH - 1937  
 CHECKED BY C.J.W. APRIL - 1937

STA. 12+69 END OF RELOC. ORDER PROJ. 7973-1934  
 = BEG. OF RELOC. ORDER DIVISION JOB NO. 7068

RISE

RISE

RISE

RISE