

CERTIFIED LAND CORNER RESTORATION

Index No. E24  
31 5

State of Wisconsin }  
County of Lanai } ss.

I Raymond J. Hallig, do hereby certify that on the 3rd day of June, 1978, I found evidence of the EAST 1/4 corner of SECTION 1 Township 31, North, Range 9E, Fourth Principal Meridian, as described hereon; and that from this evidence I established a new monument and accessories as described hereon to perpetuate the original location of this corner.

Resident witnesses:  
.....  
.....  
.....

History of original corner establishment:  
ESTABLISHED IN 1937 RESURVEY

Description of corner evidence found:  
CORNER DESTROYED BY LAND CLEARING OPERATION.

Description of monument and accessories I established to perpetuate the original location of this corner.  
RUN TRANSIT LINE BETWEEN SOUTH 1/4 COR AND SE SECTION CORNER OF SECTION 1 - T31N - R9E AND SET EAST 1/4 COR AT MID POINT.  
12" X 1" GALVANIZED PIPE DROVE IN OLD ROAD FOR TRUE CORNER  
SET 1 1/2" IRON PIPE WITH BRASS CAP AS W.C. 15' NORTH IN OLD EAST-WEST FENCE LINE  
B.T.S TO TRUE CORNER  
OAK 7" 535°W 50' 4"  
Red Maple 6" 510°W 29' 9"

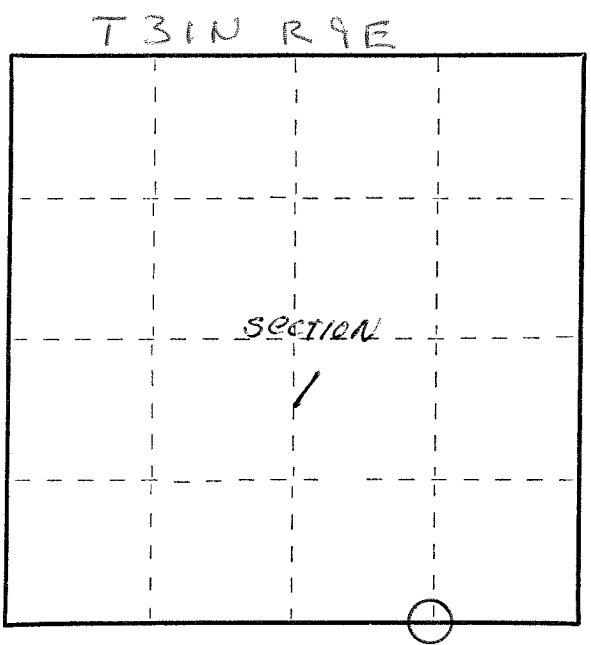

○ = Corner monument restored.

Dated at Antigo, Wis., this 3rd day of June, 1978.  
Signature Raymond J. Hallig Title Registered Land Surveyor Registration No. S-685  
(County Surveyor, Registered Land Surveyor, or other duly authorized official)  
Office of Register of Deeds, County of \_\_\_\_\_, I hereby certify that the within instrument was filed in this office for record on the \_\_\_\_\_ day of \_\_\_\_\_, 19\_\_\_\_ at \_\_\_\_\_ o'clock \_\_\_\_\_ M.

.....  
(Register of Deeds)  
By..... Deputy

FORM 985 R. C. MILLER CO., MILWAUKEE  
43169010010