

CERTIFIED LAND CORNER RESTORATION

Index No. B-21

State of Wisconsin }
County of Lancaster } ss.

History of original corner establishment:
ESTABLISHED IN 1937 RESURVEY

I Raymond J. Hallisy, do hereby certify that on the 3rd day of June, 1978, I found evidence of the NORTH 1/16 corner of SECTION 1, 2 Township 31, North, Range 9 EAST, Fourth Principal Meridian, as described hereon; and that from this evidence I established a new monument and accessories as described hereon to perpetuate the original location of this corner.

Description of corner evidence found:
SCRIBED & SQUARED CEDAR POST DOWN - POINT IN GROUND

Resident witnesses:

Description of monument and accessories I established to perpetuate the original location of this corner.

SET 2 INCH IRON PIPE WITH BRASS CAP

NEW B.T.S
ASPEN 6" N12°E 26.5 LINKS
ASPEN 7" N84°E 31. LINKS

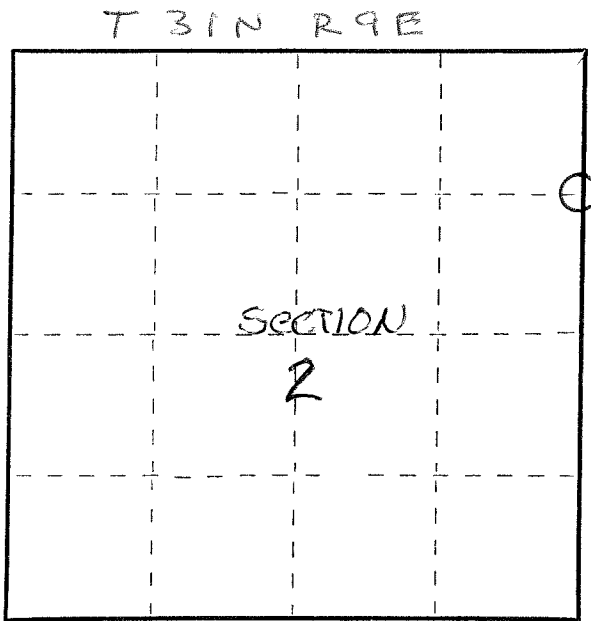

Dated at ARATIGU, Wis., this 3rd day of June, 1978.

Signature Raymond J. Hallisy Title Registered Land Surveyor Registration No. 5-6-85
(County Surveyor, Registered Land Surveyor, or other duly authorized official)

Office of Register of Deeds, County of _____, I hereby certify that the within instrument was filed in this office for record on the _____ day of _____, 19____ at _____ o'clock _____ M.

(Register of Deeds)

By _____ Deputy

○ = Corner monument restored.

FORM 985 H. C. MILLER CO., MILWAUKEE

43164023000