

CERTIFIED LAND CORNER RESTORATION

32-12

Index No. E-10

State of Wisconsin }
County of Langlade } ss.

I Raymond J. Hallisy, do hereby
certify that on the 4th day
of May, 1969, I found
evidence of the W 1/16
corner of Section 9
Township 32, North, Range
12E, Fourth, Principal Meridian,
as described hereon; and that from this evidence
I established a new monument and accessories
as described hereon to perpetuate the original
location of this corner.

History of original corner establishment:

Corner established in the 1930 resurvey.

Description of corner evidence found:

Found old squared stake down, point in ground
Marked W 1/16 S 4 S 9

Resident witnesses:

.....
.....
.....

Description of monument and accessories I established to perpetuate the original location of this corner.

Set 2" pipe with brass cap

B.T.'s to corner

~~Elm~~ Elm 1 1/2" S46W 39Ft. 4 inches
Elm 6" N63W 32Ft. 9 inches

B.T.'s faced at ~~Elm~~ base of tree and scribed BT

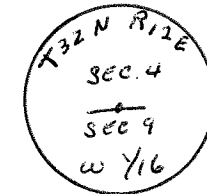

FORM 985 H. C. MILLER CO., MILWAUKEE

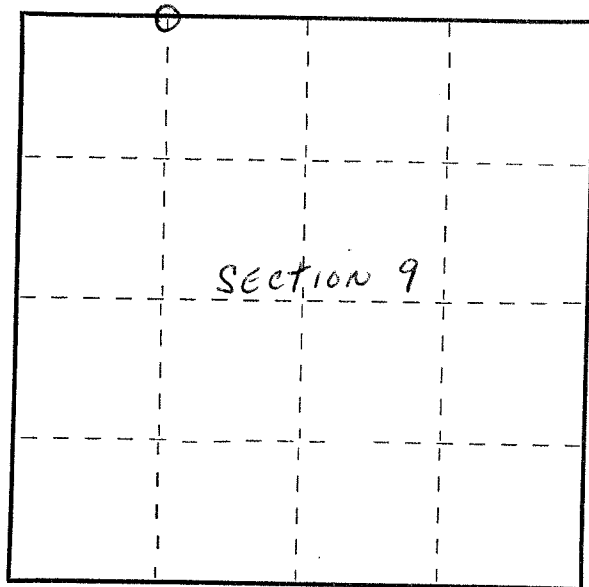

○ = Corner monument restored.

Dated at Antigo, Wis., this 4th day of May, 19 69

Signature Raymond J. Hallisy Title Reg. Land Surveyor Registration No. S-685
(County Surveyor, Registered Land Surveyor, or other duly authorized official)

Office of Register of Deeds, County of....., I hereby certify that the within
instrument was filed in this office for record on the.....day of....., 19.....
at.....o'clock..... M.

(Register of Deeds)

By.....Deputy