

CERTIFIED LAND CORNER RESTORATION

32-12

Index No. F-9

State of Wisconsin }
County of LANGLADE } ss.

I G. McKenna + G. Weix, do hereby certify that on the 30 day of APRIL, 1963, I found evidence of the NORTH 1/4 corner of SEC 8 + 9 Township 32, North, Range 12, Fourth Principal Meridian, as described hereon; and that from this evidence I established a new monument and accessories as described hereon to perpetuate the original location of this corner.

Resident witnesses:

G. McKenna
G. Weix

History of original corner establishment:

NOVEMBER 15, 1937
RE SURVEY

Description of corner evidence found:

CEDAR STAKE

Description of monument and accessories I established to perpetuate the original location of this corner.

SET 1 1/2" IRON PIPE AS W.C. 50 LKS WEST

FORM 985 H. C. MILLER CO., MILWAUKEE

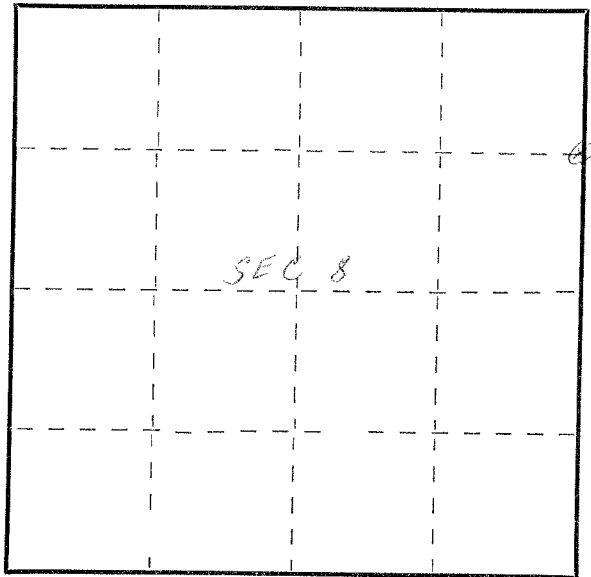

○ = Corner monument restored.

Dated at ANTIGO, Wis., this 10th day of MAY, 1963

Signature [Signature] Title Co. Clerk Registration No. _____
(County Surveyor, Registered Land Surveyor, or other duly authorized official)

Office of Register of Deeds, County of _____, I hereby certify that the within instrument was filed in this office for record on the _____ day of _____, 19____ at _____ o'clock _____ M.

(Register of Deeds)

By _____ Deputy