

CERTIFIED LAND CORNER RESTORATION

32-12

Index No. F-21

State of Wisconsin }
County of Langlade } ss.

History of original corner establishment:

Corner set in the 1930's by: D. A. Hintz
Hugh StClaire
C. W. Borth

I Raymond J. Hallisy, do hereby certify that on the 13th day of July, 1968, I found evidence of the N 1/16 corner of Section 12 Township 32, North, Range 12, Fourth Principal Meridian, as described hereon; and that from this evidence I established a new monument and accessories as described hereon to perpetuate the original location of this corner.

Description of corner evidence found:

Found old stake down, point intact, marked N 1/16 11 12

Resident witnesses:

.....
.....
.....

Description of monument and accessories I established to perpetuate the original location of this corner.
Set Std. 1 1/2" pipe with cap marked N 1/16 11 12

✓ 6" ASPEN
N 6 W 6' 9"
SCRIBED BT
IP

✓ 8" ASPEN
S 72 E 8'
SCRIBED BT

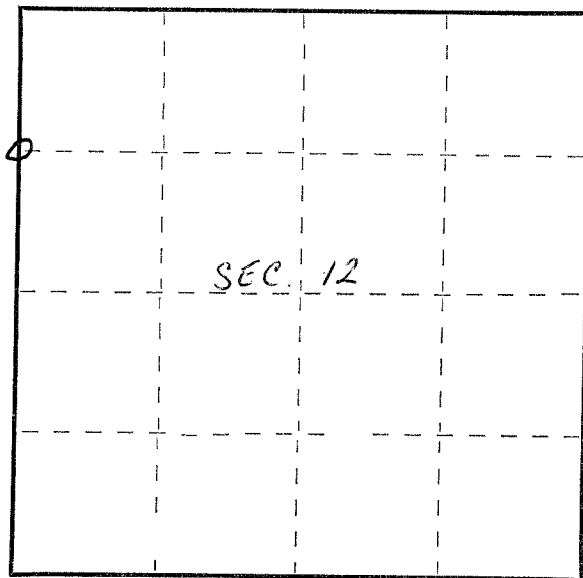

○ = Corner monument restored.

Dated at Antigo, Wis., this 13th day of July, 1968

Signature Raymond J. Hallisy Title Reg. Land Surveyor Registration No. F-685
(County Surveyor, Registered Land Surveyor, or other duly authorized official)

Office of Register of Deeds, County of _____, I hereby certify that the within instrument was filed in this office for record on the _____ day of _____, 19____ at _____ o'clock _____ M.

.....
(Register of Deeds)

By _____ Deputy