

CERTIFIED LAND CORNER RESTORATION

32-12

Index No. K-25

State of Wisconsin }
County of Langlade } ss.

History of original corner establishment:

Corner set in the 1930's by: E .F. Kowalke
C: W. Borth

I, Raymond J. Hallisy, do hereby certify that on the 22nd day of June, 1968, I found evidence of the N 1/16 corner of Section 13 Township 32, North, Range 12, Fourth, Principal Meridian, as described hereon; and that from this evidence I established a new monument and accessories as described hereon to perpetuate the original location of this corner.

Description of corner evidence found:

Found old squared stake and rock mound, marked WC Cor 50 LKS E also 2" pipe alongside and a new wood post.

Resident witnesses:

.....
.....
.....

Description of monument and accessories I established to perpetuate the original location of this corner.
Set std. 1 1/2" pipe with cap marked N 1/16 W.C. C. 50 LKS. E. BT's to witness corner.

FORM 985 H. C. MILLER CO., MILWAUKEE

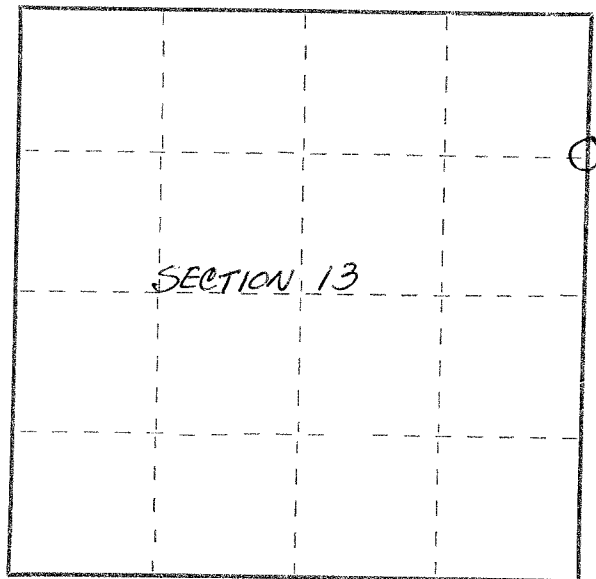

8" ASPEN N68W
19' 7"
SCRIBED BT

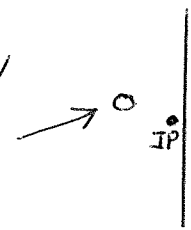

8" ELM S80E 49' 1"
SCRIBED BT

Dated at Antigo, Wis., this 22nd day of June, 1968.

Signature: Raymond J. Hallisy Title: Land Surveyor Registration No. S-685
(County Surveyor, Registered Land Surveyor, or other duly authorized official)

Office of Register of Deeds, County of _____, I hereby certify that the within instrument was filed in this office for record on the _____ day of _____, 19____ at _____ o'clock _____ M.

(Register of Deeds)

By _____ Deputy

○ = Corner monument restored.