

CERTIFIED LAND CORNER RESTORATION

32-12

Index No. K-17

State of Wisconsin

County of Lanola } ss.

History of original corner establishment:

Corner set in the 1930 resurvey

I, Raymond Hallis, do hereby certify that on the 12th day of May, 1973, I found evidence of the N 1/4 corner of Section 14 & 15 Township 32, North, Range 12E, Fourth, Principal Meridian, as described hereon; and that from this evidence I established a new monument and accessories as described hereon to perpetuate the original location of this corner.

Description of corner evidence found:

Wood post down, point intact, marks plain on east side of dry pot hole

Resident witnesses:

Description of monument and accessories I established to perpetuate the original location of this corner.

Set 1 1/2" pipe with brass cap - marked

New BT's

10" E1M S53W 1.50 chains

2 1/2' X 3' Boulder S15E 36.7 links

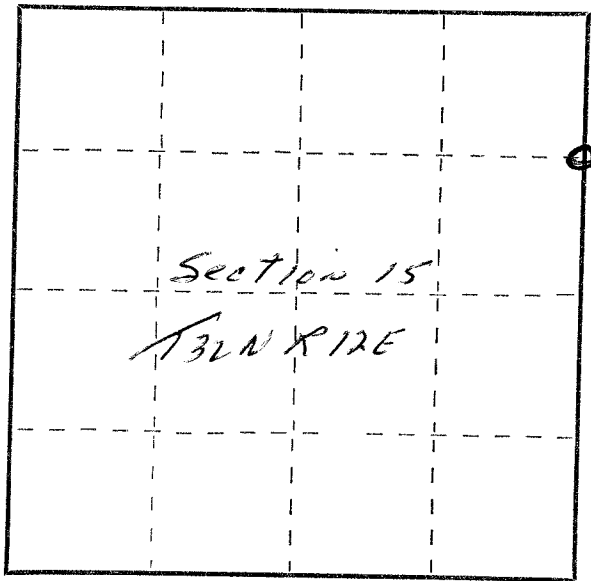

Dated at Antigo, Wis., this 12th day of May, 1973

Signature Raymond Hallis Title Reg. Land Surveyor Registration No. 5685
(County Surveyor, Registered Land Surveyor, or other duly authorized official)

Office of Register of Deeds, County of _____, I hereby certify that the within instrument was filed in this office for record on the _____ day of _____, 19____ at _____ o'clock _____ M.

(Register of Deeds)

By _____ Deputy

○ = Corner monument restored.