

CERTIFIED LAND CORNER RESTORATION

Index No. R-25

32-12

State of Wisconsin }  
County of LANGLADE } ss.

I WILLIAM F. KELLY, do hereby certify that on the 16<sup>th</sup> day of DECEMBER, 1982, I found evidence of the SW corner of SECT. 19 Township 32, North, Range 13 EAST, Fourth Principal Meridian, as described hereon; and that from this evidence I established a new monument and accessories as described hereon to perpetuate the original location of this corner.

Resident witnesses:

C. Wegner

History of original corner establishment:  
ORIGINAL CORNER ESTABLISHED BY  
ALFRED MILLAND IN SEPT., 1857.

Description of corner evidence found:

FOUND IN PLACE: 3/4" IRON PIPE;  
4" x 4" WOOD POST WITH LOCATION TAG;  
2 BT'S. SET 3" x 48" ALUMINUM  
CAP WITNESS MONUMENT.



William F. Kelly  
12-17-82

Description of monument and accessories I established to perpetuate the original location of this corner.

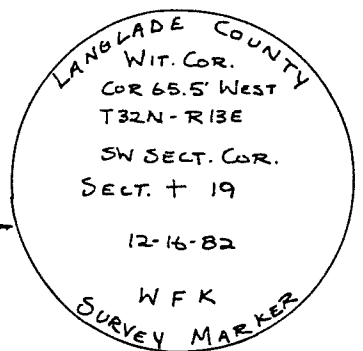
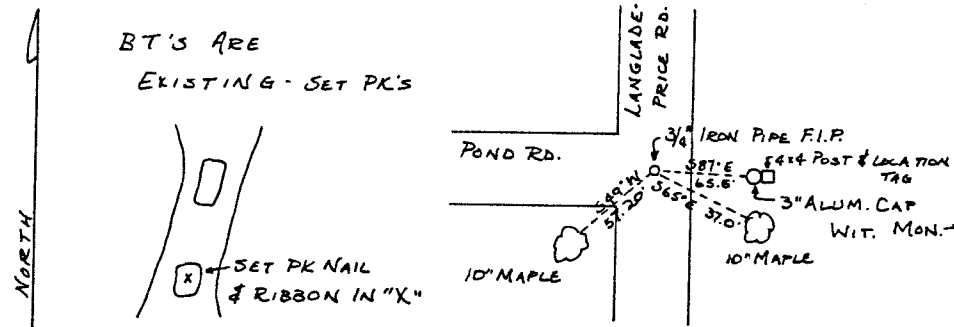
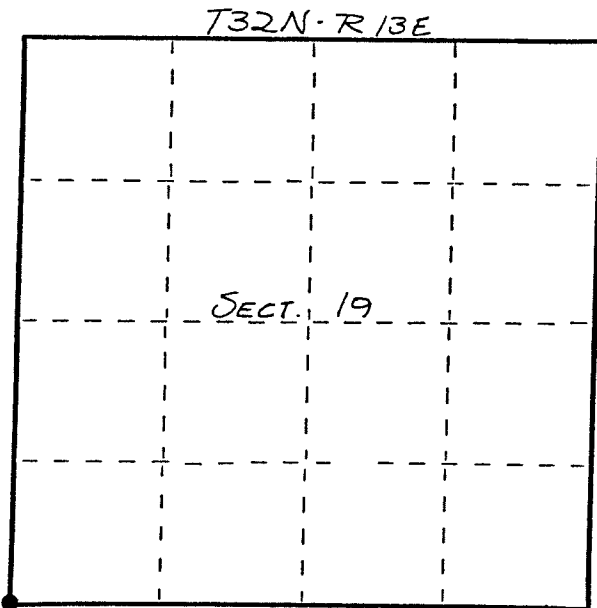

Dated at ELCHO, Wis., this 16<sup>th</sup> day of DECEMBER, 1982.

Signature William F. Kelly Title COUNTY SURVEYOR Registration No. 1098  
(County Surveyor, Registered Land Surveyor, or other duly authorized official)

Office of Register of Deeds, County of \_\_\_\_\_, I hereby certify that the within instrument was filed in this office for record on the \_\_\_\_\_ day of \_\_\_\_\_, 19\_\_\_\_ at \_\_\_\_\_ o'clock \_\_\_\_\_ M.

(Register of Deeds)

By \_\_\_\_\_ Deputy

○ = Corner monument restored.

FORM 985 M. C. MILLER CO., MILWAUKEE