

**LANGLADE COUNTY U.S. PUBLIC LAND
SURVEY MONUMENT LOCATION RECORD**

432/4/19 2020 2025

FOUND SECTION 19
SET TOWNSHIP 32 NORTH
RE-SET RANGE 14 EAST
RE-TIED TOWN OF WOLF RIVER

CORNER LOCATION: CENTER OF SECTION
MONUMENT TYPE: 2" IRON BAR WITH BRASS CAP
COUNTY COORDINATE: (N 376929.06) (E 713036.41)
HORIZONTAL DATUM: WCCS LANGLADE CO. NAD83 2011
DATE OF SURVEY: 11-5-2024
SURVEY PARTY: JASON J. PFLIEGER

SECTION 19

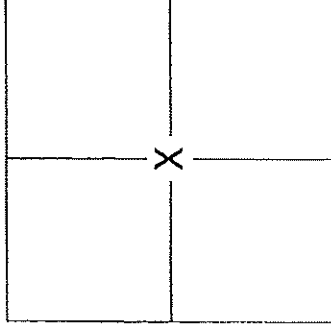

LOCATION INDICATED BY 'X'

BASIS FOR MONUMENT LOCATION:

1978: WESLEY TRADEWELL (S-1342) SET A 2" IRON PIPE WITH A BRASS CAP AS SHOWN ON CERTIFIED SURVY MAP VOLUME 1 PAGE 260. A SURVEY MONUMENT LOCATION RECORD WAS NEVER FILED.

2024: I FOUND THE 2" IRON PIPE WITH BRASS CAP. I ACCEPTED THE CORNER LOCATION AND ADDED 4 NEW TIES AS SHOWN.

SURVEYORS CERTIFICATE

I, JASON J. PFLIEGER, PROFESSIONAL LAND SURVEYOR S-3148-8, DO HEREBY CERTIFY THAT THE CORNER LOCATION SHOWN ON THIS RECORD WAS DETERMINED BY ME AND THAT THE U.S. PUBLIC LAND SURVEY MONUMENT RECORD IS CORRECT TO THE BEST OF MY KNOWLEDGE AND BELIEF.

J-P
JASON J. PFLIEGER P.L.S. 3148-8

DATED THIS 15TH DAY OF JANUARY, 2025

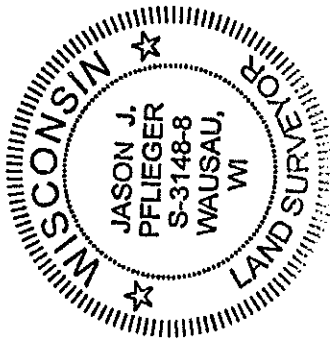

TIE SKETCH:

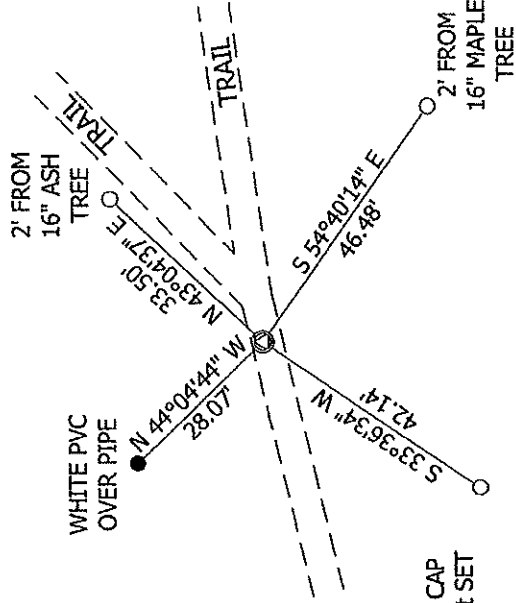

- ⊙ = 2" IRON PIPE WITH BRASS CAP
- = 3/4" X 30" REBAR 1.50lbs/ft SET
- = 1" OD IRON PIPE FOUND

INDEX NO:

P3 33-14

4321419 2020 1995

U. S. PUBLIC LAND SURVEY MONUMENT RECORD

I N S T R U C T I O N S:

This record shall show the location of the corner and shall include all of the following nine elements (a through i).

- (a) Identify the corner by reference to the U.S. public land survey system.
- O = Corner monument restored.

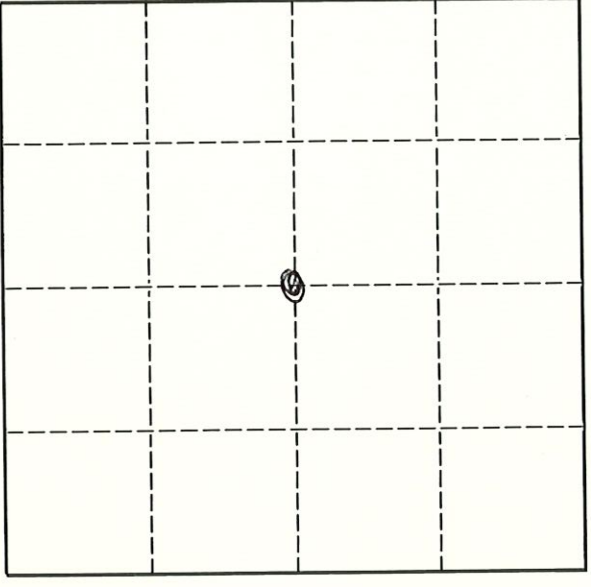

CENTER
SEC 19-32-14

19-32-14

- (b) Describe any record evidence, monument evidence, occupational evidence, testimonial evidence or any other material evidence you considered, and whether the monument was found or placed.

CORNER SHOWS AS 2" IRON PIPE ON
 1994 DOT PLANS FOR 5TH 55
 SEE MAP # 20120
 D. Thursty
 4/5/95

- (c) In the plan view drawing below, provide reference ties to at least 4 witness monuments, or, if the location is within a municipality, to at least 2 witness monuments. (Witness monuments shall be made of concrete, natural stone, iron or other equally durable material.) Describe witness monuments.

- (d) Show a plan view drawing depicting the relevant monuments and reference ties which is sufficient in detail to enable accurate relocation of the corner monument if the corner monument is disturbed. Indicate north.

