

Longwell Co. Sur.

U. S. PUBLIC LAND SURVEY MONUMENT RECORD

I N S T R U C T I O N S : This record shall show the location of the corner and shall include all of the following nine elements (a through i).

- (a) Identify the corner by reference to the U.S. public land survey system.
- O = Corner monument restored.

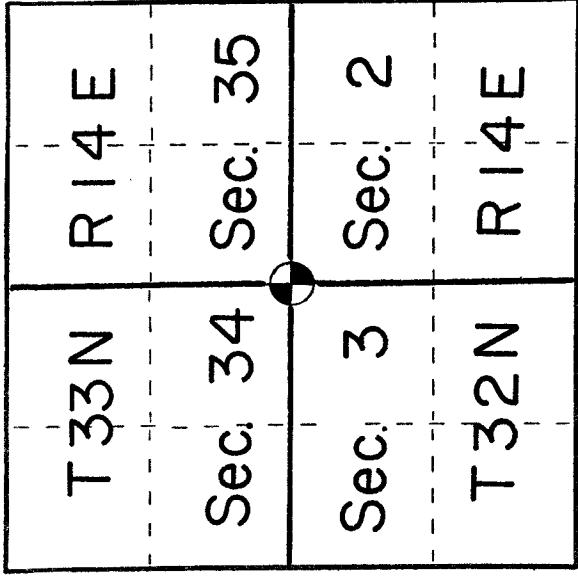

Section corner to Sections 34-35 of T33N, R14E and Sections 2-3 of T32N, R14E

- (b) Describe any record evidence, monument evidence, occupational evidence, testimonial evidence or any other material evidence you considered, and whether the monument was found or placed.

Surveyed in 1857 by Alfred Millard. Swamp calls from the east of 75.00 chains enter swamp and 79.50 chains leave swamp. Set corner post with bearing trees: Hemlock 16" N58W 48 links
 White Pine 22" S37W 35 links
 Tamarack 12" S56E 39 links
 Tamarack 11" N65E 40 links
 Corner position fell in Beaver flowage and dam had to be dynamited.
 Found White Pine stump S37W, 23.10'; Hemlock stump hole N58W, 31.68'; and Tamarack stump N65E, 32.34'. Swamp calls to the east also fit record.

- (c) In the plan view drawing below, provide reference ties to at least 4 witness monuments, or, if the location is within a municipality, to at least 2 witness monuments. (Witness monuments shall be made of concrete, natural stone, iron or other equally durable material.) Describe witness monuments.

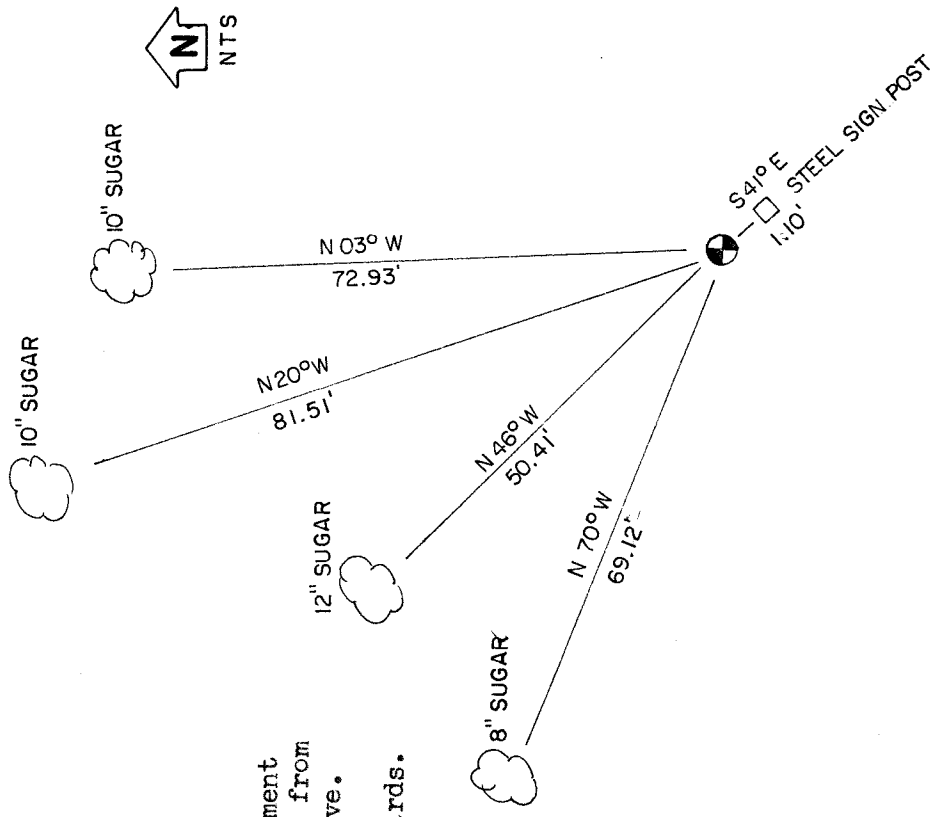

- (d) Show a plan view drawing depicting the relevant monuments and reference ties which is sufficient in detail to enable accurate relocation of the corner monument if the corner monument is disturbed. Indicate north.

Set a 2"x 60" aluminum monument with cap stamped for corner from the bearing trees found above.

Corner marked to USFS standards.

(e) Describe any material discrepancy between the location of the corner as restored or reestablished and the location of that corner as previously restored or reestablished by distance and direction. Show the discrepancy on the plan view drawing under (d), above. Show the distances between the corner as previously restored or reestablished and (1) the corner as restored or reestablished, and (2) to at least 2 of the witness monuments shown on the drawing in (d), above.

No discrepancies.

(f) Was the corner restored through acceptance of (1) an obliterated evidence location, or, (2) a found perpetuated location?

Found perpetuated location.

(g&h) Was the corner reestablished through lost corner proportionate methods? If so, show the method, including the directions and distances to other public land survey corners used as evidence or used for proportioning in determining the corner location?

No.

(i) I, Kim H Pritzlaff certify that the corner location shown (type or print name) on this record was determined by me or under my direction and control and that this U.S. Public Land Survey Monument Record is correct and complete to the best of my knowledge and belief.

Kim H Pritzlaff
Signature

7/21/86
Date

William J. Kelly Co. Surveyor Verified Corner 6-25-86

